

STATISTICS

ACRES: 2.5
 PARKING SPACES: ON STREET
 FACILITIES:
 * METAL PLAYGROUND EQUIPMENT

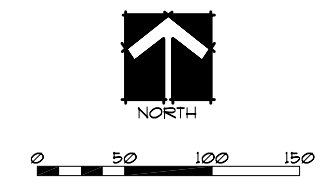
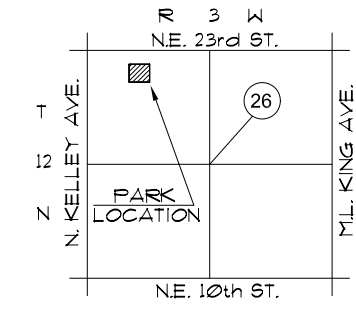

- NOTES:
1. PARK BOUNDARY IS APPROXIMATE LOCATION ONLY.
 2. LOCATION OF IMPROVEMENTS IS CONCEPTUAL. VERIFY LOCATION IN FIELD.

GLEN ELLYN PARK

NE 22nd & GLEN ELLYN - WARD 7

City of Oklahoma City
 Parks and Recreation Department
 JUNE 1998 / APRIL 1999