

**STATISTICS**

- ACRES: 18
- PARKING SPACES: 31 SPACES - ASPHALT
- FACILITIES:
- \* (4) YOUTH BASEBALL FIELD - NO LIGHTS
- \* (2) YOUTH SOCCER - NO LIGHTS
- \* (2) PICNIC AREAS
- \* PORTABLE RESTROOM
- \* JOGGING TRAIL - 0.8 OF A MILE - PEA GRAVEL

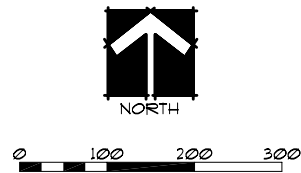
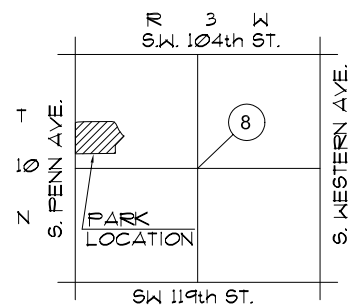

- NOTES:
1. PARK BOUNDARY IS APPROXIMATE LOCATION ONLY.
  2. LOCATION OF IMPROVEMENTS IS CONCEPTUAL. VERIFY LOCATION IN FIELD.

**MERREL MEDLEY PARK**

KINGSRIDGE & PENNSYLVANIA AVE. - WARD 5 - DEED RESTRICTION

City of Oklahoma City  
Parks and Recreation Department  
JUNE 1998 / OCT 2000