

STATISTICS

ACRES: 2.6

PARKING SPACES: ON STREET

- FACILITIES:
- * PLAYGROUND EQUIPMENT - 1991
 - * (2) SAND VOLLEYBALL COURTS
 - * (1) GAZEBO - 2002

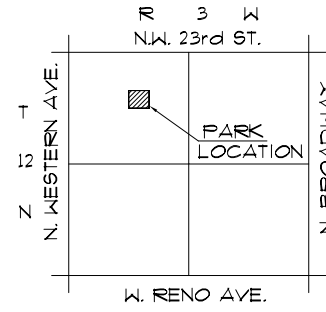

NOTES:

1. PARK BOUNDARY IS APPROXIMATE LOCATION ONLY.
2. LOCATION OF IMPROVEMENTS IS CONCEPTUAL. VERIFY LOCATION IN FIELD.



PERLE MESTA PARK

NW 18th & LEE - WARD 2

City of Oklahoma City
Parks and Recreation Department
APRIL 1998 / MAY 2002