

STATISTICS

ACRES: 2.5
 PARKING SPACES: ON STREET
 FACILITIES:
 * METAL PLAYGROUND EQUIPMENT
 * JUNIOR POOL

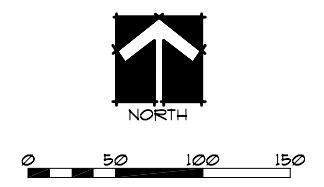
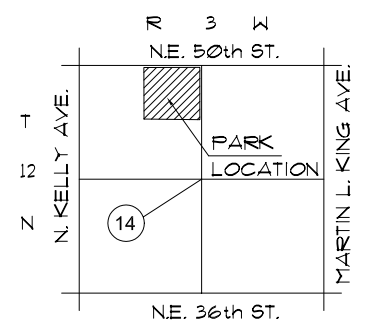

- NOTES:
1. PARK BOUNDARY IS APPROXIMATE LOCATION ONLY.
 2. LOCATION OF IMPROVEMENTS IS CONCEPTUAL. VERIFY LOCATION IN FIELD.

E.W.PERRY PARK

NE 48th & LOTTIE - WARD 7

City of Oklahoma City
 Parks and Recreation Department
 APRIL 1998 / OCT 1999