

STATISTICS

ACRES: 22.4
 PARKING SPACES: 60 REG SPACES - ASPHALT
 3 HC SPACES

- FACILITIES:
- * PLAYGROUND EQUIPMENT (1996)
 - * (5) ADULT SOFTBALL FIELDS - NO LIGHTS
 - * (1) ADULT & YOUTH SOCCER - NO LIGHTS
 - * (1) VOLLEYBALL COURT
 - * (4) PICNIC AREAS
 - * (1) BASKETBALL COURT
 - * SENIOR POOL & KIDDY POOL
 - * WALKING TRAIL - 0.4 MI
 - * HANDICAP PARKING AT PLAYGROUND

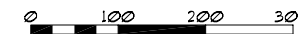
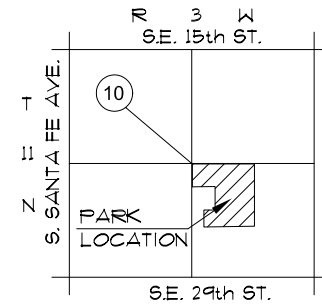

- NOTES:
1. PARK BOUNDARY IS APPROXIMATE LOCATION ONLY.
 2. LOCATION OF IMPROVEMENTS IS CONCEPTUAL. VERIFY LOCATION IN FIELD.