

STATISTICS

ACRES: 30.9
 PARKING SPACES: 90 SPACES - ASPHALT
 FACILITIES:
 * METAL PLAYGROUND EQUIPMENT
 * (1) ADULT BASEBALL FIELD - NO LIGHTS
 * (1) SENIOR POOL - SUMMER CAMP
 * COMMUNITY CENTER - SUMMER ONLY
 * (1) PICNIC AREA

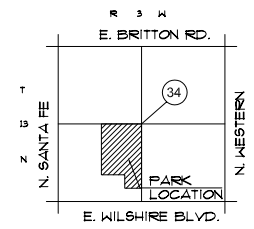

- NOTES:
 1. PARK BOUNDARY IS APPROXIMATE LOCATION ONLY.
 2. LOCATION OF IMPROVEMENTS IS CONCEPTUAL. VERIFY LOCATION IN FIELD.

HARRISON PARK

NE 82nd & WALNUT - WARD 7 - DEED RESTRICTION

City of Oklahoma City
 Parks and Recreation Department
 APRIL 1998 / MAY 2003