

**STATISTICS**

ACRES: 11  
 PARKING SPACES: 36 SPACES - ASPHALT  
 2 HC SPACES

FACILITIES:  
 \* COMMUNITY CENTER/ GYM  
 \* PLAYGROUND EQUIPMENT - 1997  
 \* JUNIOR POOL

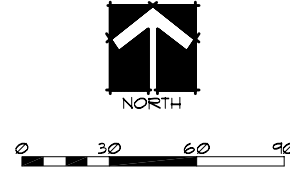
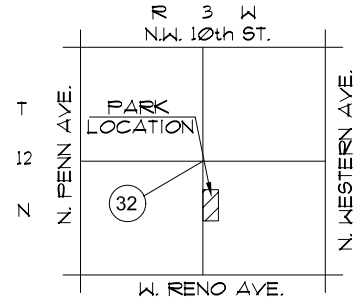

**NOTES:**

1. PARK BOUNDARY IS APPROXIMATE LOCATION ONLY.
2. LOCATION OF IMPROVEMENTS IS CONCEPTUAL. VERIFY LOCATION IN FIELD.

PARKING

