

STATISTICS

- ACRES: 2.3
 PARKING SPACES: 12 - ASPHALT
 3 HANDICAP SPACES
- FACILITIES:
 * MUNICIPAL GYM
 * METAL PLAYGROUND EQUIPMENT
 * (1) PICNIC AREA

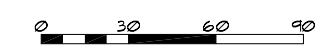
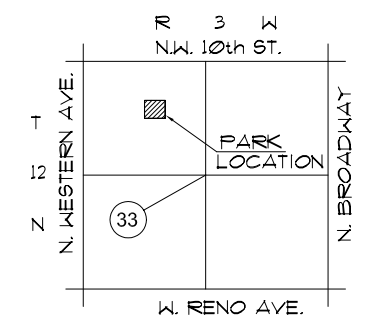

- NOTES:
 1. PARK BOUNDARY IS APPROXIMATE LOCATION ONLY.
 2. LOCATION OF IMPROVEMENTS IS CONCEPTUAL.
 VERIFY LOCATION IN FIELD.

RED ANDREWS PARK

NW 7th & SHARTEL - WARD 6 - DEED RESTRICTION

City of Oklahoma City
 Parks and Recreation Department
 APRIL 1998 / OCT 1999