

STATISTICS

- ACRES: 11
- PARKING SPACES: GRAVEL AREA
- FACILITIES:
 - * (1) BASEBALL FIELD - LIGHTED (1999)
 - * CONCESSION BLDG.
 - * RESTROOMS
 - * BLEACHERS

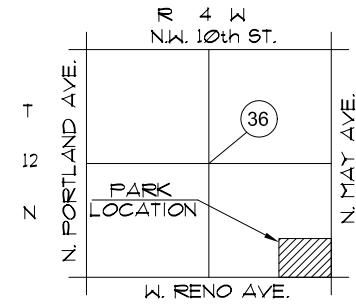

NOTES:

1. PARK BOUNDARY IS APPROXIMATE LOCATION ONLY.
2. LOCATION OF IMPROVEMENTS IS CONCEPTUAL. VERIFY LOCATION IN FIELD.

TED REYNOLDS PARK

RENO & MAY - WARD 6

City of Oklahoma City
Parks and Recreation Department
JUNE 1998 / OCT 2000