

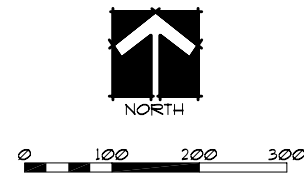

STATISTICS

- ACRES: 17
- PARKING SPACES: BROKEN ASPHALT / ROCKY AREA
- FACILITIES:
- * GREEN SPACE
- * LINE CONTROLLED FLYING CIRCLES

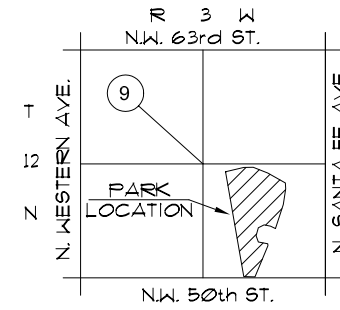

NOTES:

1. PARK BOUNDARY IS APPROXIMATE LOCATION ONLY.
2. LOCATION OF IMPROVEMENTS IS CONCEPTUAL. VERIFY LOCATION IN FIELD.

TOPPING PARK

NW 50th & SANTA FE - WARD 2

City of Oklahoma City
Parks and Recreation Department
JUNE 1998 / OCT 1999