

STATISTICS

- ACRES: 4.2
- PARKING SPACES: ADJACENT TO SCHOOL
- FACILITIES:
 - * METAL PLAYGROUND EQUIPMENT
 - * (1) YOUTH BASEBALL FIELD - NO LIGHTS
 - * (2) BASKETBALL COURTS
 - * JOGGING/WALKING ASPHALT TRAIL - 0.3 M
 - * (2) PICNIC AREAS

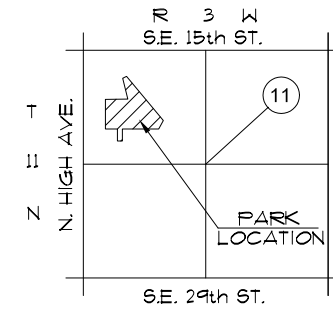

- NOTES:
1. PARK BOUNDARY IS APPROXIMATE LOCATION ONLY.
 2. LOCATION OF IMPROVEMENTS IS CONCEPTUAL. VERIFY LOCATION IN FIELD.

TOP 'O' TOWN PARK

SE 18th & STONEWALL - WARD 7

City of Oklahoma City
Parks and Recreation Department
JUNE 1998 / MAY 2002