

STATISTICS

ACRES: 19
 PARKING SPACES: PARK 33 REG SPACES - ASPHALT
 2 HANDICAP SPACES
 STADIUM 124 REG SPACES-ASPHALT
 5 HANDICAP SPACES

- FACILITIES:
- * PLAYGROUND EQUIPMENT - 1998
 - * BASKETBALL COURT - 2 GOALS
 - * (1) PICNIC SHELTER
 - * (3) SOCCER FIELDS - 6 GOALS
 - * (1) FOOTBALL FIELD
 - * (8) PICNIC AREAS
 - * PORTABLE RESTROOM

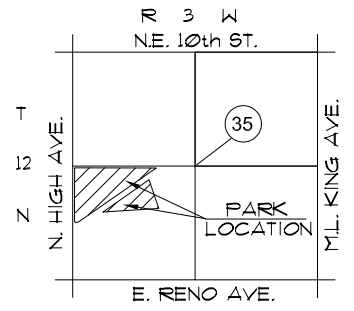

- NOTES:
1. PARK BOUNDARY IS APPROXIMATE LOCATION ONLY.
 2. LOCATION OF IMPROVEMENTS IS CONCEPTUAL. VERIFY LOCATION IN FIELD.

WASHINGTON PARK

NE 4th & HIGH - WARD 7

City of Oklahoma City
 Parks and Recreation Department
 JUNE 1998 / OCT 2001