

# “Exhibits A and C”

## Event Site Map and Public Restroom and Event Solid Waste Management Plan



### Event Site Map Legend



Event Roadway Closure Limits



Event Road Closure Points - Type III Barricades  
(Locations generally as illustrated)



Public Portable Restroom Facilities



Solid waste containers to be placed along SW 25 Street and throughout event area.



Main Stage



# “Exhibit B”-1

## Event Traffic Control Plan

### Event Area

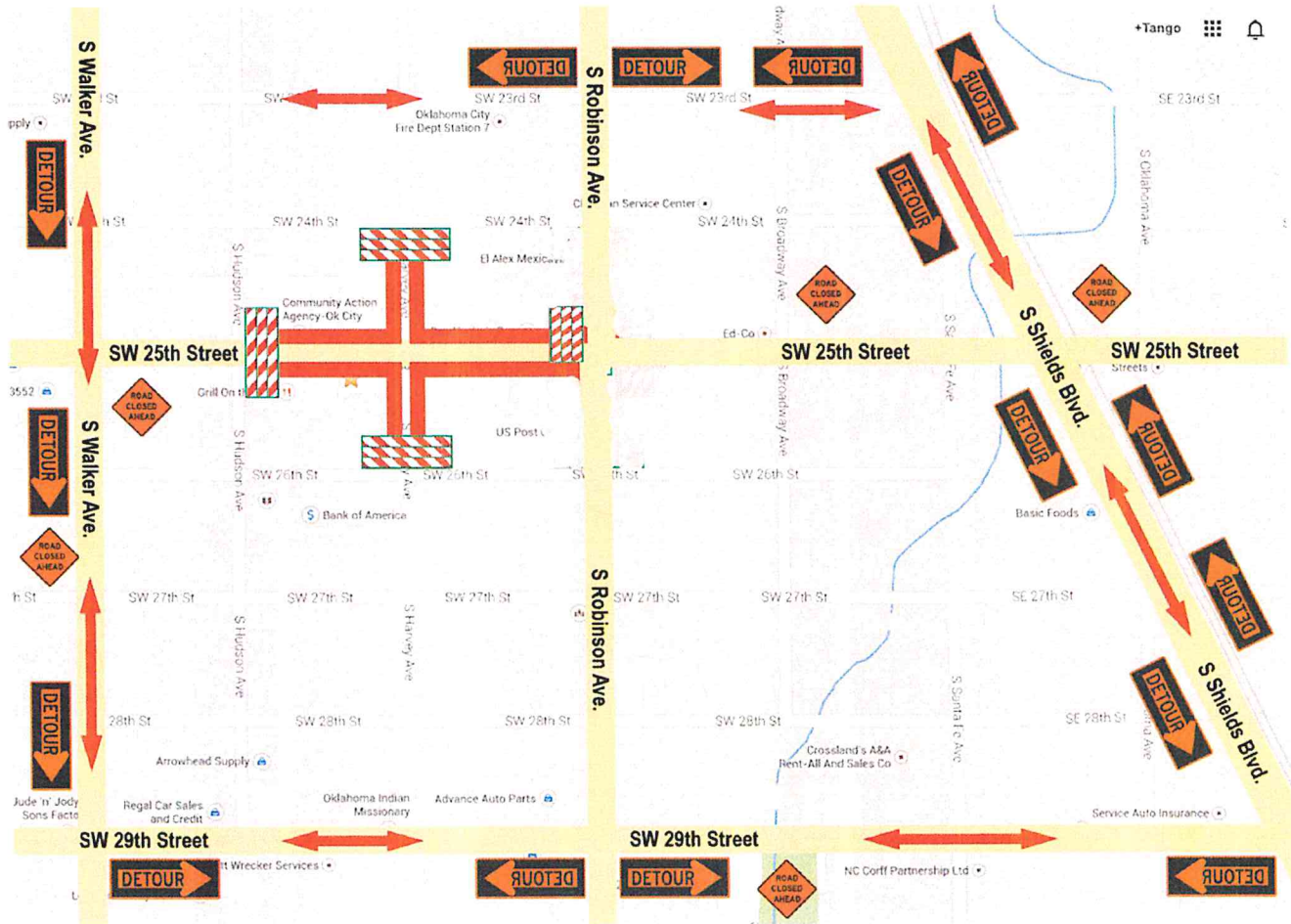

## Event Traffic Flow Map Legend (Roadway closures for the total duration of the event)



Road Closure Point - Type III Barricades  
(Location generally as illustrated)



Advance Road Closure Warning Signs  
(Locations generally as illustrated)



Local Traffic Detour Route (Signed in accordance with the requirements of Section 6C.09 of the Manual on Uniform Traffic Control Devices)

HISTORIC CAPITOL HILL'S

# Fiestas DE LAS AMERICAS

Exhibit B-2

Saturday, September 29th  
Parade of the Americas- 10:00am

