

MB-1194 Intermodal Transportation Hub

Preliminary Report

City Council Update

April 2015



The City of
OKLAHOMA CITY



Outline



The City of
OKLAHOMA CITY

- Background/Status
- Preliminary Design
- Funding/Budget
- Scope
- Schedule

Background



The City of
OKLAHOMA CITY

- **Project**
 - Expansion of Existing Santa Fe Station
 - Historic Rehabilitation
 - Upgrades
 - AMTRAK Office
 - Future Lease Spaces
 - Transit
 - Intermodal (Bus, Taxi, Streetcar, Train)
 - Connectivity
 - Pedestrian
 - Downtown and Bricktown

- **Preliminary Design**
 - Report Completed
 - Final Plans Underway
 - Site Plans, Layouts, Budget and Overall Schedule

**Intermodal
Transportation Hub
Preliminary Report
MB-1194 - Oklahoma City**

March 2015



Site Plan Overall



The City of
OKLAHOMA CITY

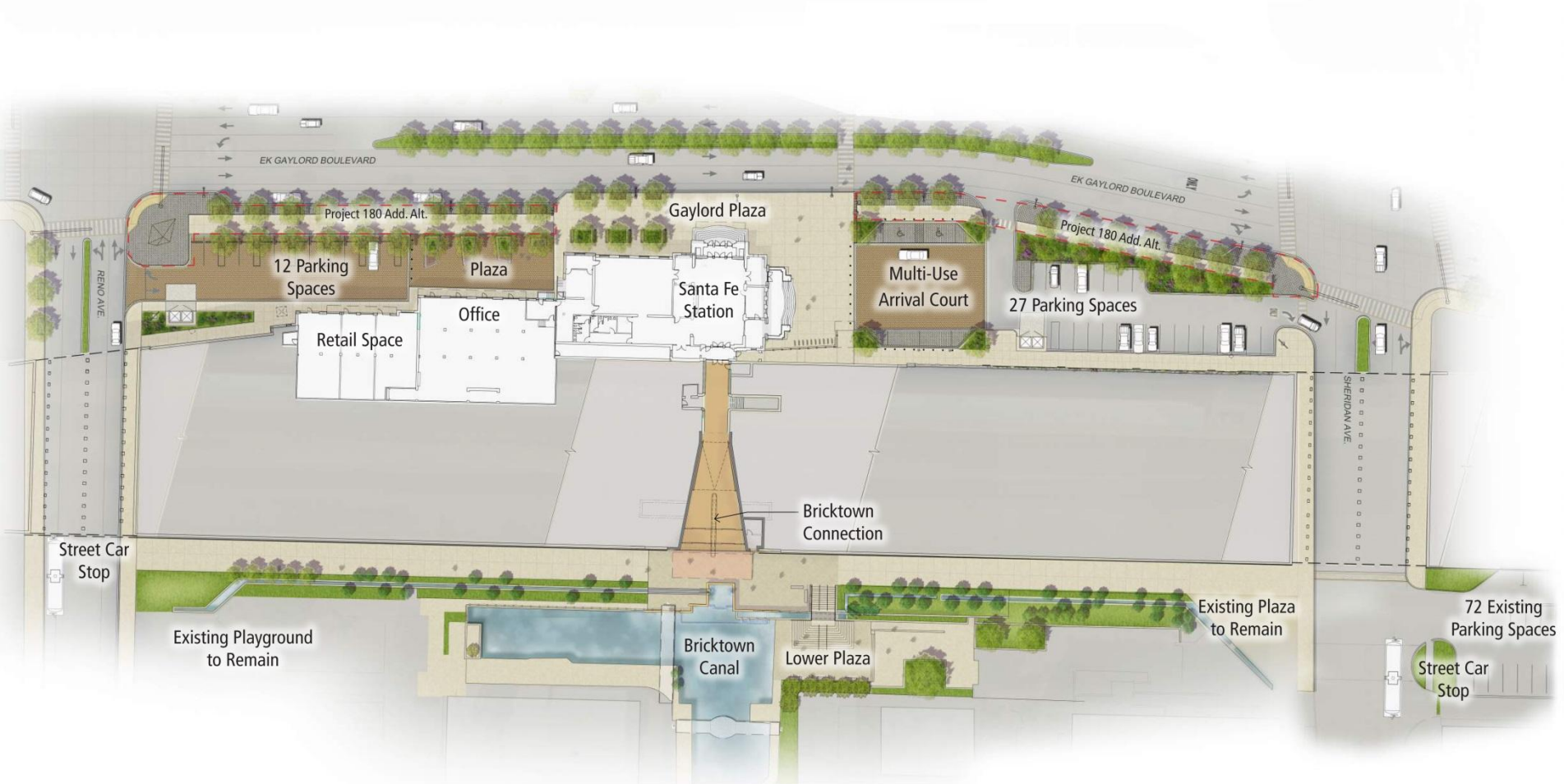

Site Plan

North Gaylord Plaza



The City of
OKLAHOMA CITY

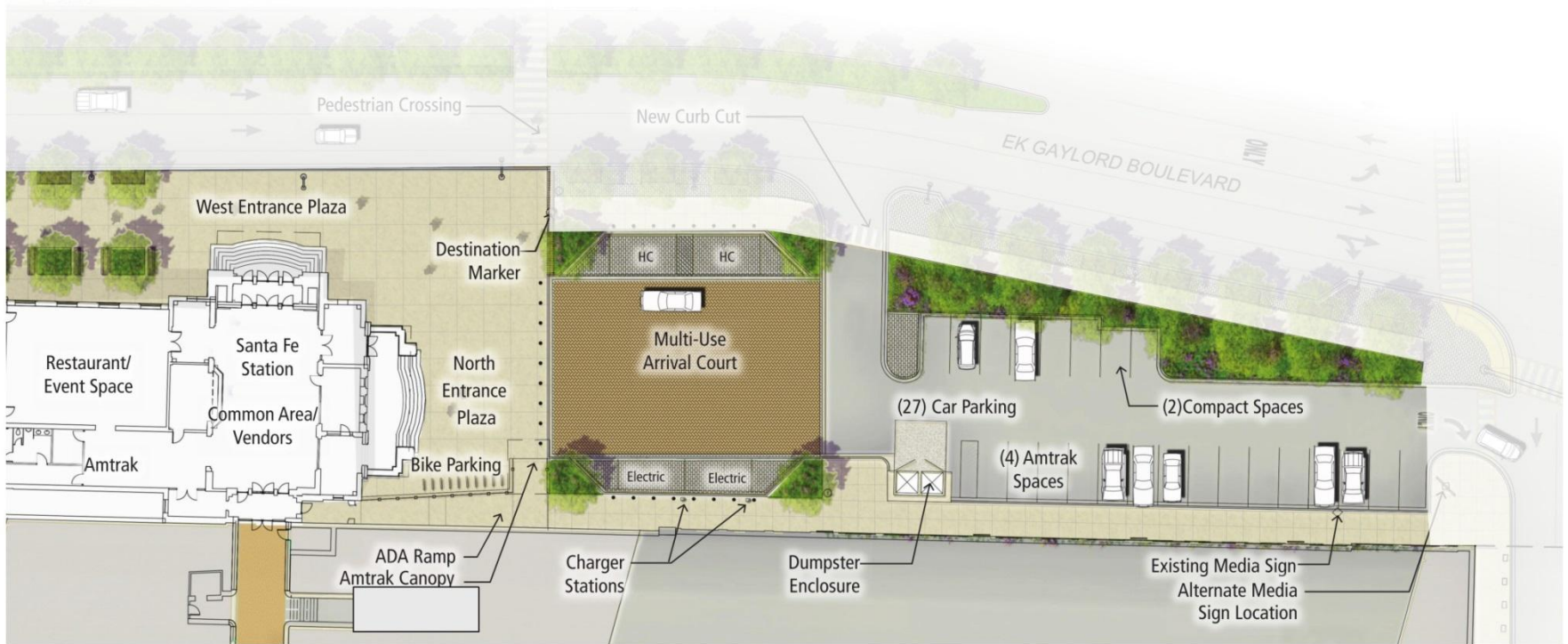

Site Plan

South Gaylord Plaza



The City of
OKLAHOMA CITY



Site Plan

Bricktown Plaza



The City of
OKLAHOMA CITY

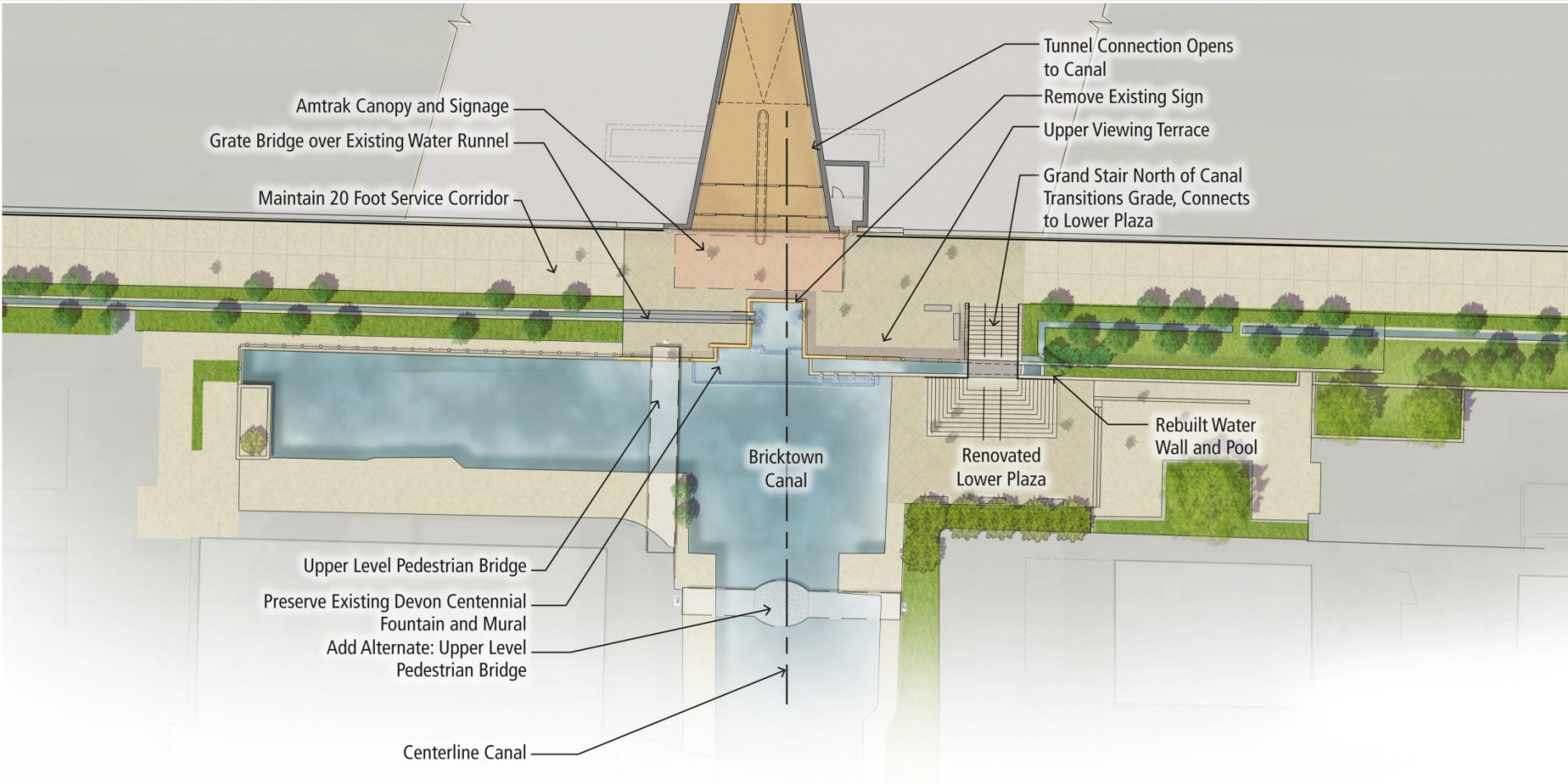

Site Rendering

view from southwest



The City of
OKLAHOMA CITY



Site Rendering

view from northwest



The City of
OKLAHOMA CITY



Site Rendering

view from southeast



The City of
OKLAHOMA CITY



Floor Plan Overall



The City of
OKLAHOMA CITY

Proposed Tenant Spaces

1. Scope includes maintaining and enhancing services for AMTRAK, and revitalizing the Santa Fe Station into a revenue generating space.
2. The following layouts are conceptual and are used only to evaluate feasibility of sizes and relationships.

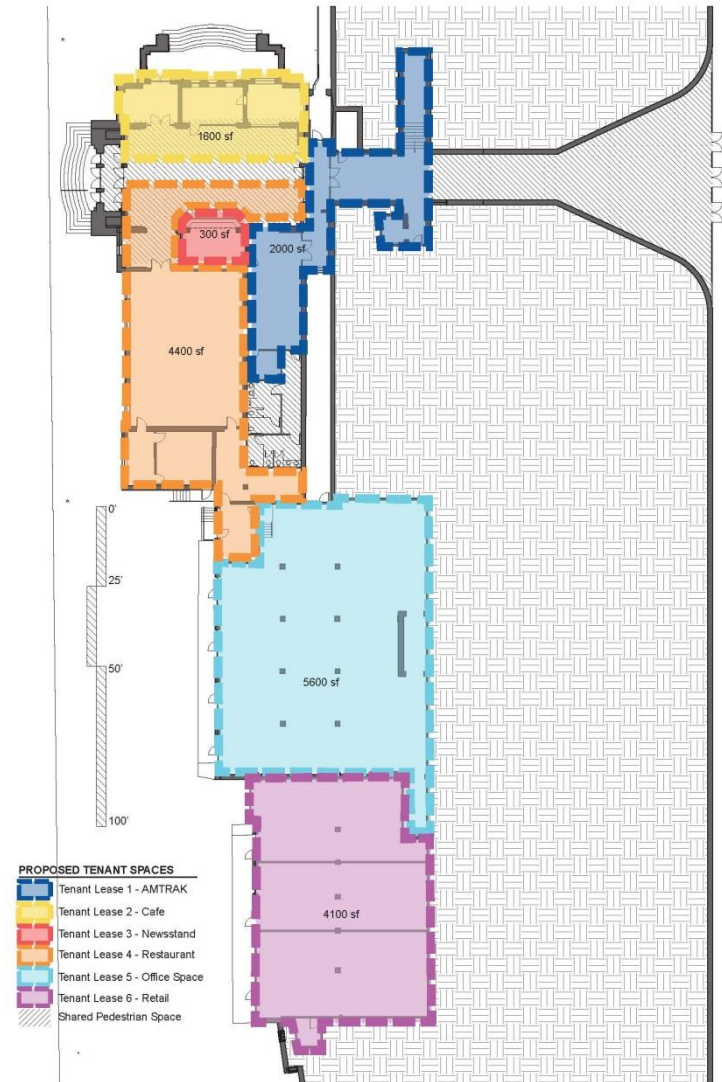

Floor Plan

Detailed



The City of
OKLAHOMA CITY

Proposed North Tenant Plan

-  Tenant Lease 1 - Amtrak
-  Tenant Lease 2 - Café
-  Tenant Lease 3 - Newsstand
-  Tenant Lease 4 – Restaurant
-  Shared Public Space

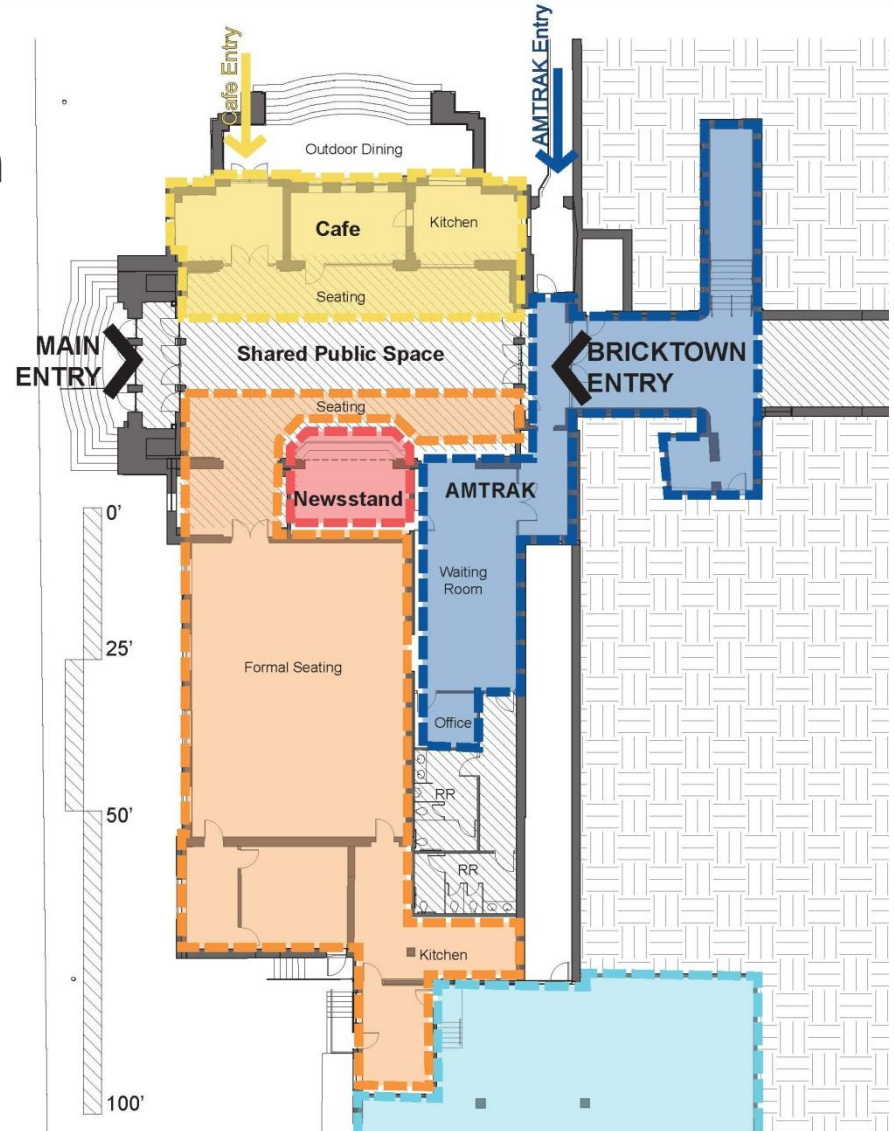

Floor Plan Detailed



The City of
OKLAHOMA CITY

Proposed South Tenant Plan



Tenant Lease 5 – Office Space



Tenant Lease 6 - Retail

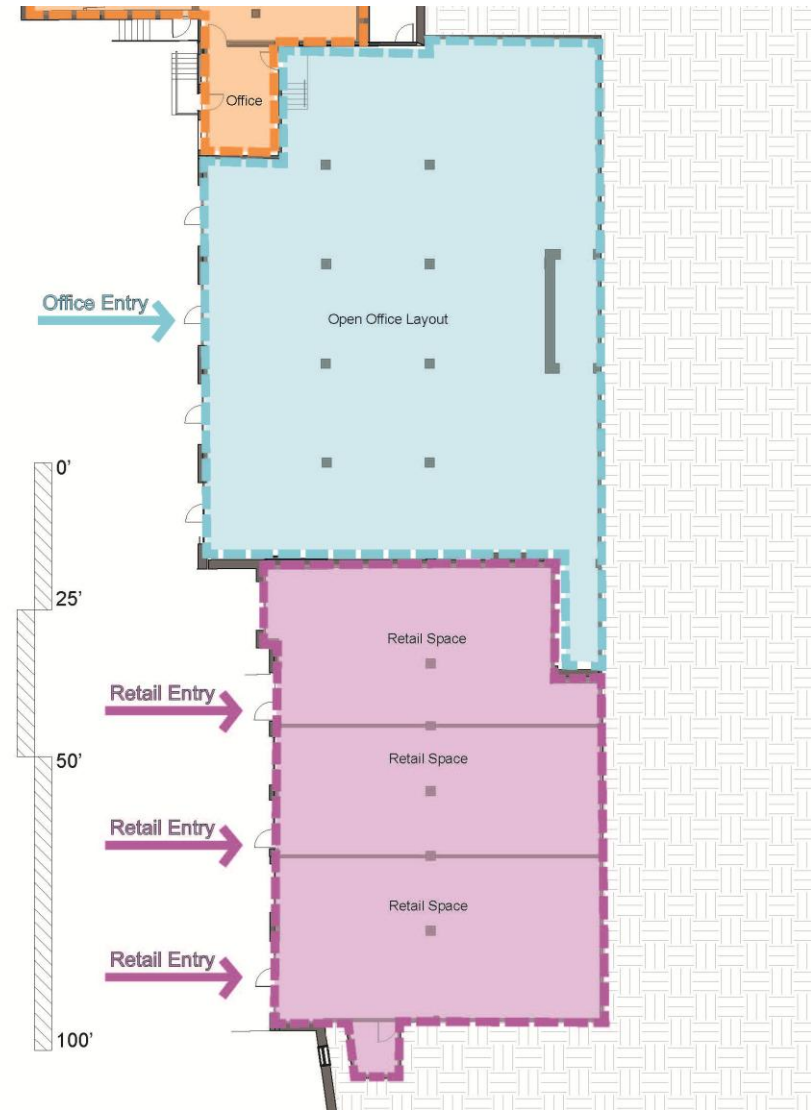

Interior Rendering



The City of
OKLAHOMA CITY



proposed interior elevation

Funding



The City of
OKLAHOMA CITY

Organization Name	Role/Involvement	
Federal Contribution	\$13,591,178	TIGER 2013 funding
City of Oklahoma City	\$11,338,694	Non-federal funding
Oklahoma Department of Transportation	\$ 1,500,000	Non-federal funding
Association of Central Oklahoma Governments	\$ 2,000,000	Federal funding
Total	\$28,429,872	

Funding



The City of
OKLAHOMA CITY

• Amtrak Space Needs Assessment	\$ 1,714,337
• Future Elevated Rail Transit Operations	
• Freight Operations and Tunnel Coordination	\$ 3,810,205
• Gaylord Streetcar Operations	\$ 1,069,100
• Project 180 Coordination	\$ 255,118
• Gaylord Plaza	\$ 1,486,202
• Bricktown Connection and Tunnel Interface	\$ 1,747,881
• Santa Fe Terminal - Condition and HP Assessment	\$ 5,911,784
• Property Acquisition, Streetscape Construction, Engineering, Administration, Contingency	\$12,435,245
	<hr/>
Total	\$28,429,872

Project Schedule



The City of
OKLAHOMA CITY

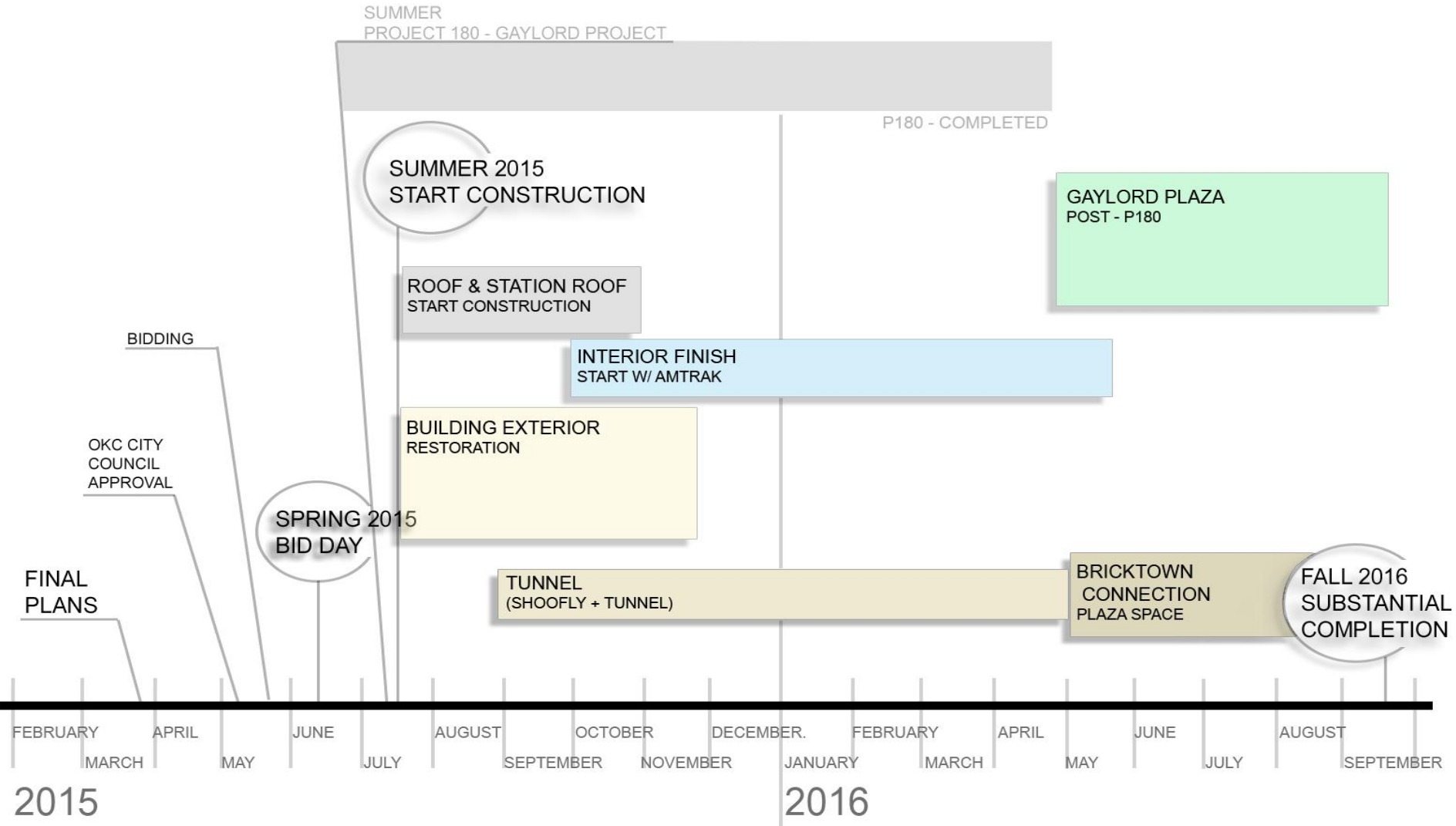

MB-1194 Intermodal Transportation Hub

Preliminary Report

City Council Update

April 2015



The City of
OKLAHOMA CITY

