

An aerial photograph of downtown Denver, Colorado, showing a dense urban landscape with various skyscrapers and buildings. A semi-transparent blue rectangular box is overlaid on the center of the image, containing the main text. The text is in a large, black, sans-serif font. The background shows the city's skyline, including the prominent blue glass skyscraper in the foreground and the Colorado State Capitol building in the distance.

MAPS 3 Downtown Park (upper) City Council Update 12/16/2014

Hargreaves Associates

Butzer Gardener Architects . Johnson & Associates . CEC . Sherwood

AGENDA

PROJECT STATUS
SUMMARY OF IMPROVEMENTS
DESIGN STUDIES
NEXT STEPS

Project Status

SCHEDULE & OUTREACH

SCHEDULE

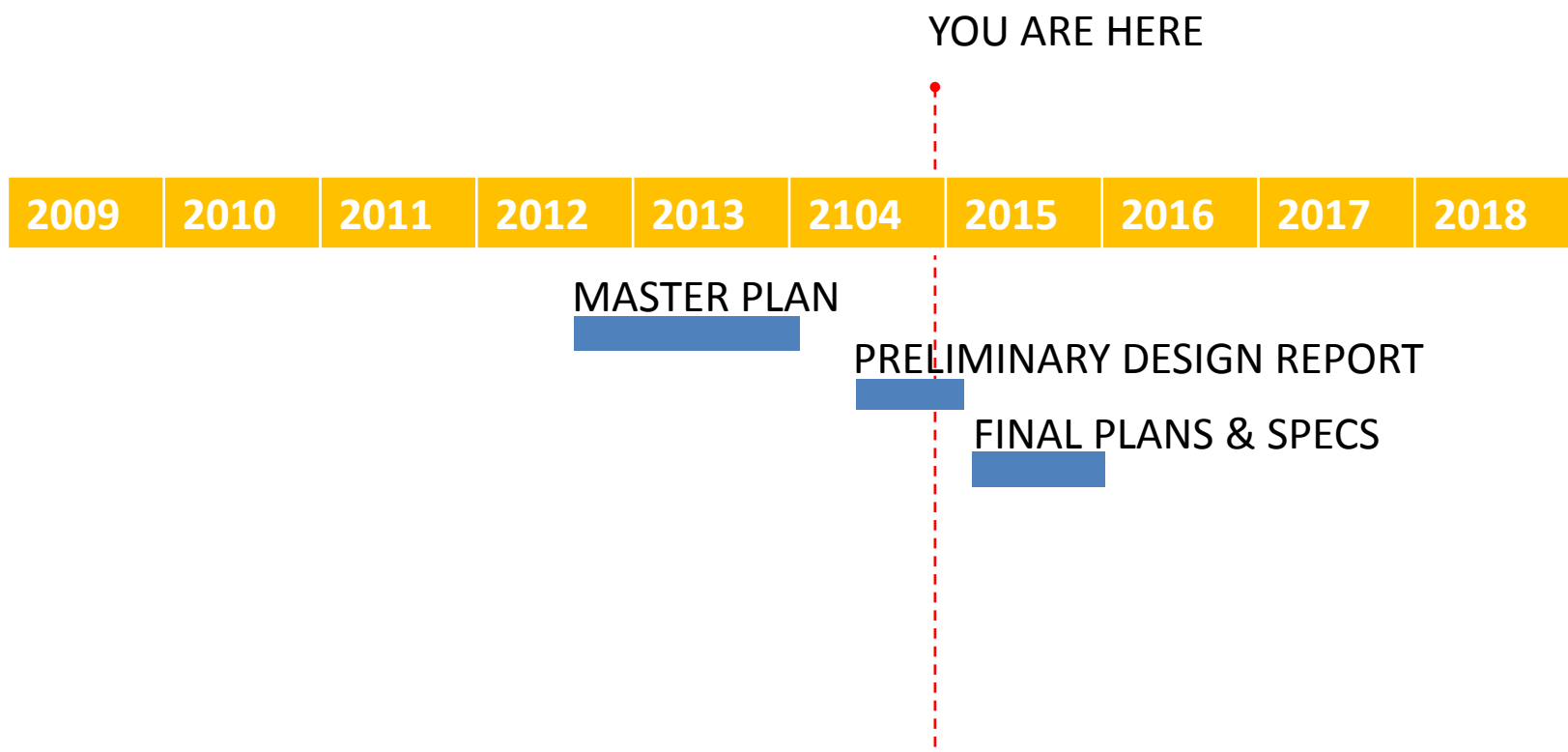

MAPS3 Downtown Park Activities and Amenities Survey

Let us know which **activities and amenities** you would like the park to include by checking the circles next to your **5 highest priorities** within each category. The park cannot include everything on the list but survey responses will help identify broad community preferences. Fill in the blank spaces at the bottom if we forgot something.

- 
- RECREATION**
- Multi-use fields (Soccer, football, softball)
 - Pickup sports
 - Basketball
 - Volleyball
 - Bocce, horseshoes
 - Playground (ages 2-5)
 - Explorational play (ages 6-12)
 - Sprayground
 - Picnic / bbq
 - Indoor recreation center
 - Tai chi, zumba, aerobics, yoga
 - Kayaking
 - Paddleboats, rowboats (in lake)
 - Swimming
 - Off-leash dog area
 - Equestrian facilities/trails
 - Bike paths
 - Bike/equipment rentals
 - _____
 - _____
 - _____
 - _____
 - _____

- 
- PERFORMANCES/ EVENTS**
- Convention center and arena-related events
 - Civic gathering
 - Festivals (Festival of the Arts)
 - Performances
 - Concerts, symphony
 - Runs
 - Rallies
 - Farmers/flower markets
 - Exercise classes, dancing
 - Outdoor movies
 - Digital screen
 - Weddings
 - Private events
 - Corporate events
 - Fireworks
 - Event lighting
 - Stage / bandshell
 - Seasonal events (Christmas, Thanksgiving)
 - _____
 - _____
 - _____
 - _____
 - _____

- 
- EDUCATION/ INTERPRETATION**
- Oklahoma historic interpretation
 - School field trips
 - Guided tours
 - Nature walks
 - Educational events
 - Environmental education
 - Native plants education
 - Community gardens
 - Bird watching / tours
 - Recycling
 - Landscape sustainability
 - Energy sustainability
 - Art classes
 - Outdoor classrooms
 - Information kiosks
 - Temporary art exhibition
 - _____
 - _____
 - _____
 - _____
 - _____

- 
- SPECIAL FEATURES/ DESTINATION ATTRACTIONS**
- River-edge boardwalk/ pier / cafe
 - Civic scale water display
 - Interactive fountains
 - Public art/ downtown monument
 - Iconic lighting
 - Iconic landscape feature
 - Historic Union Station reuse
 - Downtown-river promenade
 - Restaurant
 - Cafe
 - Beer garden
 - Food truck amature
 - Community/ event center
 - Senior center
 - Cultural facility / museum
 - Shade structures
 - _____
 - _____
 - _____
 - _____
 - _____

What is your favorite Oklahoma Park, Outdoor Space, or Natural Landscape? _____

What is the outdoor activity that best represents the essence of Oklahoma City? _____

Your zipcode: _____

Thank you for your input!

Mail Completed forms to:

OUTREACH: user preferences

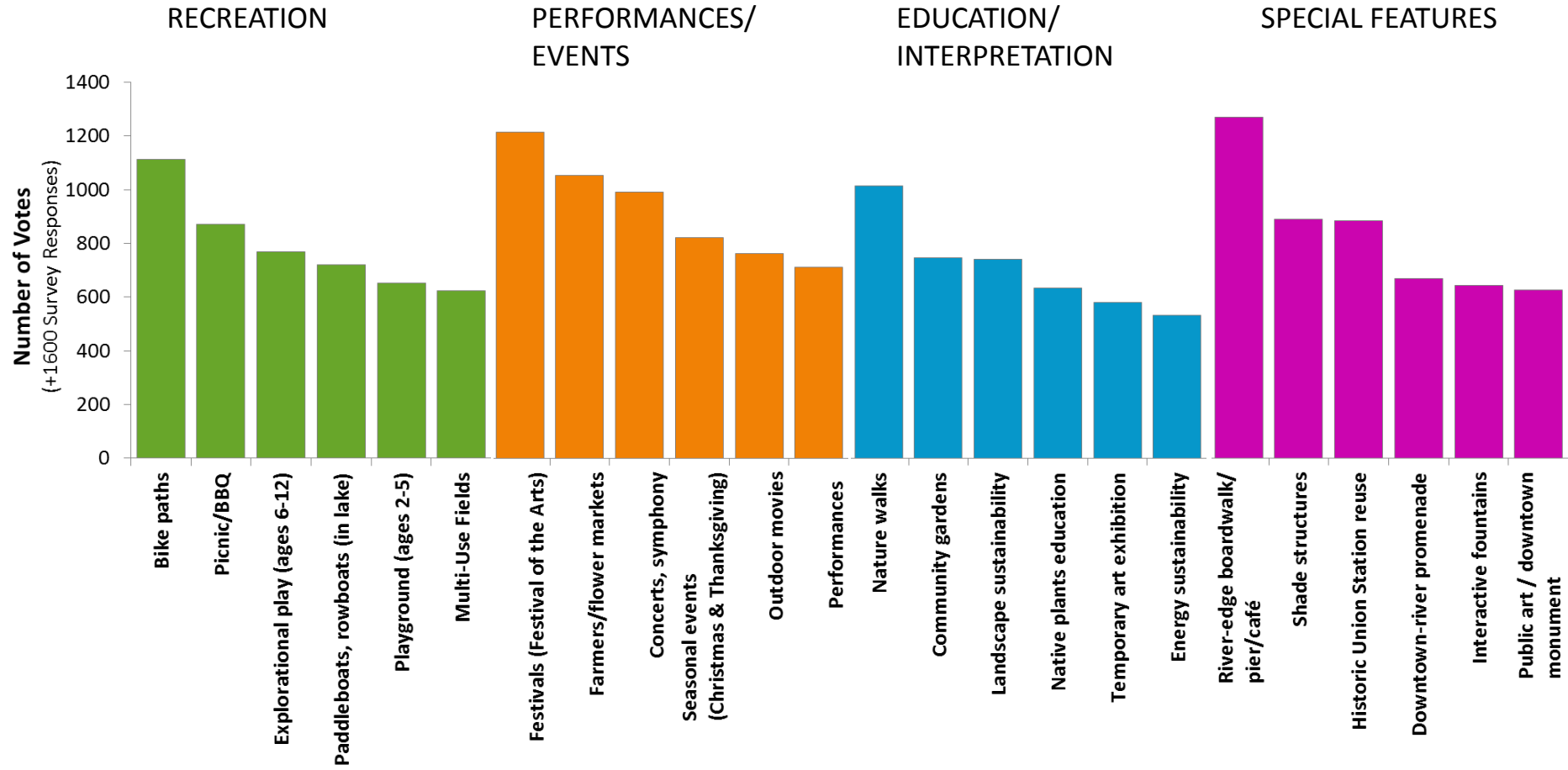

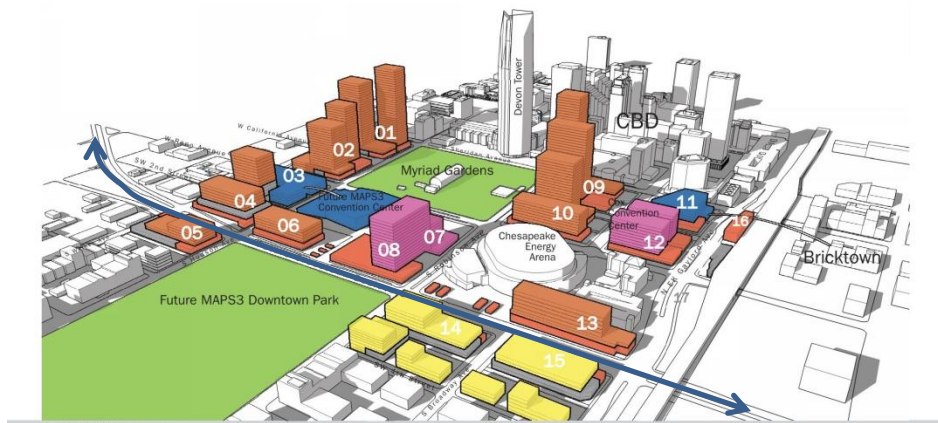

MYRIAD GARDENS FOUNDATION
ENTERTAINMENT PROMOTERS
LOCAL PANEL OF PLANT EXPERTS
CONVENTION CENTER TEAM
MODERN TRANSIT TEAM
CITY PARKS & RECREATION
CITY PLANNING
CITY PUBLIC WORKS
CROSS TOWN BOULEVARD TEAM
10 SPECIALIST SUBCONSULTANTS

Summary of Improvements

IMPROVEMENTS FROM MASTERPLAN

Master Plan 2013

Schematic Design 2014

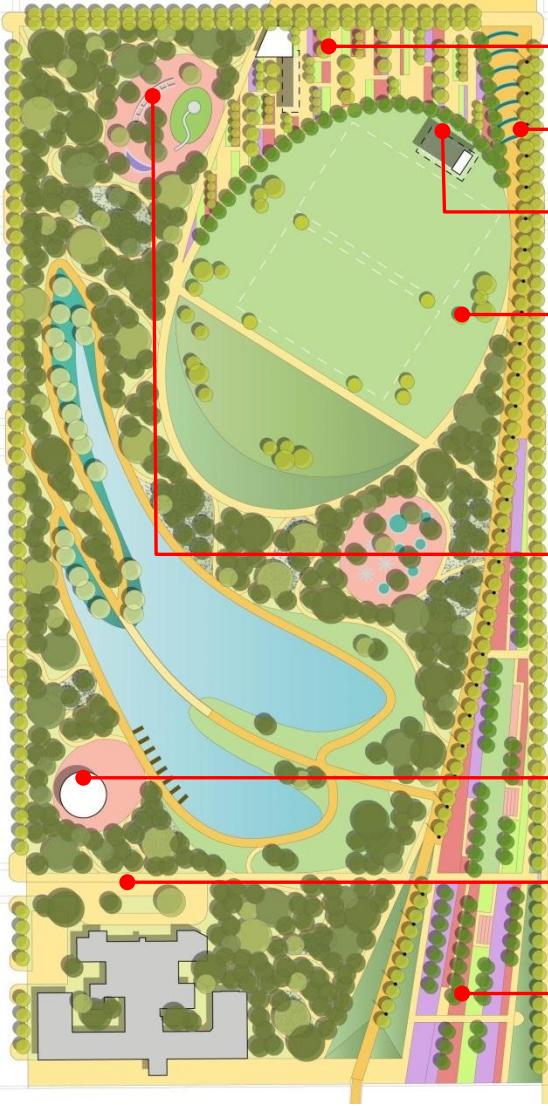

- Café & Gardens address Boulevard
- Fountain moved, Sculptural benches added
- Additional restrooms, Paving for event set up
- Additional shade trees
- Adult Play moved, Function area added
- Boathouse moved, Dog run added
- Drop off moved, Additional lawns
- Robinson Gardens elevated Function area added

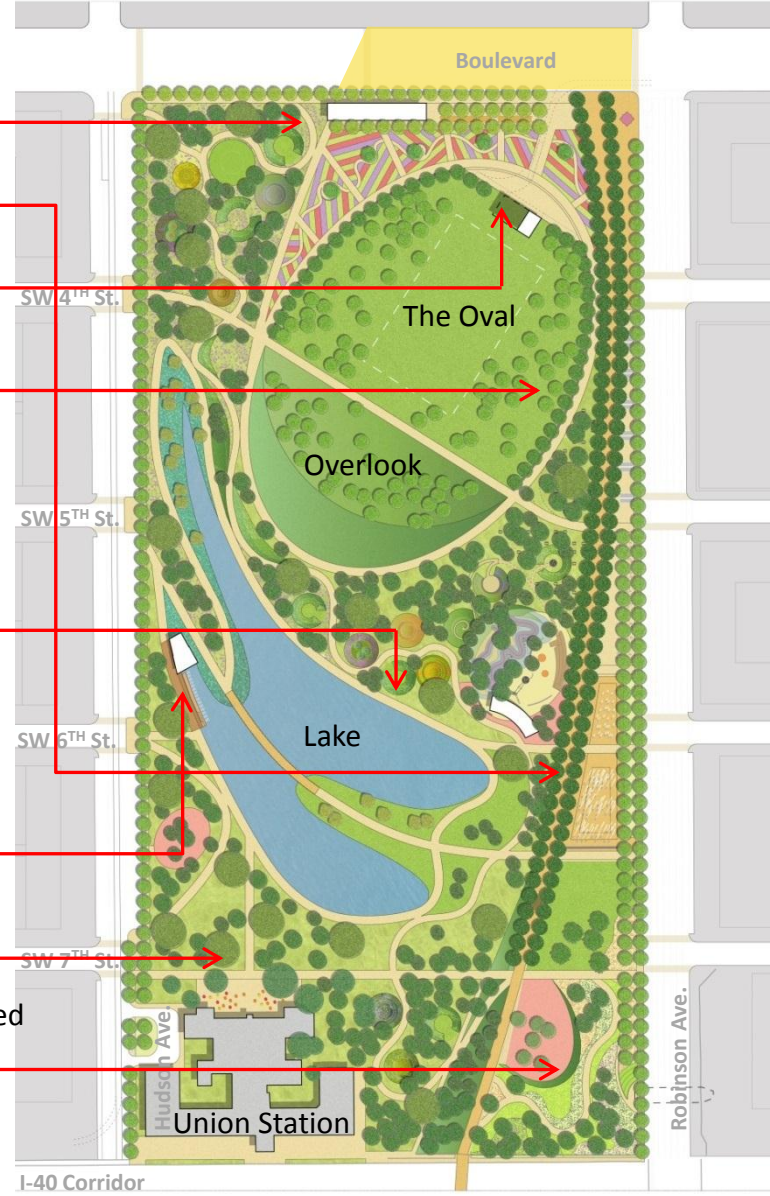

DESIGN IMPROVEMENTS

Master Plan 2013



Schematic Design 2014





37 acres
15 unique areas
560,000+ visits
\$55.6M to build

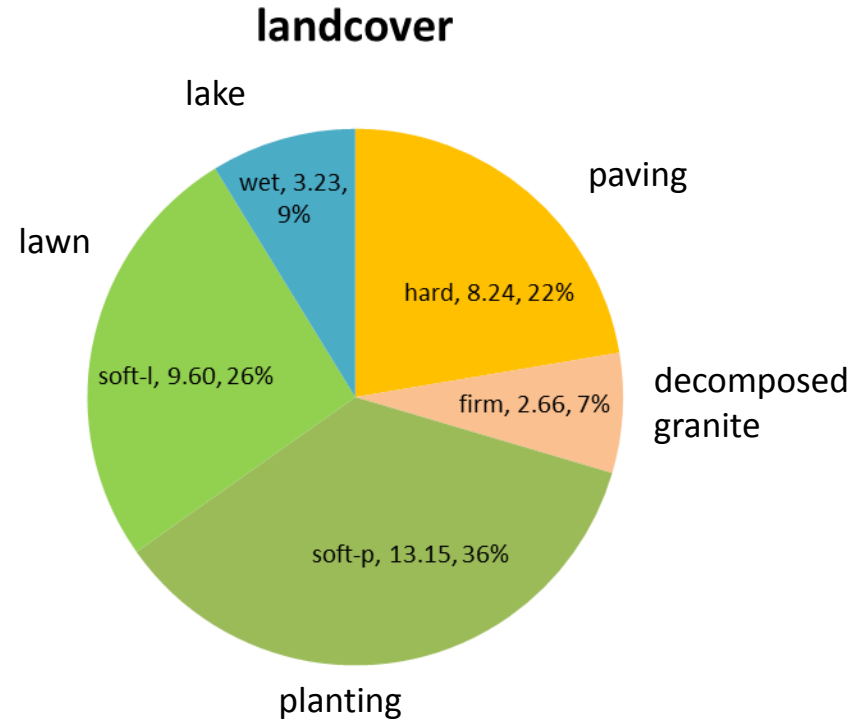

CAFÉ & BOULEVARD GARDENS – View from Garden – Schematic Design Progress



CAFÉ & BOULEVARD GARDENS – Schematic Design Progress



CAFÉ & BOULEVARD GARDENS – Night View from Boulevard – Schematic Design Progress



THE OVAL – View from Promontory of Great Lawn & Skyline – Schematic Design Progress



FOUNTAIN – Schematic Design Progress



FOUNTAIN & ROBINSON GARDENS – View on Promenade – Schematic Design Progress



FOUNTAIN, VIEWING LAWN & ROBINSON GARDENS – Aerial View – Schematic Design Progress



FOUNTAIN, VIEWING LAWN & ROBINSON GARDENS – Schematic Design Progress



WOODLAND GARDENS – Schematic Design Progress



WOODLAND GARDENS – View toward Lake and Union Station – Schematic Design Progress



BOAT HOUSE– Schematic Design Progress



BOAT HOUSE – View from Terrace – Schematic Design Progress





New Studies

VISITOR SERVICES

VISITOR SERVICES – Regular Day Restrooms, Food & Beverage

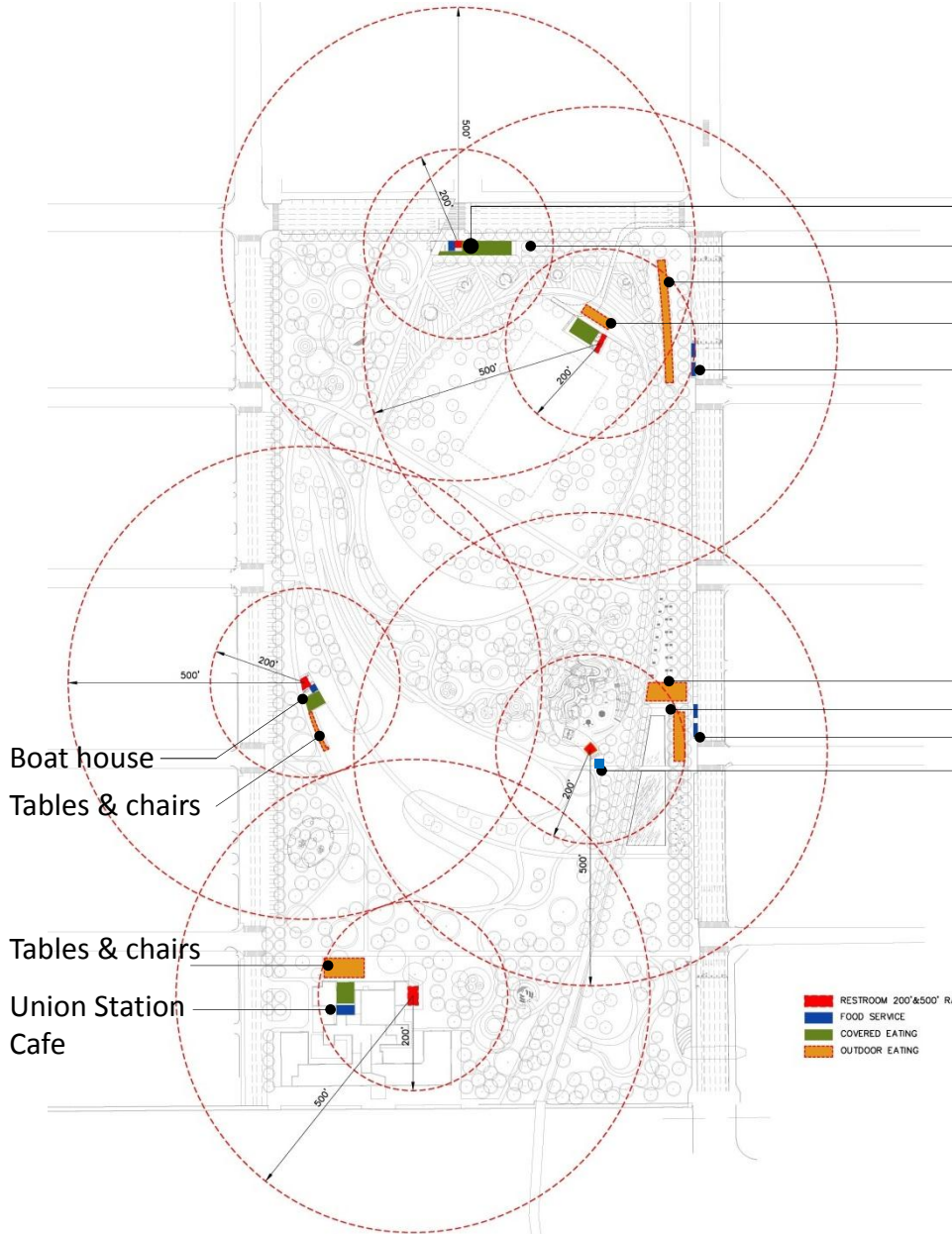

- Cafe
- Tables & chairs
- Sculptural Benches
- Tables & chairs
- Food Trucks



- Picnic Tables
- Tables & chairs
- Food Trucks
- Food Cart



- Boat house
- Tables & chairs
- Tables & chairs
- Union Station
- Cafe



■ RESTROOM 200' & 500' RADI
■ FOOD SERVICE
■ COVERED EATING
■ OUTDOOR EATING

VISITOR SERVICES – Market Day

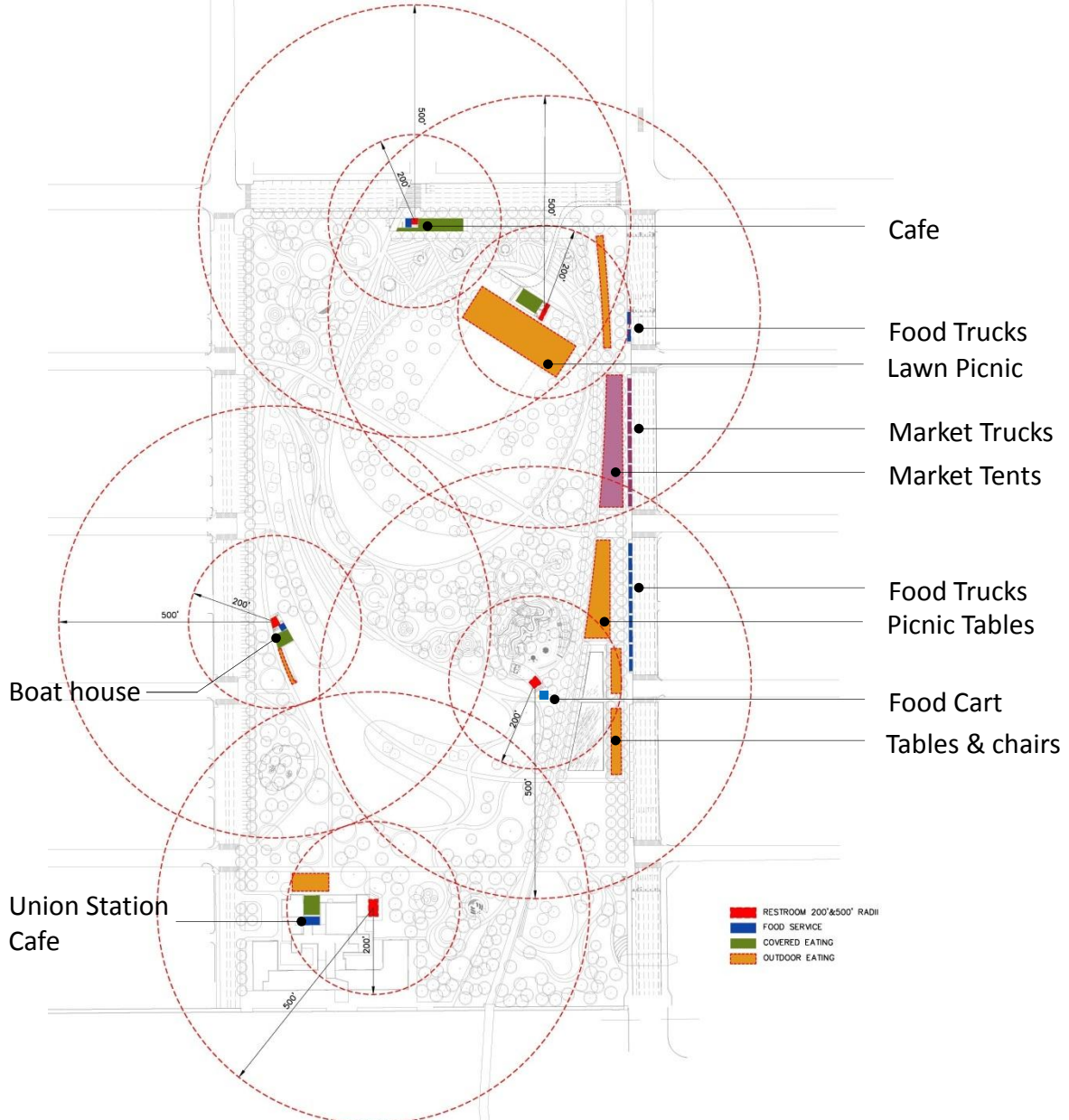

VISITOR SERVICES – Function Days

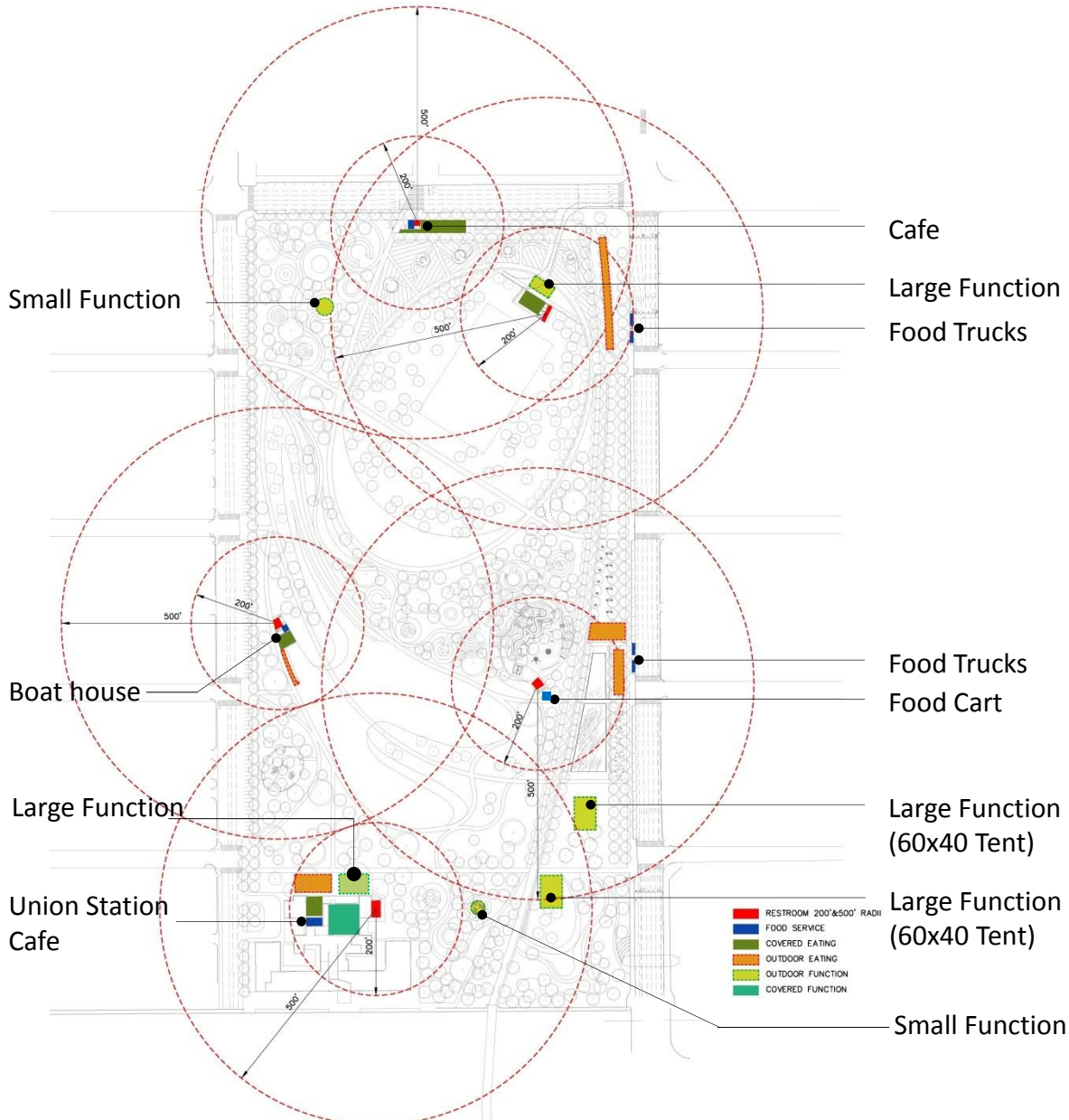

Cafe
Large Function
Food Trucks

Food Trucks
Food Cart

Large Function (60x40 Tent)

Large Function (60x40 Tent)

Small Function



New Studies

FOUNTAIN



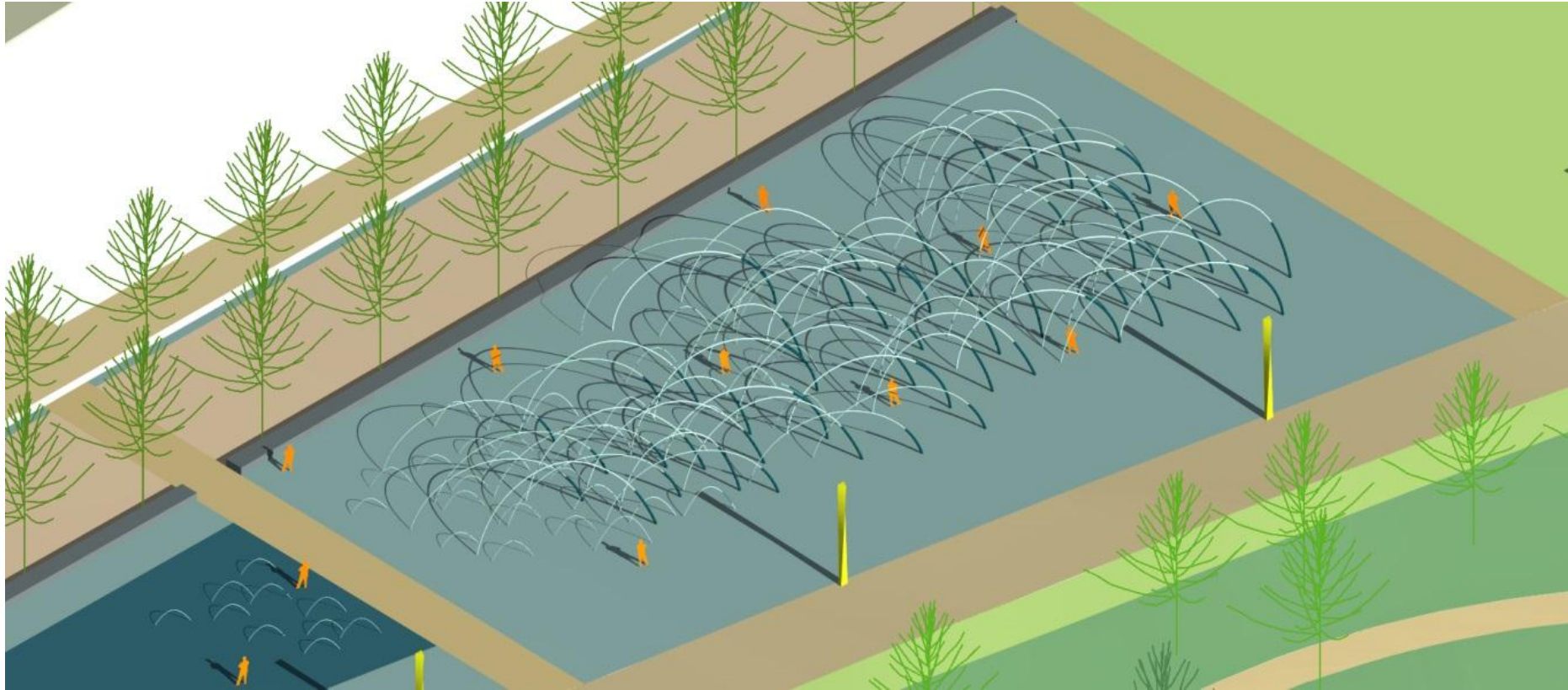

Note : Promenade trees not shown

FOUNTAIN : Wand Variations

OKC : FOUNTAIN STUDIES
WAND JETS : 12 FT - C

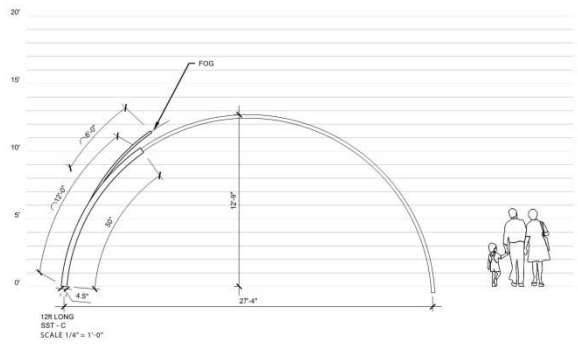

OKC : FOUNTAIN STUDIES
WAND JETS : 10 FT

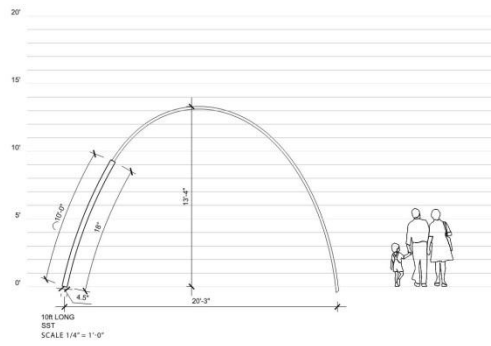

OKC : FOUNTAIN STUDIES
WAND JETS : 8 FT

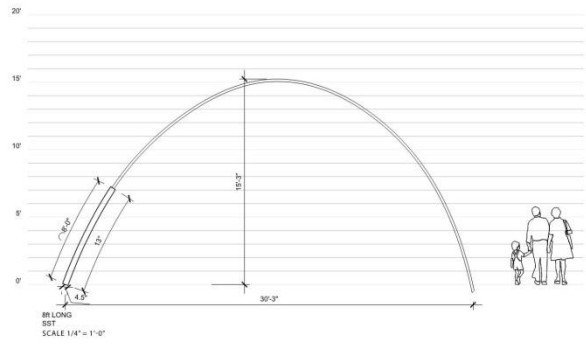

FOUNTAIN STUDIES
TS : 6 FT

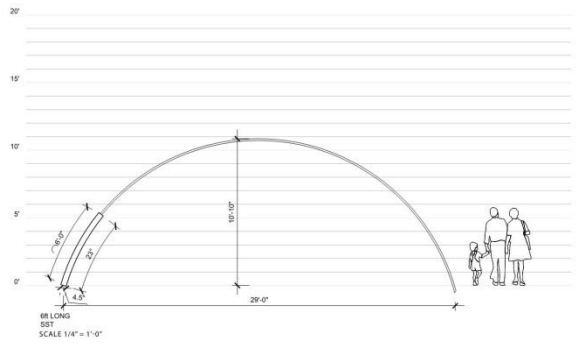

FOUNTAIN : Informal Layout (water on)

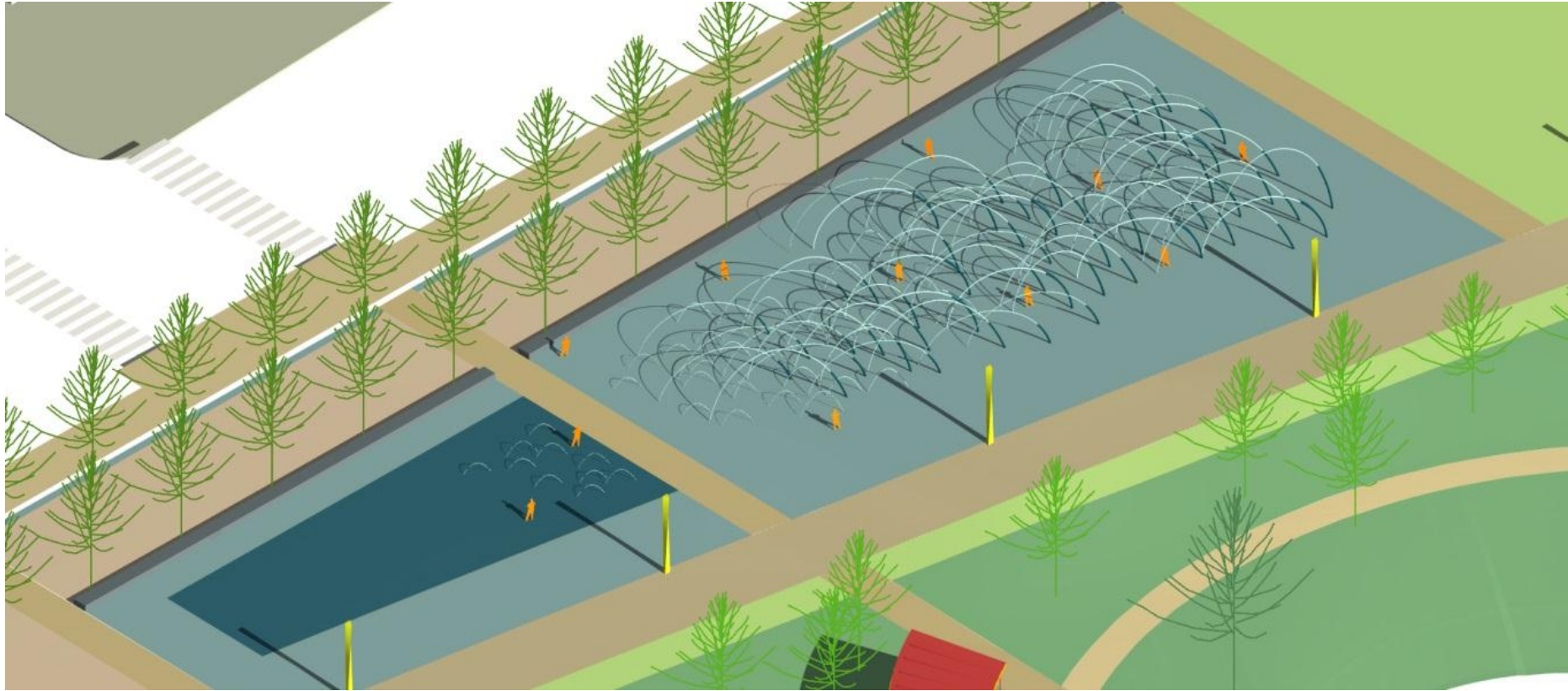

Note : Promenade trees not shown

FOUNTAIN : Informal Layout (jets off)

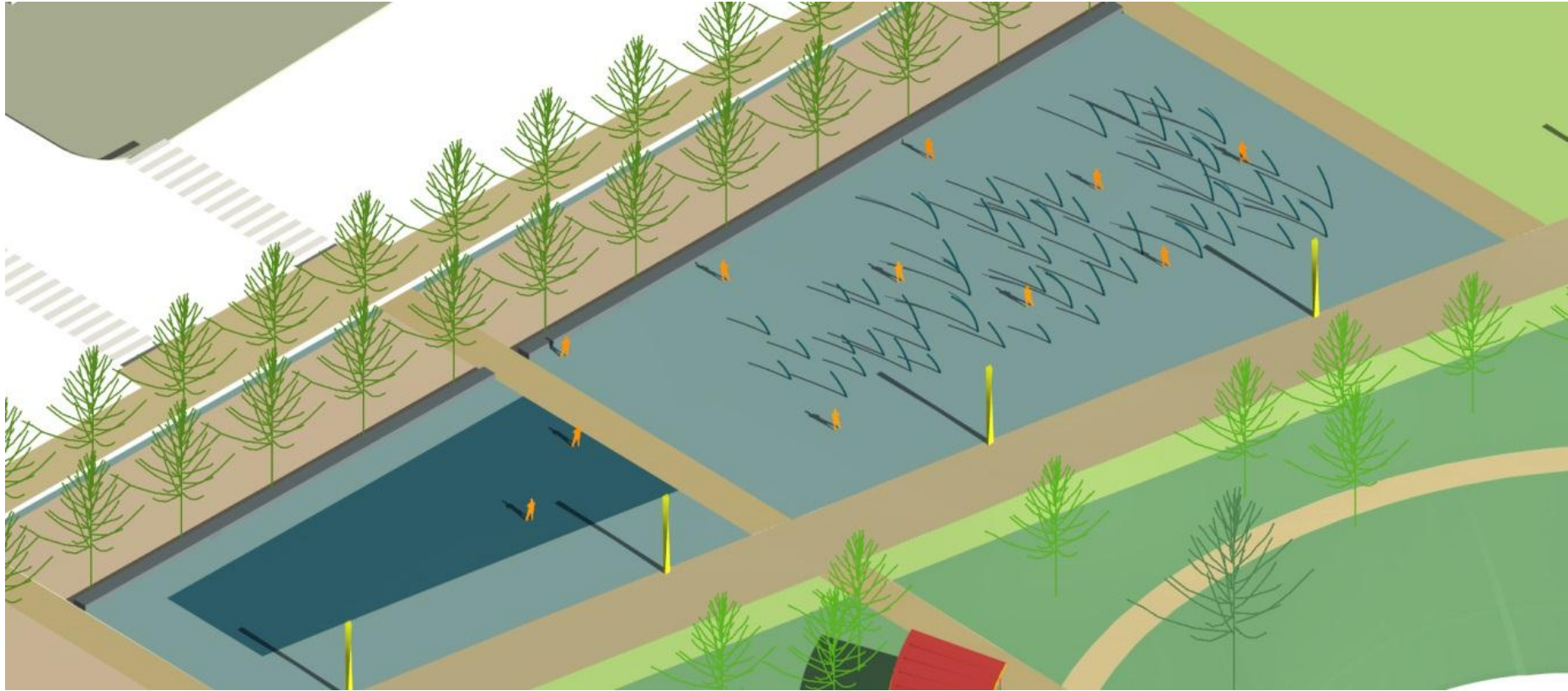

Note : Promenade trees not shown

FOUNTAIN : Informal Layout (water off)

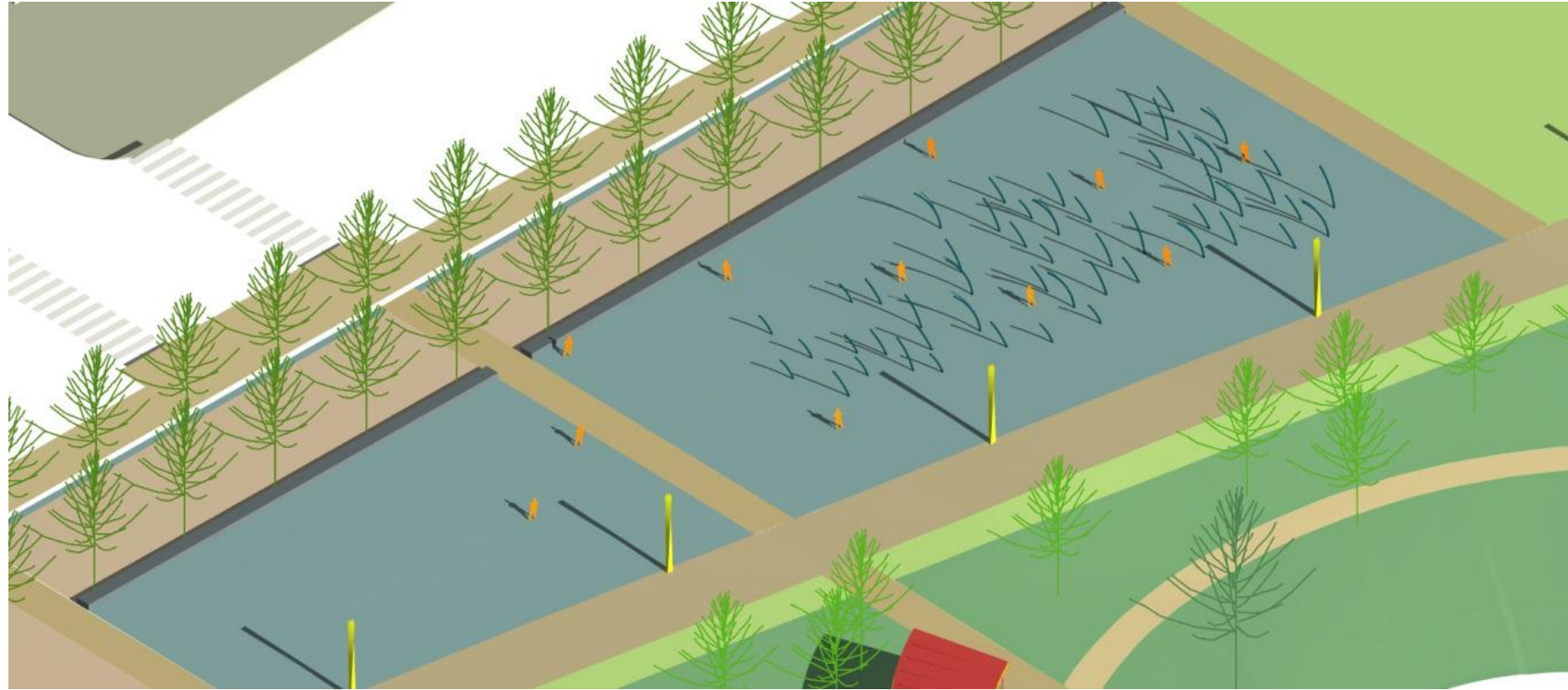

Note : Promenade trees not shown

FOUNTAIN : Water Effects



New Studies

PLAYGROUND

PLAY AREA – View – Schematic Design Progress



PLAY AREA - Age Appropriateness



Grade School
5-12 years



Teenagers &
Adults
12+ years

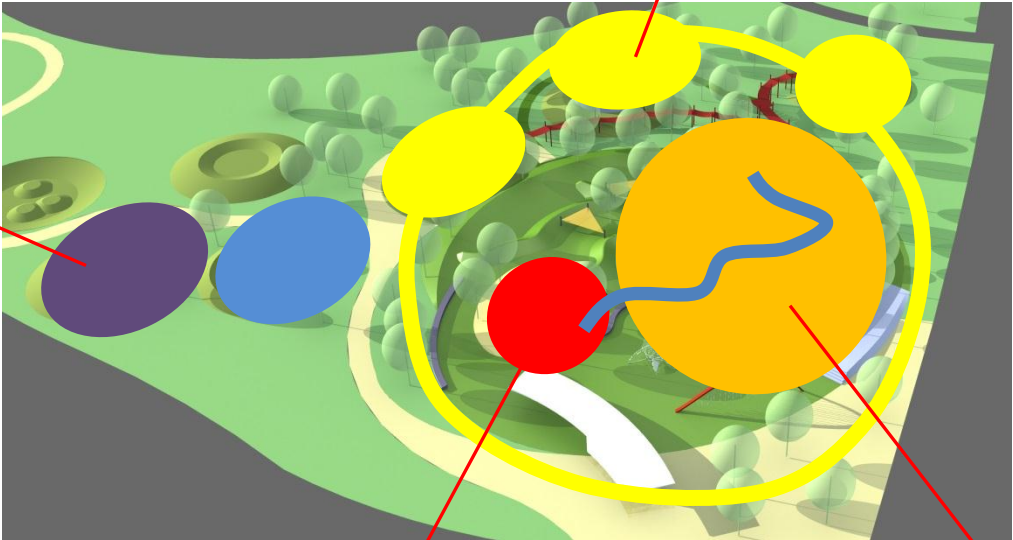

Pre-School
2-5 years



Toddlers
6-23 months



PLAY AREA – Indicative Equipment



Par course 12+

Sliding Hill 5-12



Spinner Valley 2-5

Climbing Wall 5-12



Web Valley 2-5



Tree Top Fort 5-12



Garden Maze



Sand Play toddler



ADA play 2-5

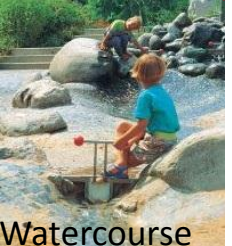

Watercourse

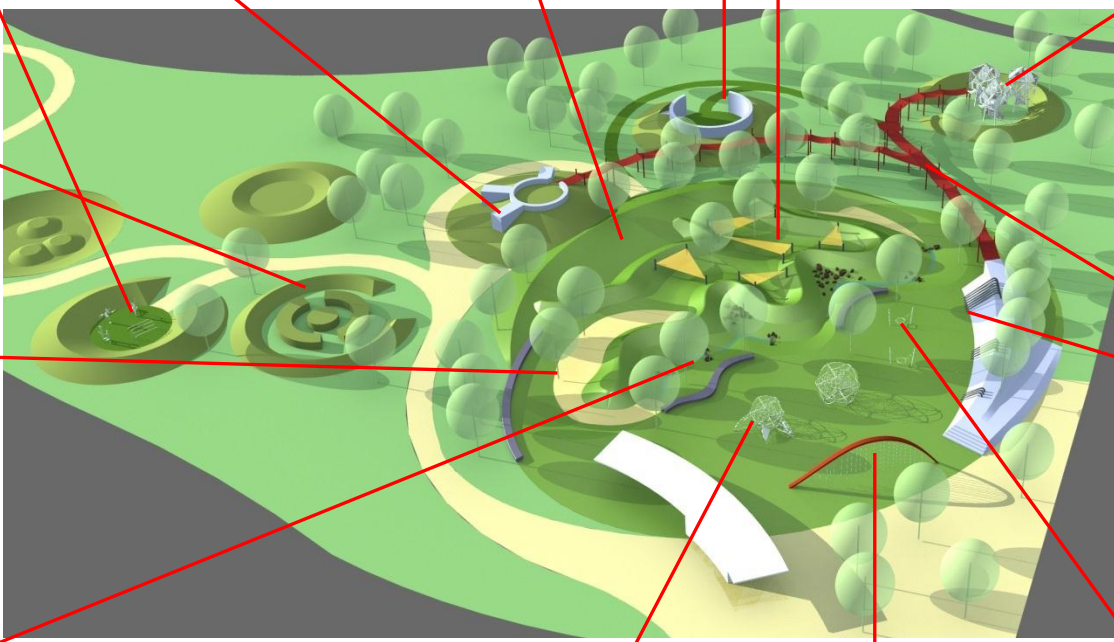

Rope Walk 5-12



Ramble Bank 2-5

Climbing Domes 2-5



Entry Arch



Swing Valley 2-5

PLAY AREA

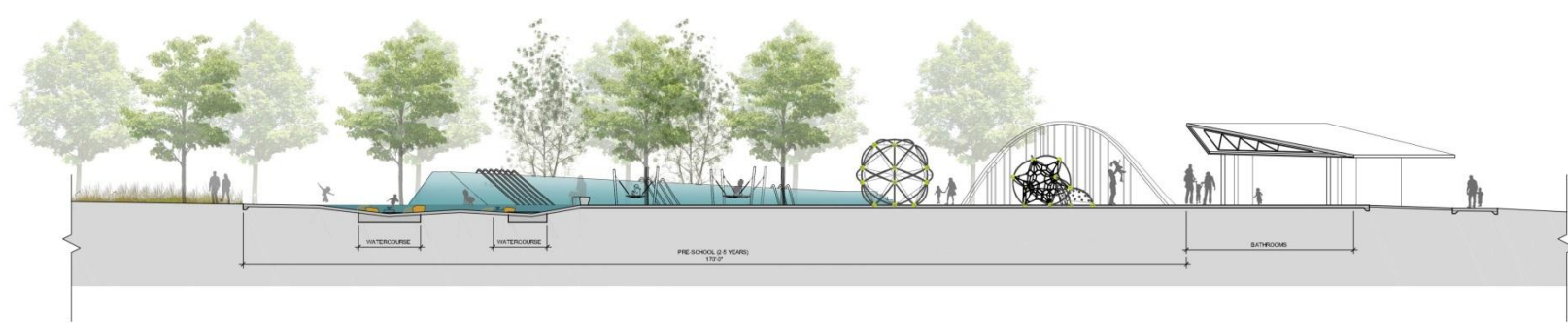
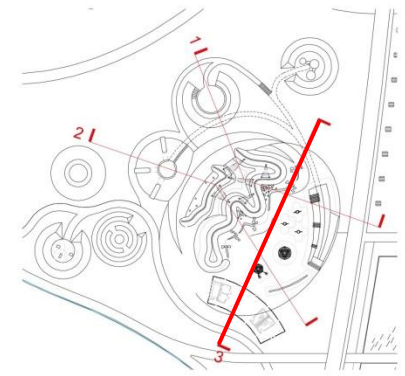

OKC - Playground
Section 3

scale 1/8" = 1'-0"

Nov 14, 2014

New Studies

BOULEVARD

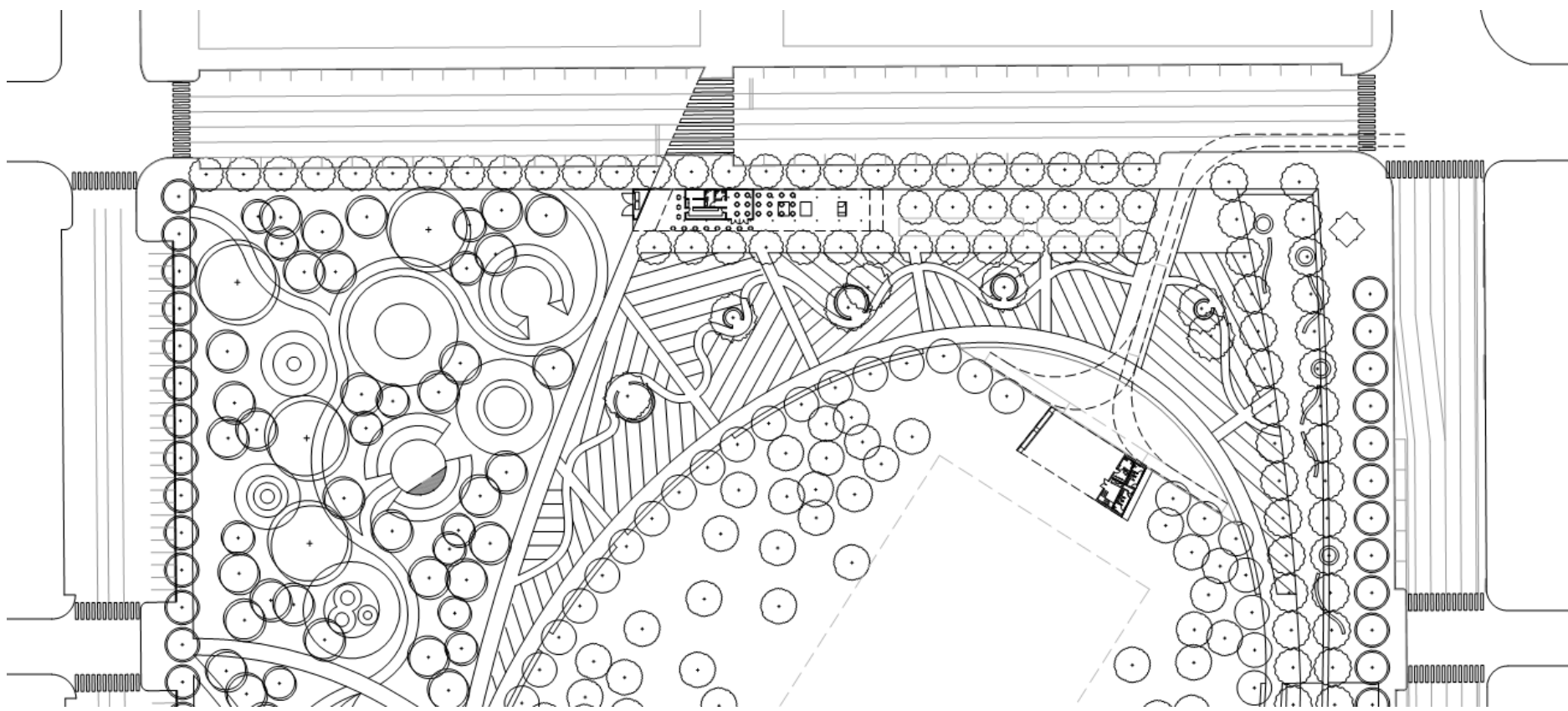



New Studies

ROBINSON AV

ROBINSON @ BOULEVARD

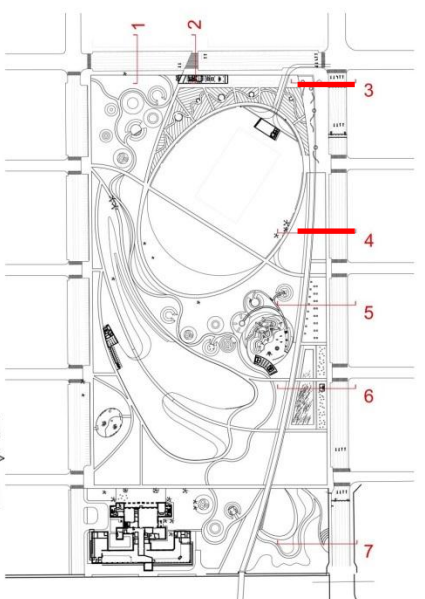
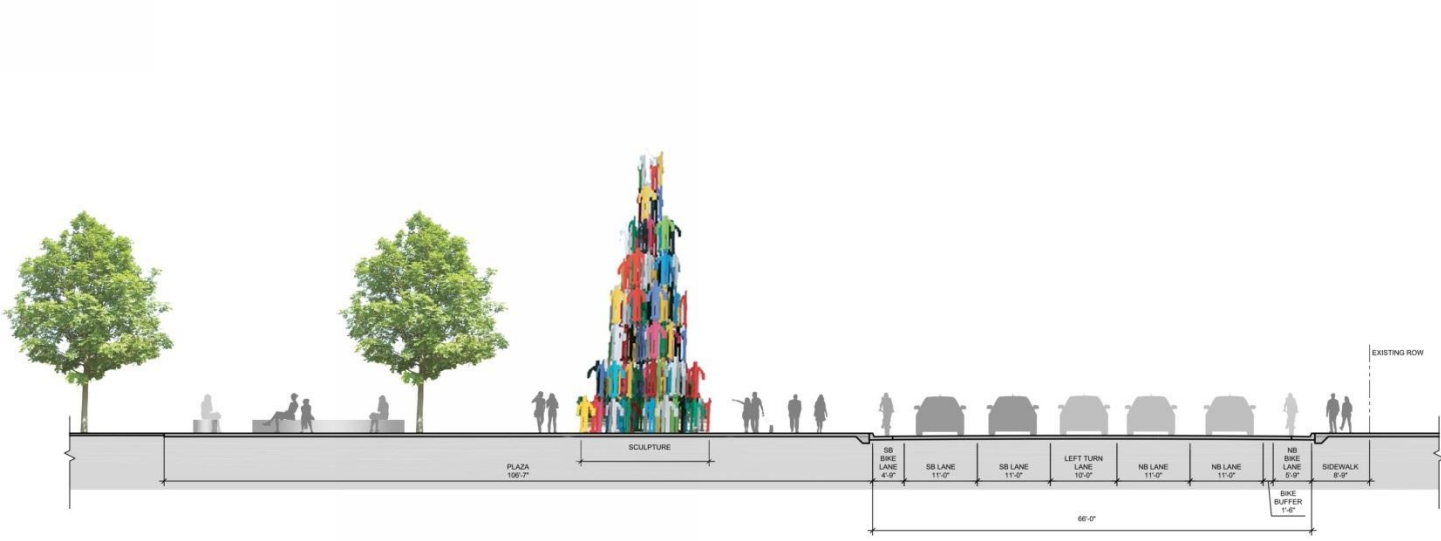

Section 3

Key Plan

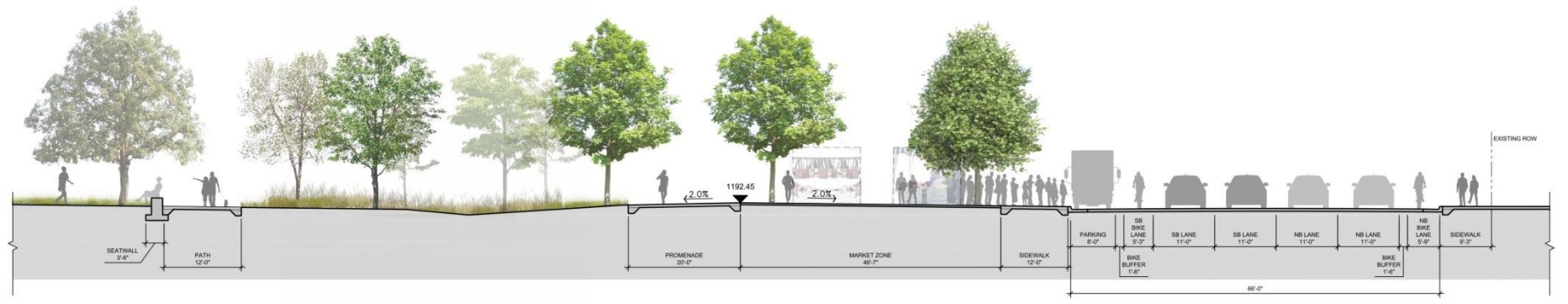

Section 4

ROBINSON @ FOUNTAIN

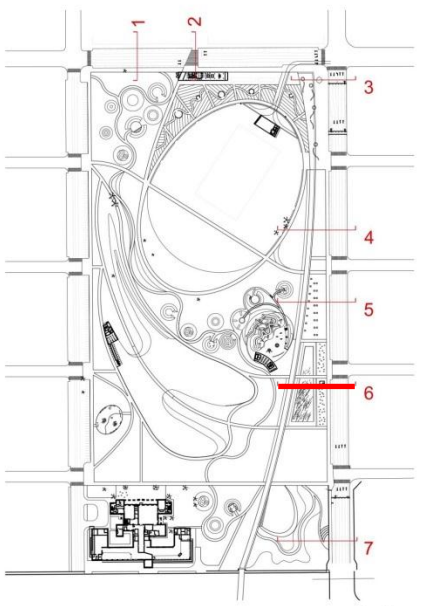

Key Plan

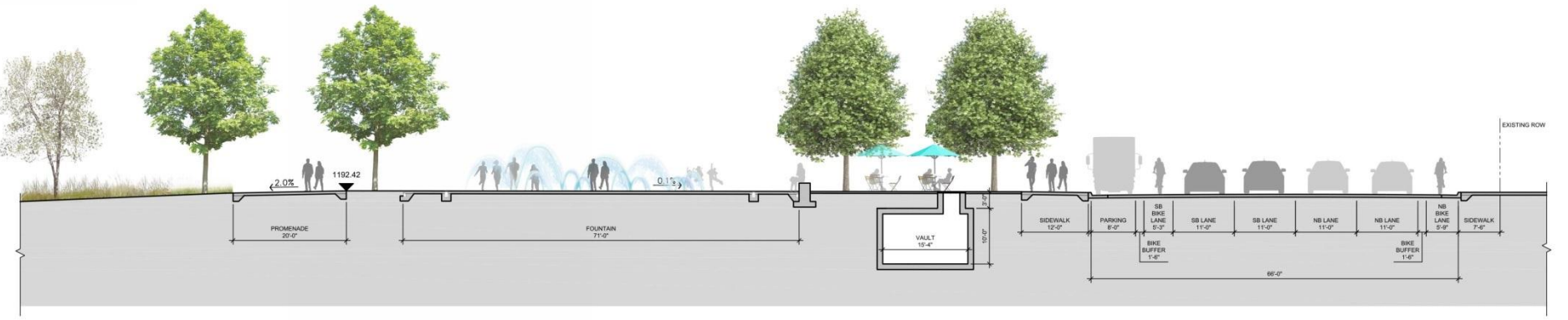

Section 6

ROBINSON @ OVERPASS/TUNNEL

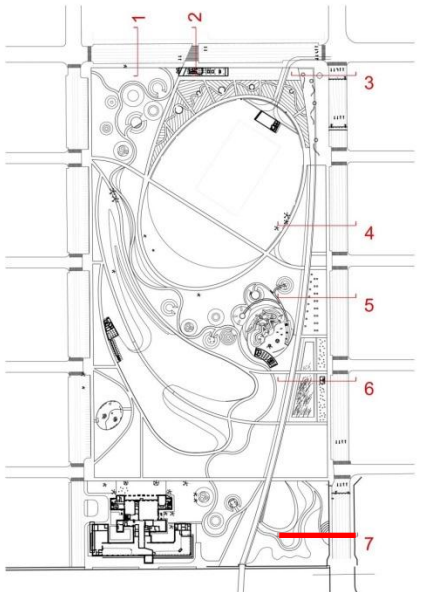

Key Plan



Section 7

New Studies

SCULPTURAL BENCHES for 100% CORNER

SCULPTURAL BENCHES



SCULPTURAL BENCHES

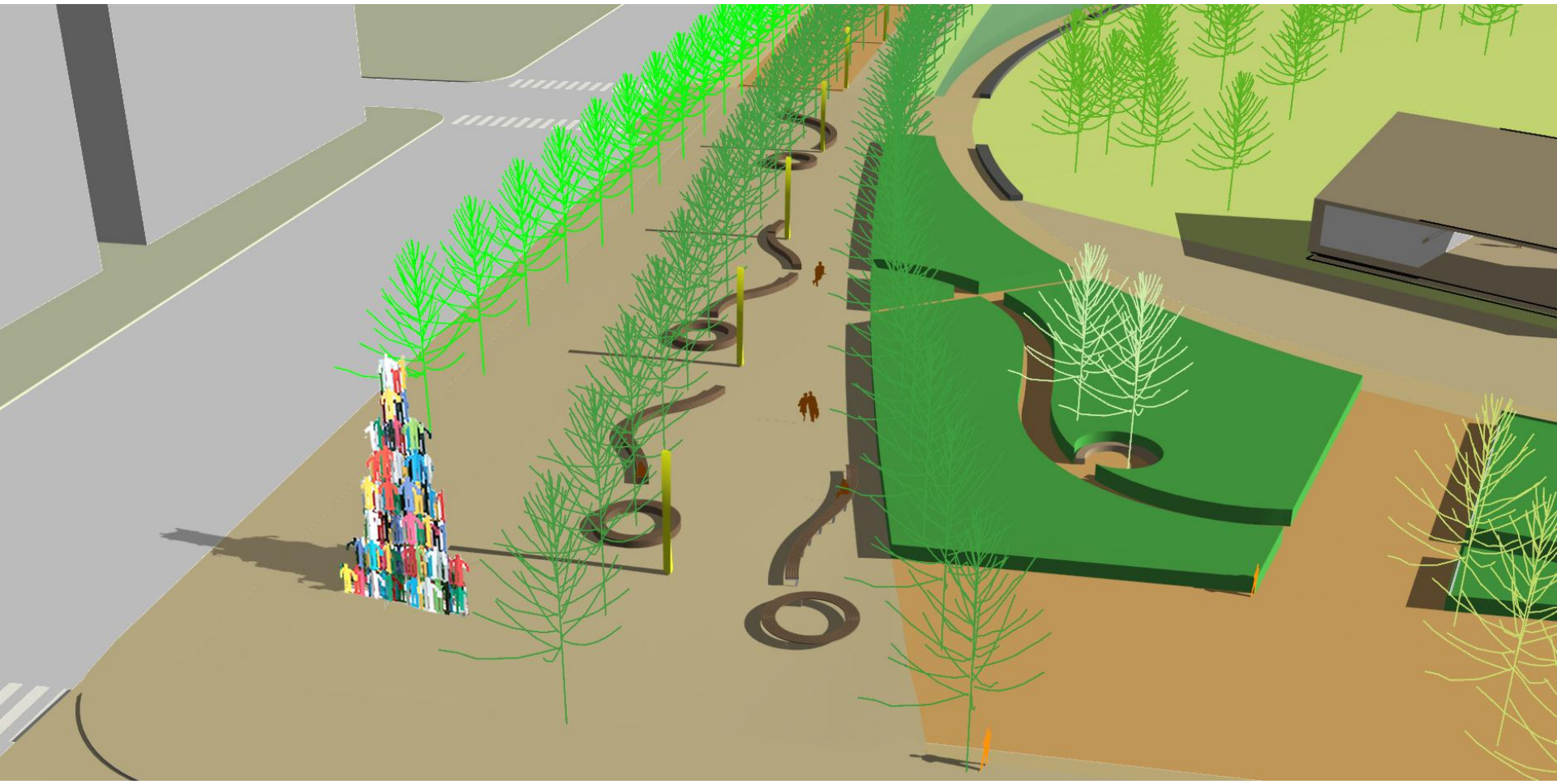

SCULPTURAL BENCHES





New Studies

DOG PARK

DOG PARK – Clearing in the Woodland



New Studies

BRIDGE

BRIDGE: Triple Span, Wooden Ribs

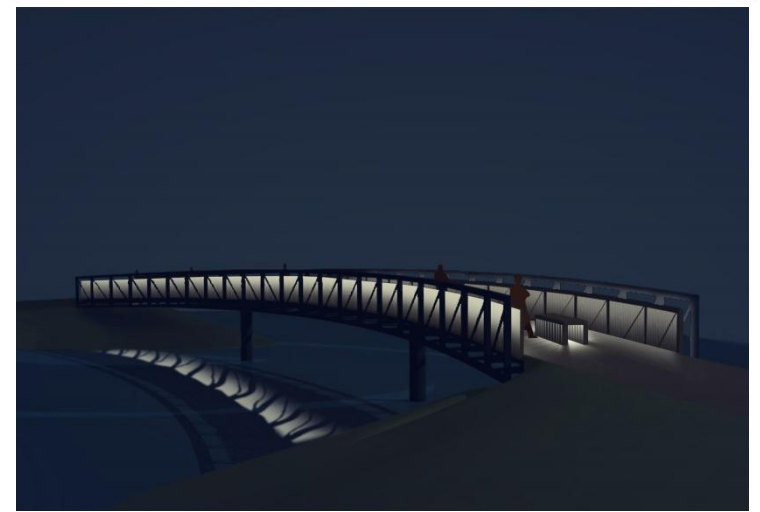
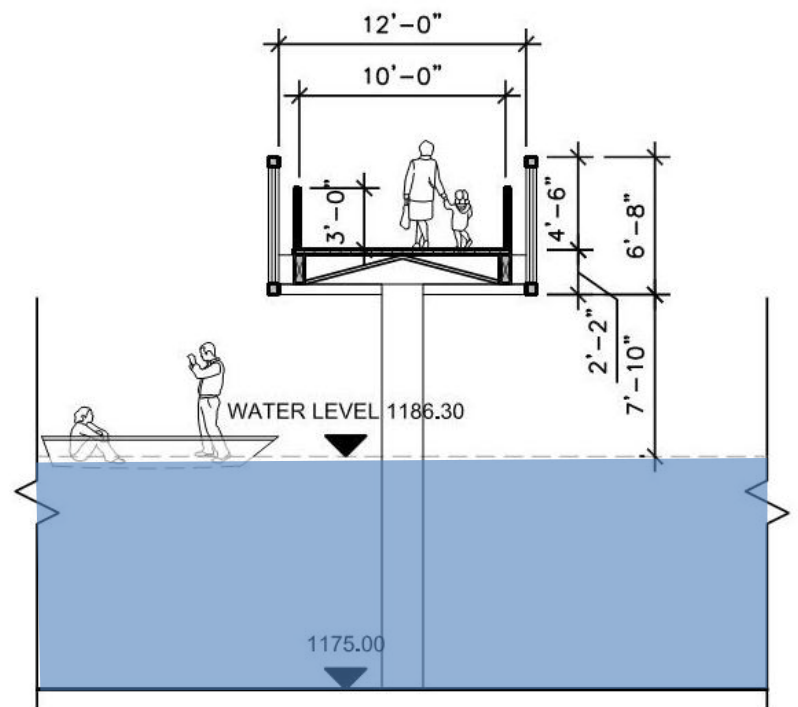
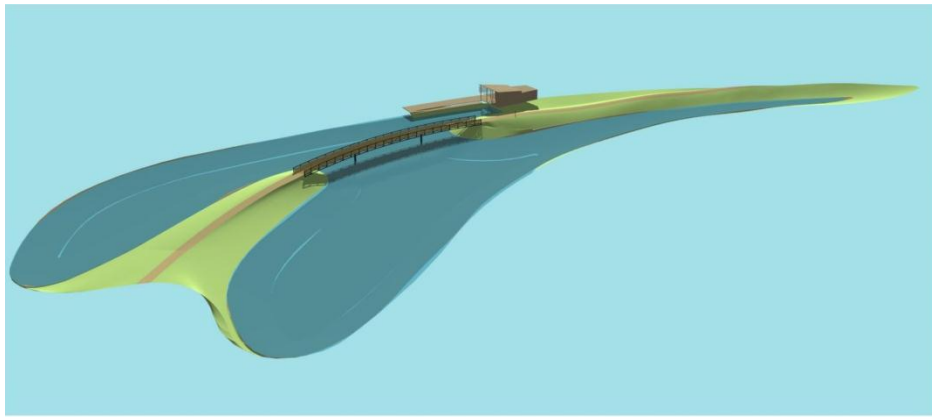

Next Steps

NEXT STEPS
CONCLUSION

NEXT STEPS

NEXT

- Continue to work with stakeholders
- Planting Strategy
- Shade Strategy
- Opinion of Probable Cost
- Preliminary Design Report by Feb 2015



END