



# TRAFFIC CONTROL PLAN

## OCTOBER 2-3, 2021

### Finish Line Closure Times

Tuesday September 28, 2021 at 8:00am to Monday October 4, 2021 at 5:00pm

- South Harvey Avenue from Southwest 2nd street to Oklahoma City Boulevard

Thursday September 30, 2021 at 6:00pm to Sunday October 3, 2021 at 6:00pm

- Oklahoma City Boulevard from South Lee Avenue to South Robinson Avenue
- Mick Cornett from South Robinson Avenue to South Shields Boulevard

### Start Line Closure Times

Thursday September 30, 2021 at 6:00pm to Sunday October 3, 2021 at 12:00pm

- N. Harvey Avenue from NW 5th Street to NW 10th Street

Friday October 1, 2021 10:00pm to Sunday October 3, 2021 at 12:00pm

*Will open up east/west streets noted below from 12:00pm to 10:00pm on Saturday October 2, 2021*

- N. Hudson Avenue from NW 4th Street to NW 10th Street  
*(all east/west streets in between)*
- N. Robinson Avenue from NW 4th Street to NW 10th Street  
*(all east/west streets in between)*





MARATHON, HALF MARATHON  
AND RELAY WAVE SEQUENCE  
OCTOBER 3, 2021

<b>WAVE 1</b>	<b>FULL/RELAY</b>
Opens @ 5:30AM Starts @ 6:30AM	
<b>WAVE 2</b>	<b>HALF #1</b>
Opens @ 7:00AM Starts @ 7:30AM	
<b>WAVE 3</b>	<b>HALF #2</b>
Opens @ 8:00AM Starts @ 8:30AM	

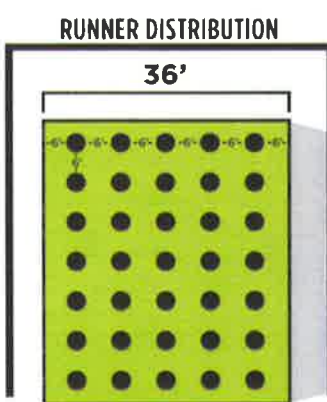

**ADDITIONAL INFORMATION**

EST. RUNNERS/WAVE: 5,500
ROAD WIDTH: 36'
RATE OF WALK PACE: 4.4FT/SEC
SQFT/RUNNER: 36
CORRAL A: ~41,000SQFT
CORRAL B: ~35,500SQFT
CORRAL C: ~24,500SQFT
CORRAL D: ~20,500SQFT
CORRAL E: ~43,500SQFT

## 2021 START SEQUENCE & LAYOUT

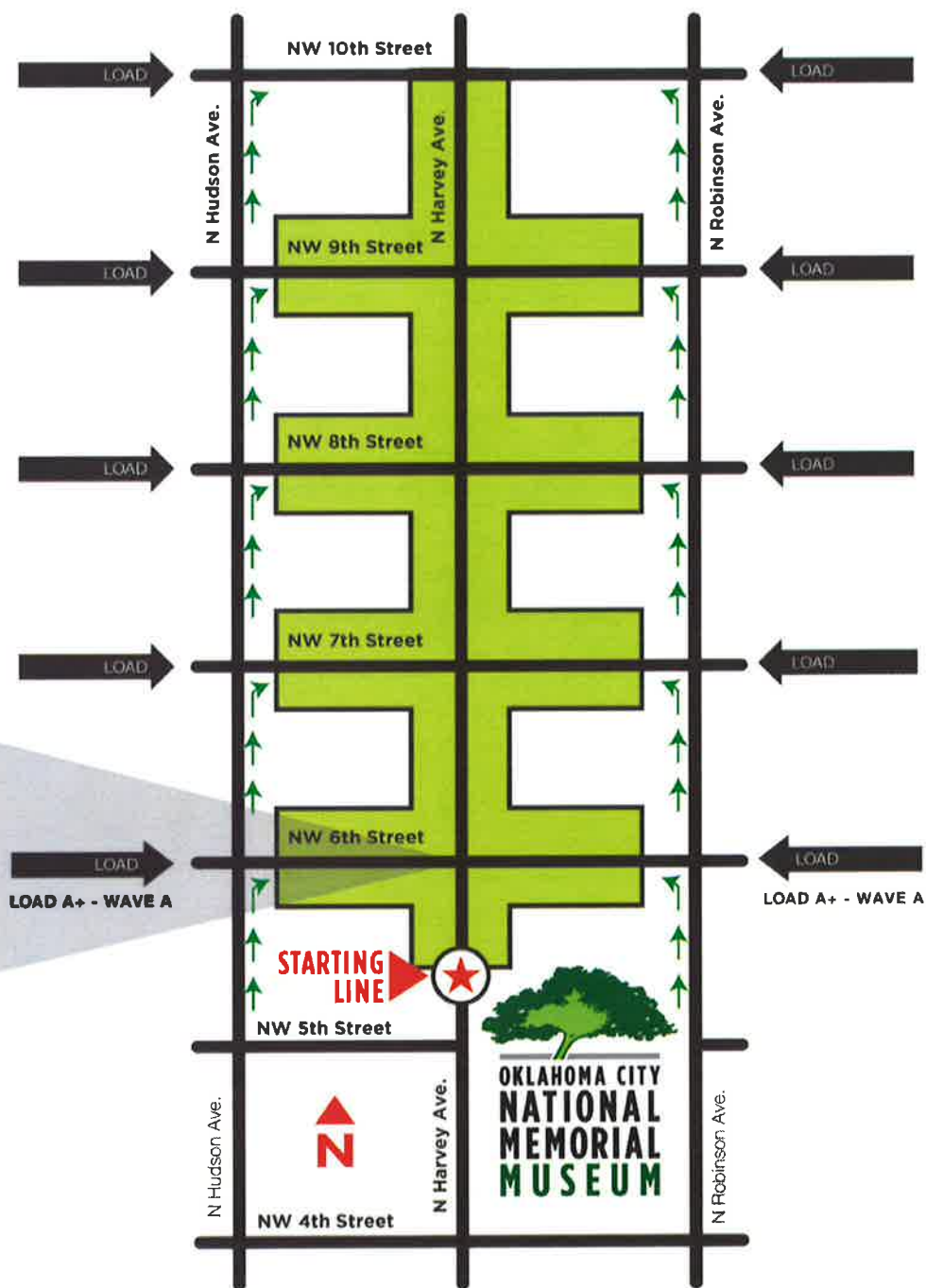

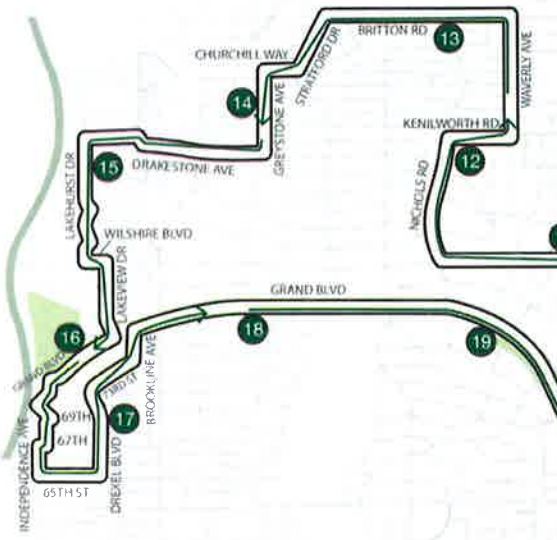

# FULL MARATHON 42.201 KM



**USATF Certificate**  
OK21003LAB  
Effective: 05/29/2021  
Through: 12/31/2031

THIS OKLAHOMA CITY OKLAHOMA COURSE WAS MEASURED FOLLOWING THE SHORTEST POSSIBLE ROUTE (SPRI) EXCEPT WHERE NOTED BY LOGAN A BURGESS ON APRIL 16, 17 & 18, 2021 - MAP NOT TO SCALE - RESTRICTIONS AS NOTED

### START DETAIL

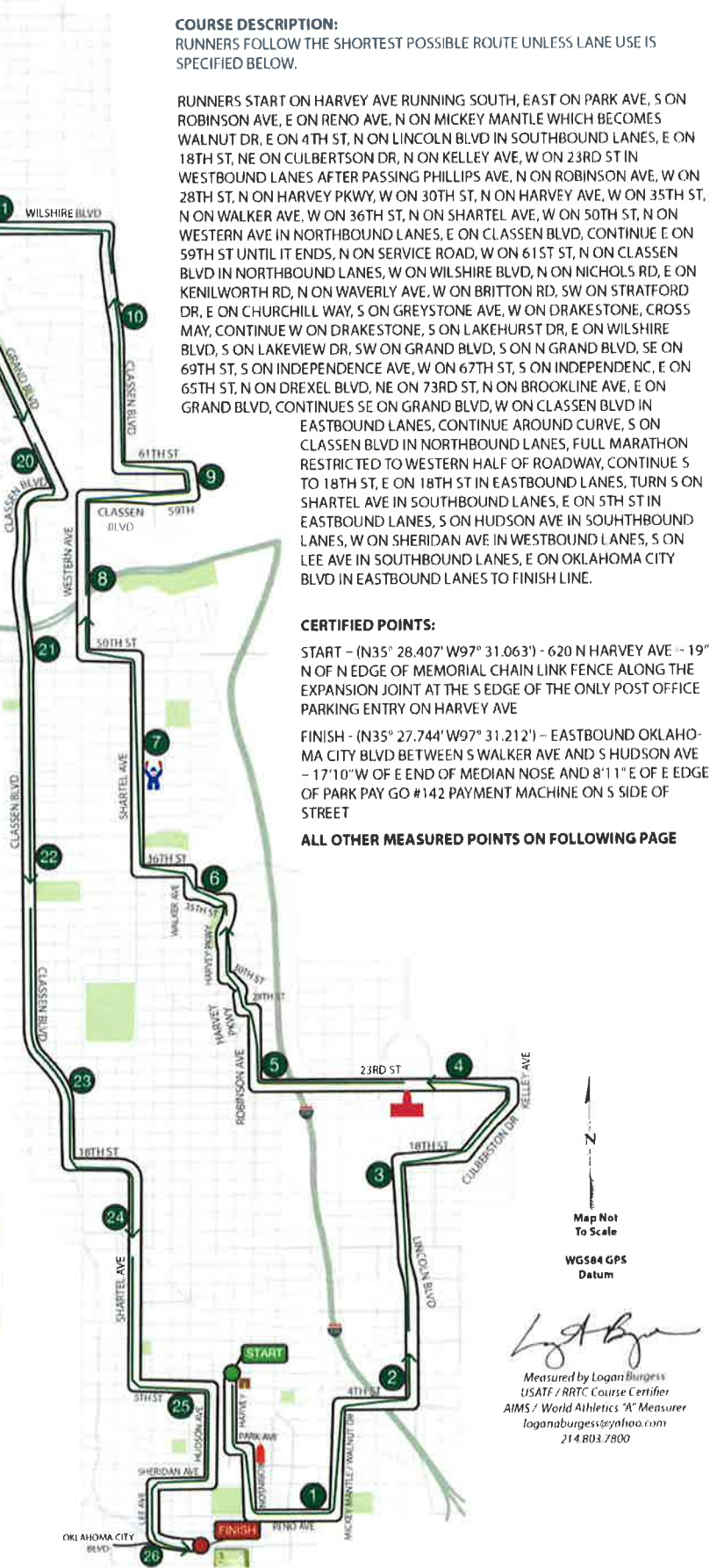
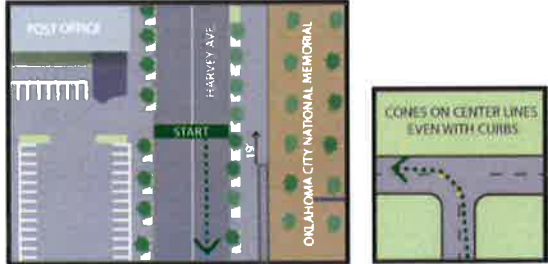

### COURSE DESCRIPTION:

RUNNERS FOLLOW THE SHORTEST POSSIBLE ROUTE UNLESS LANE USE IS SPECIFIED BELOW.

RUNNERS START ON HARVEY AVE RUNNING SOUTH, EAST ON PARK AVE, S ON ROBINSON AVE, E ON RENO AVE, N ON MICKEY MANTLE WHICH BECOMES WALNUT DR, E ON 4TH ST, N ON LINCOLN BLVD IN SOUTHBOUND LANES, E ON 18TH ST, NE ON CULBERTSON DR, N ON KELLEY AVE, W ON 23RD ST IN WESTBOUND LANES AFTER PASSING PHILLIPS AVE, N ON ROBINSON AVE, W ON 28TH ST, N ON HARVEY PKWY, W ON 30TH ST, N ON HARVEY AVE, W ON 35TH ST, N ON WALKER AVE, W ON 36TH ST, N ON SHARTEL AVE, W ON 50TH ST, N ON WESTERN AVE IN NORTHBOUND LANES, E ON CLASSEN BLVD, CONTINUE E ON 59TH ST UNTIL IT ENDS, N ON SERVICE ROAD, W ON 61ST ST, N ON CLASSEN BLVD IN NORTHBOUND LANES, W ON WILSHIRE BLVD, N ON NICHOLS RD, E ON KENILWORTH RD, N ON WAVERLY AVE, W ON BRITTON RD, SW ON STRATFORD DR, E ON CHURCHILL WAY, S ON GREYSTONE AVE, W ON DRAKESTONE, CROSS MAY, CONTINUE W ON DRAKESTONE, S ON LAKEHURST DR, E ON WILSHIRE BLVD, S ON LAKEVIEW DR, SW ON GRAND BLVD, S ON N GRAND BLVD, SE ON 69TH ST, S ON INDEPENDENCE AVE, W ON 67TH ST, S ON INDEPENDENC, E ON 65TH ST, N ON DREXEL BLVD, NE ON 73RD ST, N ON BROOKLINE AVE, E ON GRAND BLVD, CONTINUES SE ON GRAND BLVD, W ON CLASSEN BLVD IN EASTBOUND LANES, CONTINUE AROUND CURVE, S ON CLASSEN BLVD IN NORTHBOUND LANES, FULL MARATHON RESTRICTED TO WESTERN HALF OF ROADWAY, CONTINUE S TO 18TH ST, E ON 18TH ST IN EASTBOUND LANES, TURN S ON SHARTEL AVE IN SOUTHBOUND LANES, E ON 5TH ST IN EASTBOUND LANES, S ON HUDSON AVE IN SOUTHBOUND LANES, W ON SHERIDAN AVE IN WESTBOUND LANES, S ON LEE AVE IN SOUTHBOUND LANES, E ON OKLAHOMA CITY BLVD IN EASTBOUND LANES TO FINISH LINE.

### CERTIFIED POINTS:

START - (N35° 28.407' W97° 31.063') - 620 N HARVEY AVE - 19" N OF N EDGE OF MEMORIAL CHAIN LINK FENCE ALONG THE EXPANSION JOINT AT THE S EDGE OF THE ONLY POST OFFICE PARKING ENTRY ON HARVEY AVE

FINISH - (N35° 27.744' W97° 31.212') - EASTBOUND OKLAHOMA CITY BLVD BETWEEN S WALKER AVE AND S HUDSON AVE - 17'10"W OF E END OF MEDIAN NOSE AND 8'11"E OF E EDGE OF PARK PAY GO #142 PAYMENT MACHINE ON S SIDE OF STREET

ALL OTHER MEASURED POINTS ON FOLLOWING PAGE

Map Not To Scale  
WGS84 GPS Datum

*Logan Burgess*  
Measured by Logan Burgess  
USATF / RRTC Course Certifier  
AIMS / World Athletics "A" Measurer  
loganaburgess@nhoo.com  
214.803.7800

**COURSE DESCRIPTION:**

RUNNERS FOLLOW THE SHORTEST POSSIBLE ROUTE UNLESS LANE USE IS SPECIFIED BELOW.

RUNNERS START ON HARVEY AVE RUNNING SOUTH, EAST ON PARK AVE, S ON ROBINSON AVE, E ON RENO AVE, N ON MICKEY MANTLE WHICH BECOMES WALNUT DR, E ON 4TH ST, N ON LINCOLN BLVD IN SOUTHBOUND LANES, E ON 18TH ST, NE ON CULBERTSON DR, N ON KELLEY AVE, W ON 23RD ST IN WESTBOUND LANES AFTER PASSING PHILLIPS AVE, N ON ROBINSON AVE, W ON 28TH ST, N ON HARVEY PKWY, W ON 30TH ST, N ON HARVEY AVE, W ON 35TH ST, N ON WALKER AVE, W ON 36TH ST, N ON SHARTEL AVE, W ON 50TH ST, SW ON CLASSEN CIR, S ON CLASSEN BLVD IN NORTHBOUND LANES, HALF MARATHON RESTRICTED TO EASTERN HALF OF ROADWAY, CONTINUE S TO 18TH ST, E ON 18TH ST IN WESTBOUND LANES, TURN S ON SHARTEL AVE IN NORTHBOUND LANES, E ON 5TH ST IN WESTBOUND LANES, S ON HUDSON AVE IN NORTHBOUND LANES, W ON SHERIDAN AVE IN EASTBOUND LANES, S ON LEE AVE IN NORTHBOUND LANES, E ON OKLAHOMA CITY BLVD IN WESTBOUND LANES TO FINISH LINE.

**CERTIFIED POINTS:**

START - (N35° 28.407' W97° 31.063') - 620 N HARVEY AVE - 19" N OF N EDGE OF MEMORIAL CHAIN LINK FENCE ALONG THE EXPANSION JOINT AT THE S EDGE OF THE ONLY POST OFFICE PARKING ENTRY ON HARVEY AVE

FINISH - (N35° 27.744' W97° 31.212') - WESTBOUND OKLAHOMA CITY BLVD BETWEEN S WALKER AVE AND S HUDSON AVE - 17'10" W OF E END OF MEDIAN NOSE AND 20'9" E OF E EDGE OF PARK PAY GO #41 PAYMENT MACHINE ON N SIDE OF STREET

**ALL OTHER MEASURED POINTS ON FOLLOWING PAGE**

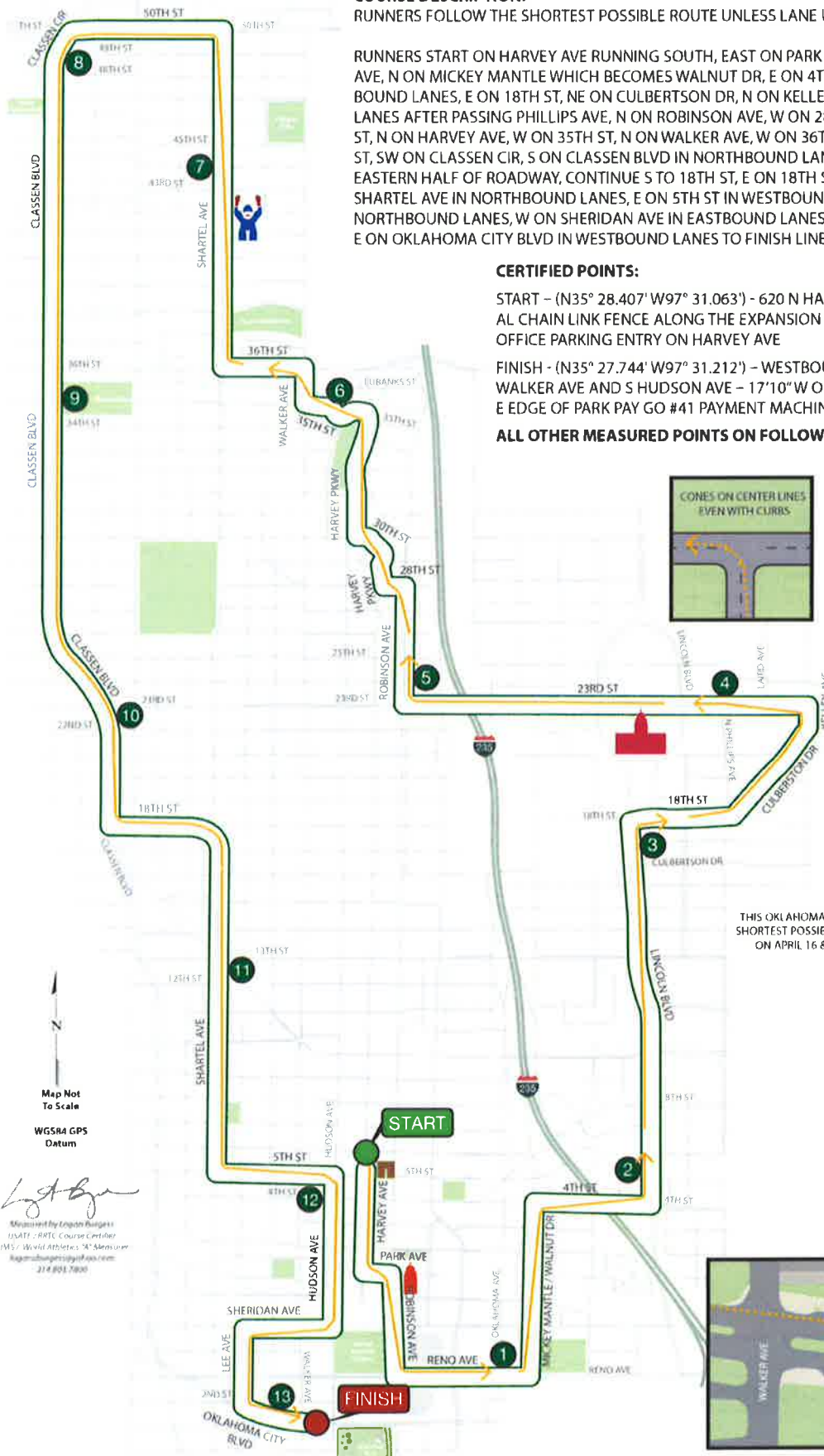

**HALF MARATHON**  
21.0975 KM



**USATF Certificate**  
OK21002LAB  
Effective: 05/19/2021  
Through: 12/31/2031

THIS OKLAHOMA CITY OKLAHOMA COURSE WAS MEASURED FOLLOWING THE SHORTEST POSSIBLE ROUTE (SPR) EXCEPT WHERE NOTED BY LOGAN A. BURGESS ON APRIL 16 & 17, 2021 - MAP NOT TO SCALE - RESTRICTIONS AS NOTED

**START DETAIL**



**FINISH DETAIL**

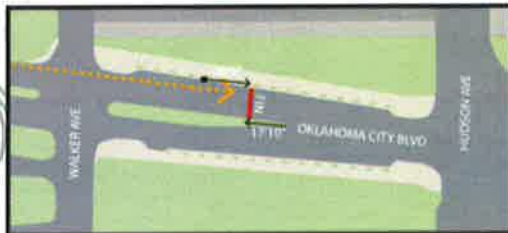

Map Not To Scale  
WGS84 GPS Datum  
*Logan A. Burgess*  
Measured by Logan Burgess  
USATF - RTRC Course Checker  
AIMS / World Athletics "A" Member  
logan@burgessgps.com  
214.801.7800

