

NORTHEAST OKC TOWN HALL

Tuesday, October 26
6:00 - 8:30 PM
Auditorium at the Douglass
600 N. High Ave.

Brockway/Lyons Mansion
Community Engagement
South of 8th Study
Jewel Theatre

Vanessa Morrison



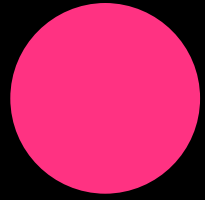

Open Design Collective

OPEN DESIGN

Formerly known as BlackSpace Oklahoma, we're a collective of built environment professionals who collaborate with communities and organizations to practice new ways of protecting and creating Black spaces.



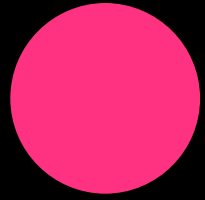

We experience some of our deepest
connections in shared spaces.

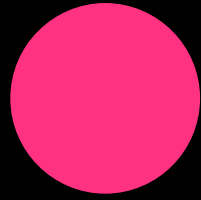

3 PROJECTS

Why?

How?

Outcomes

South of 8th: A Community Vision

Commi s s i o n e d b y OCRA

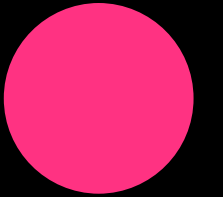

OPEN DESIGN
COLLECTIVE

In collaboration with

The NE OKC Community

& Sofola & Associates, Christina Beatty, Afiya Wilkins, Nuevo Studio





South of 8th: A Community Vision

- **WHY:** OCURA owns several vacant lots in the NE OKC community and wants to position community members to own and redevelop them
- **HOW WE'RE HELPING:** Leading a community engagement effort collaborate with community members in the visioning of this community
- **OUTCOME:** A masterplan for the focus area

Opportunities to get involved:



- OPEN EVENTS (4)
- TACTICAL COMMITTEE (7)
 - Creating space for the community to lead the discussion and take ownership
- TOPIC SPECIFIC DISCUSSIONS / EDUCATIONAL COMPONENTS (5)
- FOLLOW OUR PROGRESS & GIVE FEEDBACK
 - Through social media and website
 - We will be updating neighborhood association presidents on progress and listening to feedback



A COMMUNITY VISION

Lincoln Blvd.

N.E. 8th St

Lottie Ave.

N.E. 4th St

N.E. 1st St

**LINCOLN — LOTTIE
8TH — RAILROAD TRACKS**



Join Open Design Collective for a community-led visioning session to reflect & reimagine our community located south of NE 8th Street.

Community members will engage in meaningful activities &
dialogue centered on the history of this area.
We'll also explore how we can intentionally preserve our culture.

There will be two separate visioning sessions. Your attendance is requested at one.
RSVP PREFERRED. SELECT YOUR SESSION:

SESSION 1: SESSION 2:
10:00AM - 12:15PM -OR- 12:45PM- 3:00PM
SAT. NOV 13TH SAT. NOV 13TH

THE BRYANT CENTER
2200 NORTH BRYANT AVENUE
OKLAHOMA CITY, OK 73121

This event is free and is open to members of the NE OKC community.
LUNCH WILL BE PROVIDED.

RSVP PREFERRED: SCAN QR CODE
Questions? Contact hello@OpenDesignCo.org or
405.510.0874
S08TH0KC.COM



PRSR STD
ECRWSS
U.S.POSTAGE
PAID
EDDM Retail

LOCAL POSTAL
CUSTOMER

Follow us:
  
@S08TH0KC

Restoration toward Reconciliation: Planning for the Future of the

Brockway Center and Lyons Mansion

Reuse Feasibility Study

Commissioned by OCURA

OPEN DESIGN
COLLECTIVE

In collaboration with

The NE OKC Community

& Christina Beatty, Lord Cultural Resources, Nuevo Studio

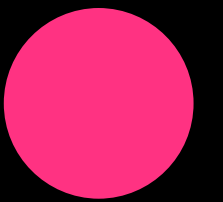



Brockway and Lyons/ Luster Mansion

- **WHY:** OCURA owns 2 of the few standing Black, cultural assets that represent legacies of Black wealth and activism in NE OKC
- **HOW WE'RE HELPING:** In collaboration with OCURA and NE OKC community members, we're co-leading a community engagement and programming effort to restore these two cultural assets
- **OUTCOME:** The final deliverable will be a set of recommendations for the redevelopment and programming of these spaces

Opportunities to get involved:

- OPEN EVENTS (2)
- TACTICAL COMMITTEE(2)
- INDIVIDUAL OR SMALL GROUP CONNECTING
- EDUCATIONAL COMPONENTS
 - Details about educational components will be released as the project develops
- FOLLOW OUR PROGRESS & GIVE FEEDBACK
 - Through social media
 - Other opportunities will be released as the project develops

Open Event | Cultural Network & Urban Context

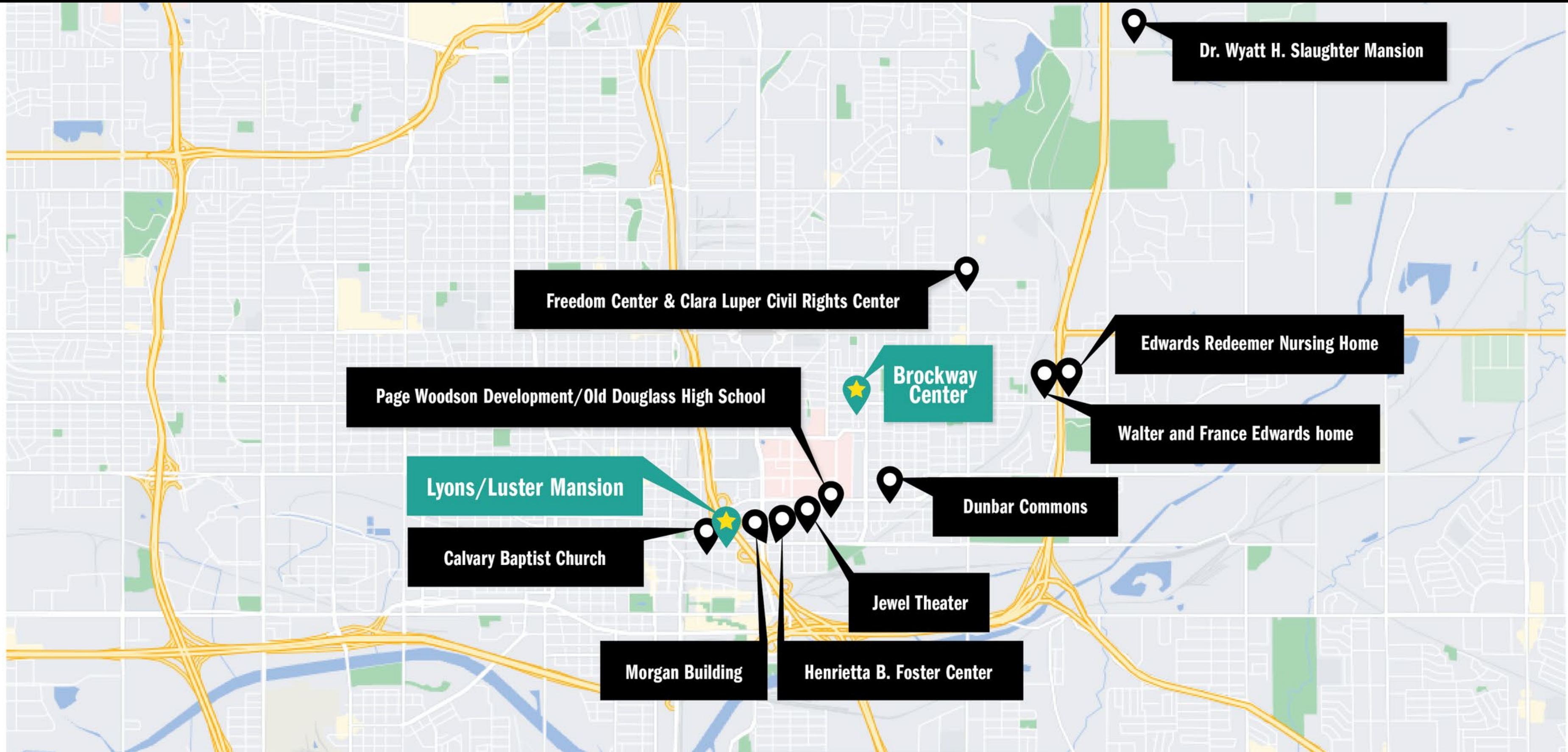

Open Event | Urban Context & Programming



Tactical Committee | Architecture & Programming



Networking and Coordinating

Tactical Committee + Potential Investors & Stewards | Stewardship & Sustainable Funding



Congress for New Urbanism (CNU)

Legacy Project: Jewel Theater

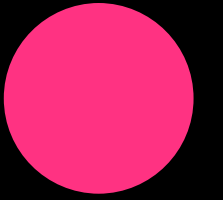

Commi s s i o n e d b y CNU

Councilwoman Nice

Aurthur Hurst

Concordia

OPEN DESIGN

COLLECTIVE



CNU Legacy Project: Jewel Theater



- **WHY:** Oklahoma's only standing, historic Black theater is at risk
- **HOW WERE HELPING:** In collaboration with Mr. Hurst (owner), Councilwoman Nice, the Alliance and CNU, we are helping to identify pathways to support the revitalization of the Jewel Theater
- **HOW:** Coordinating community engagement efforts for Concordia, a New Orleans-based design and engagement firm to provide recommendations for this effort
- **OUTCOME:** A near-term strategy to help implement solutions to support the Jewel Theater in the present and in the future.

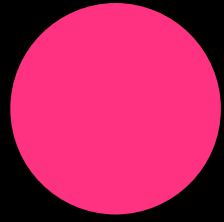

NE OKC

HOW MIGHT WE ACKNOWLEDGE
HISTORY AND CULTURE



TO ENSURE THAT BLACK SPACES,
CULTURE, AND PEOPLE THRIVE IN THE
FUTURE



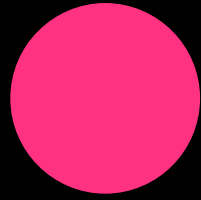

THANK YOU!

www.so8thokc.com

[@so8thokc](#)

hello@pendesignco.org

Page Woodson Plaza and Future Development

Gina Sofola/Ron Bradshaw

The bottom of the slide features three horizontal stripes of varying shades of blue. The top stripe is a medium blue, the middle stripe is a lighter blue, and the bottom stripe is a very light blue.

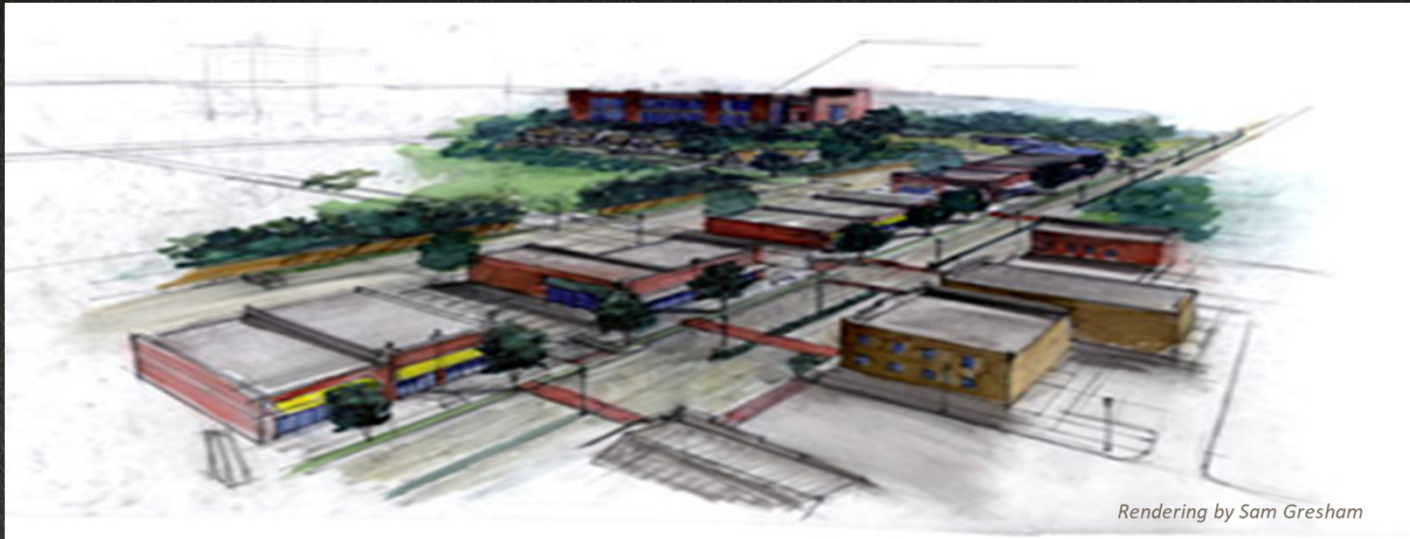

Rendering by Sam Gresham



PAGE WOODSON

dreams into reality

Colony Partners



PHASE I

THE DOUGLAS AND DOUGLAS NEXT DOOR



PHASE II - THE SEVEN











PHASE III - NEW PAGE WEST





Gardner Architects



Page Woodson Redevelopment
2015-07-18

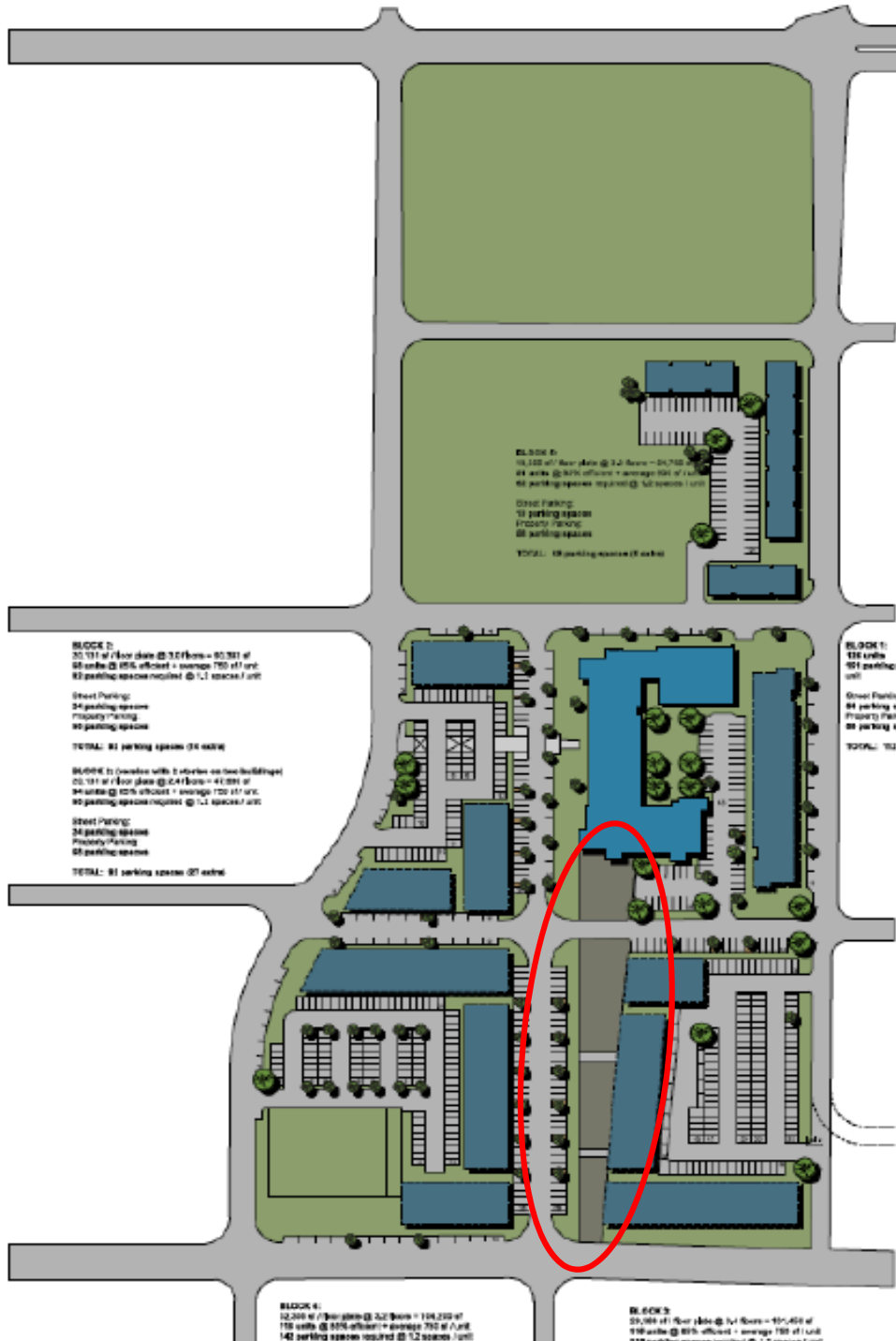

COMMEMORATE, CELEBRATE, EDUCATE

THE SCHOOL

- Built in 1910
- Segregated in 1934, and became Douglass High 1955, 1960, 1975 Name Changes ending with Page Woodson (Inman Page and Carter G. Woodson)
- Abandoned in 1994

THE PEOPLE

- Home to early African-American community leaders
- African American Leaders graced halls
- Local Heroes, Clara Luper, Russell Perry, Anita Arnold, & Commissioner Willa Johnson Attended or taught plus many more

THE COMMUNITY

- Legacy
- Perseverance
- Resilience
- Commitment to Family, Education, Entrepreneurship, Future



Inman Page

Zelia Breaux

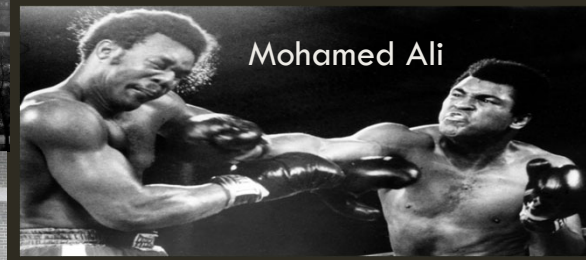
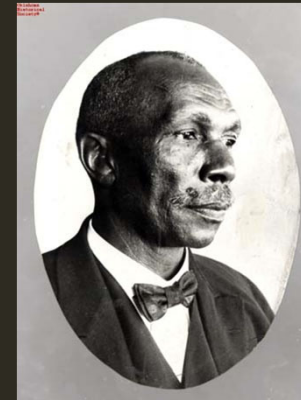

Mohamed Ali



Mary McLeod
Bethune

Jessie Owens

Marian Anderson

Thurgood
Marshall

Joe Lewis

Duke Ellington

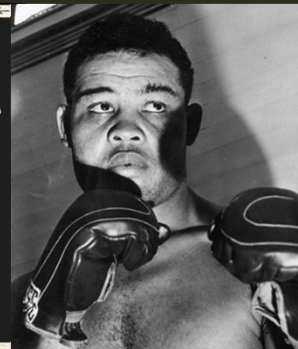

Phase II & IIB
Market-Rate Housing

Future
TBD



development







PLANNING AND SELECTION
COMMITTEE HAS BEEN
BY INVITATION
GOAL/OBJECTIVES – ESTABLISH
DESIGN CRITERIA, EVALUATION
CRITERIA, SELECTION OF
DESIGNERS

FOR CONTINUED UPDATES
CONTACT

Gina Sofola, AICP

gsofola@sofolaassociates.com

203.613.9471

The Hill at Bricktown

Cassi Poor

The bottom of the slide features three horizontal stripes of varying shades of blue. The top stripe is a vibrant, medium-dark blue. Below it is a lighter, sky-blue stripe, and the bottom-most stripe is a very light, pale blue.

The Hill at Bricktown

- OCURA issued an RFP for development of remaining, undeveloped property at the Hill at Bricktown
- Received one proposal from Burnett Equity (conditional redeveloper)





- Developer is working with existing HOA to determine an appropriate mix and style of units that is acceptable to the HOA and the market

Urban Renewal Residential Lots

Cassi Poor

The bottom of the slide features three horizontal stripes of varying shades of blue. The top stripe is a medium blue, the middle stripe is a lighter blue, and the bottom stripe is a very light blue.

RFPs for Residential Homes

- A Request for Proposals (RFP) is a document that solicits proposals for redevelopment of a particular site.
- Two Residential RFPs available:
 - RFP for Prospective Homeowners for the JFK and NER Urban Renewal Project Area
 - RFP for Builders and Real Estate Developers for the JFK and NER Urban Renewal Project Areas

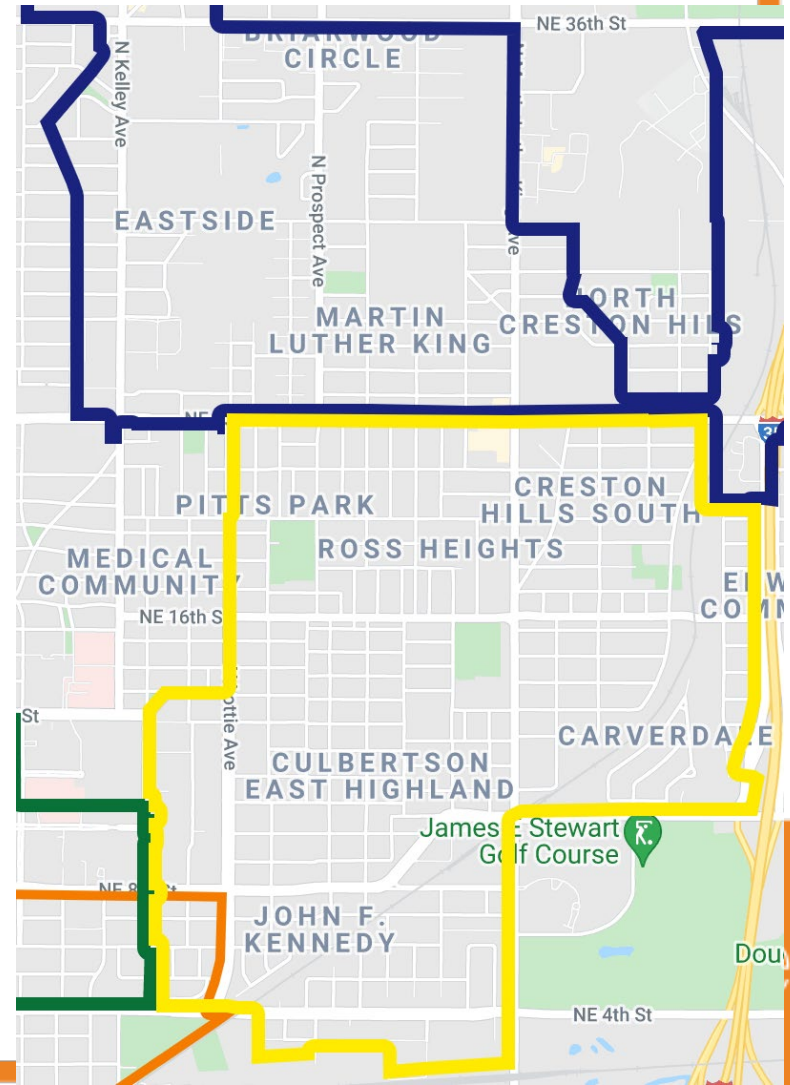

OCURA Residential Lots (NE OKC)

- Focus is to increase homeownership
- OCURA lots sell for \$0.60 per square foot
- The average lot size is around 50' x 100' or 7,500 sf
- Home designs must meet OCURA's Northeast Residential Design Standards
- Land inventory and current RFPs for individuals and developers are available at www.ocura-ok.org

Innovation District Land Use Plan

Lisa Chronister



Innovation District TIF Education Committee

Sharina Perry

The bottom of the slide features three horizontal bars of varying shades of blue. The top bar is a solid, medium-dark blue. Below it is a lighter, medium blue bar, and the bottom-most bar is the lightest shade of blue.

Convergence

Mark Beffort





ARPA Small Business Programs

Leana Dozier



Clara Luper Freedom Center

Christina Beatty

The bottom of the slide features three horizontal stripes of varying shades of blue. The top stripe is a medium blue, the middle stripe is a lighter blue, and the bottom stripe is a very light blue.

Oklahoma Black Living Legacy

James Johnson

The bottom of the slide features three horizontal stripes of varying shades of blue. The top stripe is a medium blue, the middle stripe is a lighter blue, and the bottom stripe is a very light blue.

Oak Street Clinic

Johnny Moore

The bottom of the page features three horizontal stripes of varying shades of blue. The top stripe is a dark blue, the middle stripe is a medium blue, and the bottom stripe is a light blue. These stripes span the entire width of the page.

Clara Community Health Center

Dr. Abdul Haaq





CCHC

Clara Community Health Center

2224 N. Kate Ave, Suite 100
Oklahoma City, OK 73111

404-254-8233

www.clarahealthcenter.org

MAPS 4 Overview

Councilwoman Nice

The bottom of the slide features three horizontal stripes of varying shades of blue. The top stripe is a solid, medium-dark blue. Below it is a lighter, medium blue stripe, and the bottom-most stripe is a very light, pale blue.

21CP Recommendations

Councilwoman Nice

