

## Concept Plan

# WILEY POST PARK I OKLAHOMA CITY, OK THE ASCENT

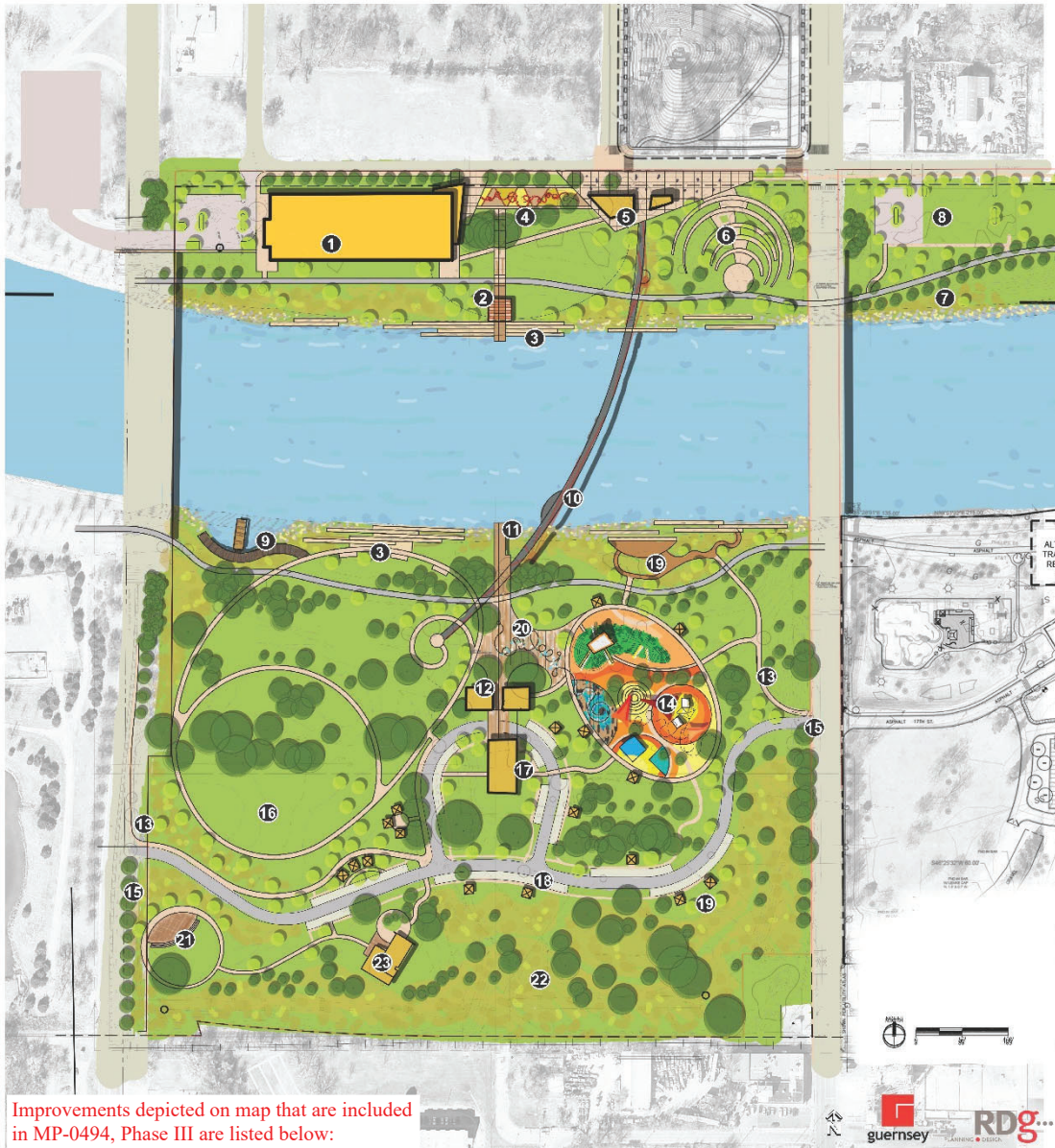

## Perspective Rendering



### Overall Concept Plan Estimate

The estimate reflects the opinion of probable cost based off of the 25% plans and concept development. Please refer to the detailed estimate in the H Appendix for the entire breakdown of North and South Wiley Post Park. Below is a summary of our projected cost:

North Wiley Post Park Improvements.....	\$28.35M - \$36.03M
South Wiley Post Park Improvements.....	\$31.34M - \$38.45M