

DIMENSIONS				REINFORCING STEEL								QUANTITIES	
CELL SPAN	CELL HEIGHT	UA	M	CS1 - #4		CS2 - #4		CS3 - #4		CT1 - #4 AT 12" MAX.		CONC. (C.Y.)	REINF. (LB.)
				NO.	LENGTH	NO.	LENGTH	NO.	LENGTH	NO.	LENGTH		
5'	3'	9"	4'-3"	26	5'-9"	26	6'-8"	4	5'-7"	8	25'-7"	3.9	370
5'	4'	10"	4'-4"	30	5'-9"	30	6'-9"	4	5'-8"	8	29'-1"	4.4	430
5'	5'	10"	4'-4"	34	5'-9"	34	6'-9"	4	5'-8"	8	32'-6"	4.9	480
6'	3'	9"	4'-3"	28	5'-9"	28	6'-8"	4	5'-7"	8	27'-7"	4.2	400
6'	4'	10"	4'-4"	32	5'-9"	32	6'-9"	4	5'-8"	8	31'-1"	4.7	450
6'	5'	10"	4'-4"	36	5'-9"	36	6'-9"	4	5'-8"	8	34'-6"	5.2	510
6'	6'	11"	4'-5"	38	5'-9"	38	6'-10"	4	5'-9"	8	38'-0"	5.7	540
7'	3'	9"	4'-3"	30	5'-9"	30	6'-8"	4	5'-7"	8	29'-7"	4.5	430
7'	4'	10"	4'-4"	34	5'-9"	34	6'-9"	4	5'-8"	8	33'-1"	5.0	480
7'	5'	10"	4'-4"	38	5'-9"	38	6'-9"	4	5'-8"	8	36'-6"	5.5	530
7'	6'	11"	4'-5"	40	5'-9"	40	6'-10"	4	5'-9"	8	40'-0"	6.0	570
7'	7'	11"	4'-5"	44	5'-9"	44	6'-10"	4	5'-9"	8	43'-5"	6.5	620
8'	3'	9"	4'-3"	32	5'-9"	32	6'-8"	4	5'-7"	8	31'-7"	4.8	450
8'	4'	10"	4'-4"	36	5'-9"	36	6'-9"	4	5'-8"	8	35'-1"	5.3	510
8'	5'	10"	4'-4"	40	5'-9"	40	6'-9"	4	5'-8"	8	38'-6"	5.8	560
8'	6'	11"	4'-5"	42	5'-9"	42	6'-10"	4	5'-9"	8	42'-0"	6.3	600
8'	7'	11"	4'-5"	46	5'-9"	46	6'-10"	4	5'-9"	8	45'-5"	6.8	650
8'	8'	12"	4'-6"	50	5'-9"	50	6'-11"	4	5'-10"	8	49'-1"	7.4	710
9'	3'	9"	4'-3"	34	5'-9"	34	6'-8"	4	5'-7"	8	33'-7"	5.1	480
9'	4'	10"	4'-4"	38	5'-9"	38	6'-9"	4	5'-8"	8	37'-1"	5.6	540
9'	5'	10"	4'-4"	42	5'-9"	42	6'-9"	4	5'-8"	8	40'-6"	6.1	590
9'	6'	11"	4'-5"	44	5'-9"	44	6'-10"	4	5'-9"	8	44'-0"	6.6	630
9'	7'	11"	4'-5"	48	5'-9"	48	6'-10"	4	5'-9"	8	47'-5"	7.1	680
9'	8'	12"	4'-6"	52	5'-9"	52	6'-11"	4	5'-10"	8	51'-1"	7.7	730
9'	9'	13"	4'-7"	56	5'-9"	56	7'-0"	4	5'-11"	8	54'-7"	8.2	790
10'	3'	9"	4'-3"	36	5'-9"	36	6'-8"	4	5'-7"	8	35'-7"	5.4	510
10'	4'	10"	4'-4"	40	5'-9"	40	6'-9"	4	5'-8"	8	39'-1"	5.9	560
10'	5'	10"	4'-4"	44	5'-9"	44	6'-9"	4	5'-8"	8	42'-6"	6.4	610
10'	6'	11"	4'-5"	46	5'-9"	46	6'-10"	4	5'-9"	8	46'-0"	6.9	650
10'	7'	11"	4'-5"	50	5'-9"	50	6'-10"	4	5'-9"	8	49'-8"	7.5	710
10'	8'	12"	4'-6"	54	5'-9"	54	6'-11"	4	5'-10"	8	53'-1"	8.0	760
10'	9'	13"	4'-7"	58	5'-9"	58	7'-0"	4	5'-11"	8	56'-7"	8.5	820
10'	10'	13"	4'-7"	60	5'-9"	60	7'-0"	4	5'-11"	8	62'-10"	9.0	870
11'	3'	9"	4'-3"	38	5'-9"	38	6'-8"	4	5'-7"	8	37'-7"	5.7	540
11'	4'	10"	4'-4"	42	5'-9"	42	6'-9"	4	5'-8"	8	41'-1"	6.2	590
11'	5'	10"	4'-4"	46	5'-9"	46	6'-9"	4	5'-8"	8	44'-6"	6.7	640
11'	6'	11"	4'-5"	48	5'-9"	48	6'-10"	4	5'-9"	8	48'-3"	7.2	680
11'	7'	11"	4'-5"	52	5'-9"	52	6'-10"	4	5'-9"	8	51'-8"	7.8	730
11'	8'	12"	4'-6"	56	5'-9"	56	6'-11"	4	5'-10"	8	55'-1"	8.3	790
11'	9'	13"	4'-7"	60	5'-9"	60	7'-0"	4	5'-11"	8	58'-7"	8.8	840
11'	10'	13"	4'-7"	62	5'-9"	62	7'-0"	4	5'-11"	8	64'-10"	9.3	900
11'	11'	14"	4'-8"	66	5'-9"	66	7'-1"	4	6'-0"	8	68'-4"	9.9	950
12'	5'	10"	4'-4"	48	5'-9"	48	6'-9"	4	5'-8"	8	46'-9"	7.0	670
12'	6'	11"	4'-5"	50	5'-9"	50	6'-10"	4	5'-9"	8	50'-3"	7.5	710
12'	7'	11"	4'-5"	54	5'-9"	54	6'-10"	4	5'-9"	8	53'-8"	8.0	760
12'	8'	12"	4'-6"	58	5'-9"	58	6'-11"	4	5'-10"	8	57'-4"	8.6	820
12'	9'	13"	4'-7"	62	5'-9"	62	7'-0"	4	5'-11"	8	63'-4"	9.1	890
12'	10'	13"	4'-7"	64	5'-9"	64	7'-0"	4	5'-11"	8	66'-10"	9.6	920
12'	11'	14"	4'-8"	68	5'-9"	68	7'-1"	4	6'-0"	8	70'-4"	10.1	980
12'	12'	14"	4'-8"	72	5'-9"	72	7'-1"	4	6'-0"	8	73'-9"	10.7	1,030

① LENGTH INCLUDES 2'-6" LAP

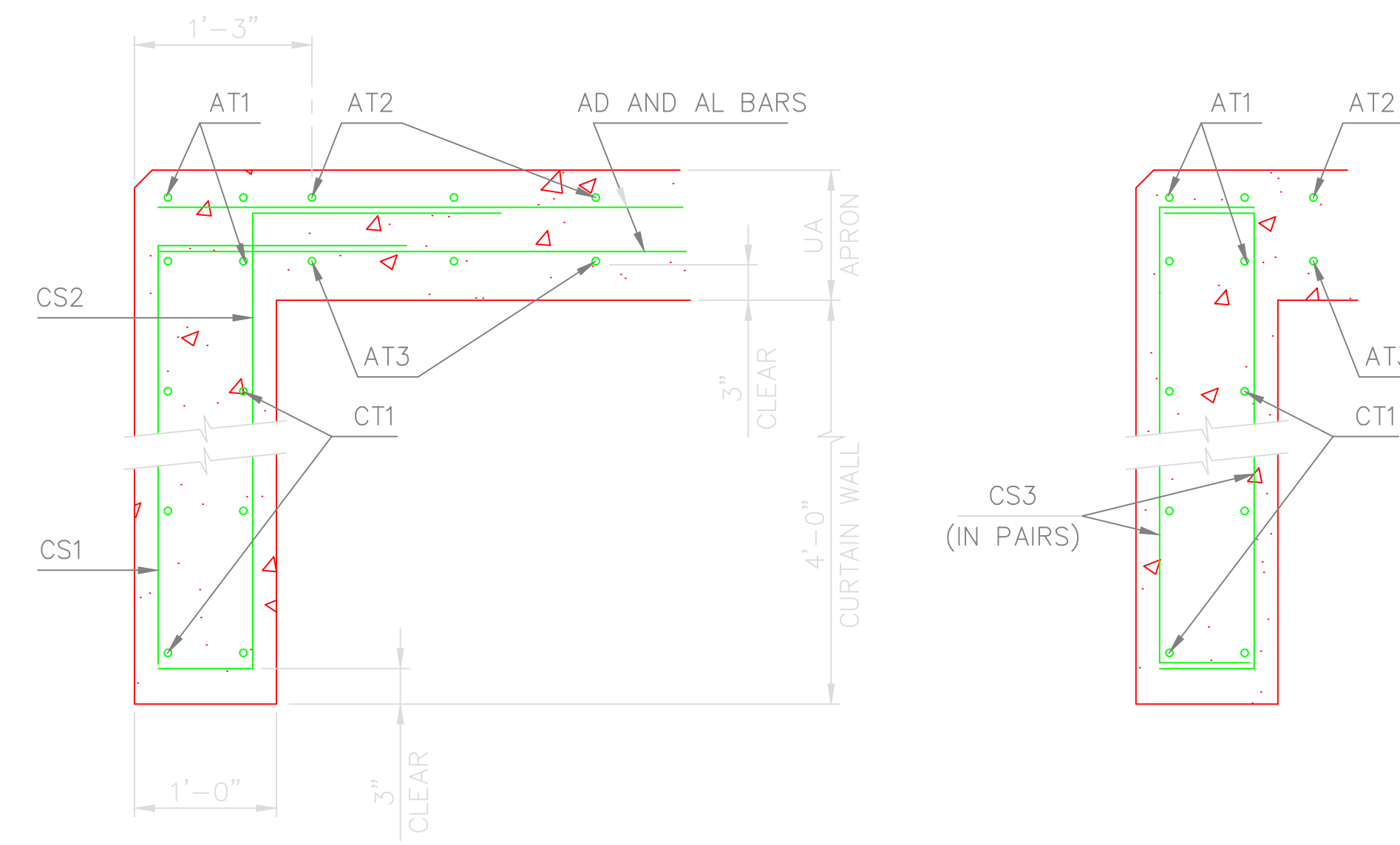

TYPICAL SECTION THRU CURTAIN WALL

TYPICAL SECTION THRU END OF CURTAIN WALL

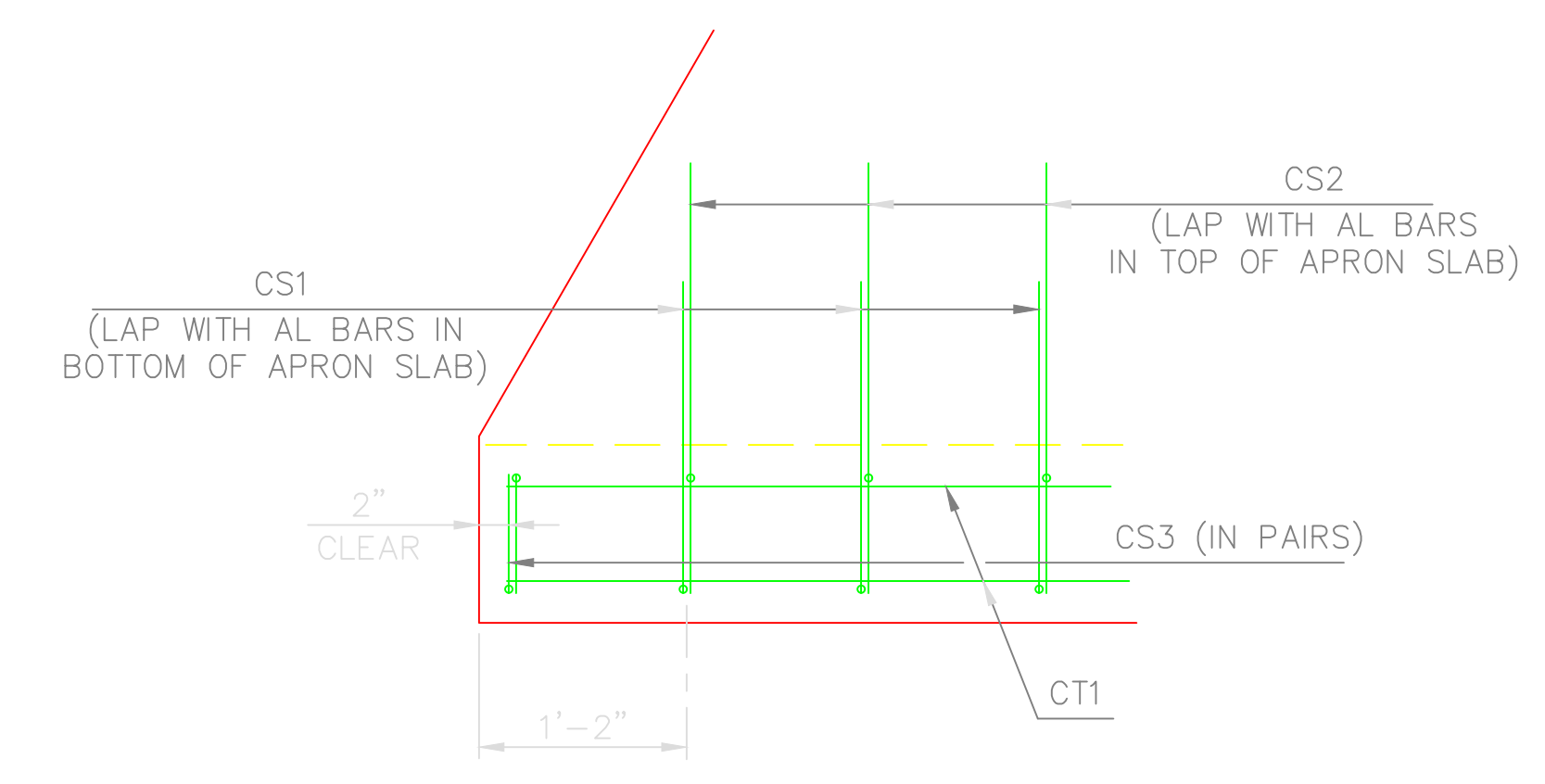

CURTAIN WALL / APRON PLAN

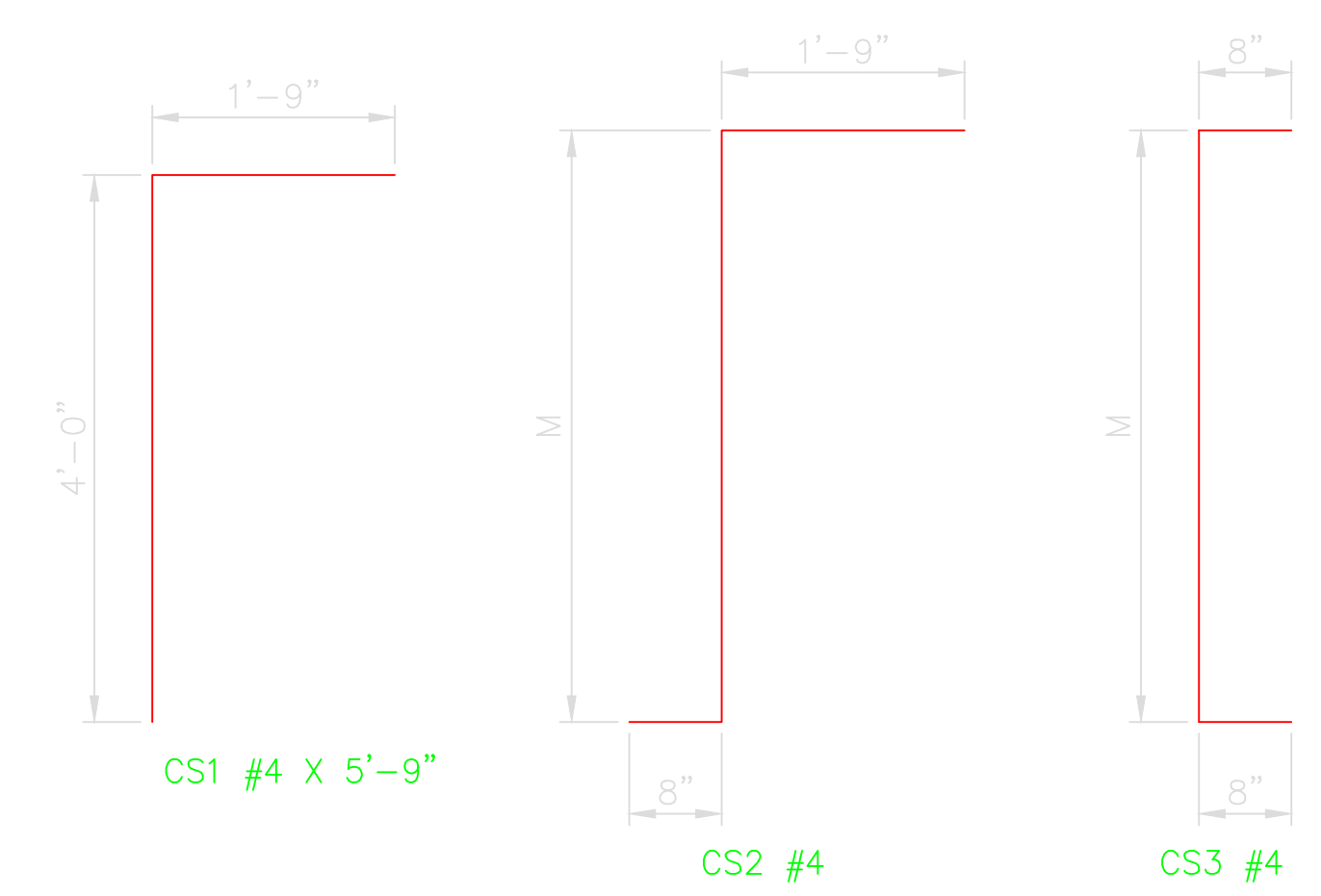

REVISION NO.
DATE

The City of Oklahoma City
Public Works Department
Engineering Division

APPROVED BY: DATE: 6/21/2023
ERIC J. WENGER, P.E.
CITY ENGINEER

THESE STANDARD DRAWINGS AND ASSOCIATED CALCULATIONS HAVE BEEN PREPARED BY CEC CORPORATION UNDER CONTRACT WITH THE CITY OF OKLAHOMA CITY.

R.C.B. CULVERTS - CURTAIN WALL DETAILS
DOUBLE CELL - 4'-0" DEPTH - 0' SKEW

Drawing Number
RCB-061