

DIMENSIONS				REINFORCING STEEL								QUANTITIES	
CELL SPAN	CELL HEIGHT	UA	M	CS1 - #5		CS2 - #5		CS3 - #5		CT1 - #4 AT 12" MAX.		CONC. (C.Y.)	REINF. (LB.)
				NO.	LENGTH	NO.	LENGTH	NO.	LENGTH	NO.	LENGTH		
5'	3'	9"	5'-3"	26	6'-9"	26	7'-8"	4	6'-7"	10	25'-7"	4.8	590
5'	4'	10"	5'-4"	30	6'-9"	30	7'-9"	4	6'-8"	10	29'-1"	5.5	680
5'	5'	10"	5'-4"	34	6'-9"	34	7'-9"	4	6'-8"	10	32'-6"	6.1	760
6'	3'	9"	5'-3"	28	6'-9"	28	7'-8"	4	6'-7"	10	27'-7"	5.2	640
6'	4'	10"	5'-4"	32	6'-9"	32	7'-9"	4	6'-8"	10	31'-1"	5.9	720
6'	5'	10"	5'-4"	36	6'-9"	36	7'-9"	4	6'-8"	10	34'-6"	6.5	810
6'	6'	11"	5'-5"	38	6'-9"	38	7'-10"	4	6'-9"	10	38'-0"	7.1	860
7'	3'	9"	5'-3"	30	6'-9"	30	7'-8"	4	6'-7"	10	29'-7"	5.6	680
7'	4'	10"	5'-4"	34	6'-9"	34	7'-9"	4	6'-8"	10	33'-1"	6.2	770
7'	5'	10"	5'-4"	38	6'-9"	38	7'-9"	4	6'-8"	10	36'-6"	6.9	850
7'	6'	11"	5'-5"	40	6'-9"	40	7'-10"	4	6'-9"	10	40'-0"	7.5	910
7'	7'	11"	5'-5"	44	6'-9"	44	7'-10"	4	6'-9"	10	43'-5"	8.2	990
8'	3'	9"	5'-3"	32	6'-9"	32	7'-8"	4	6'-7"	10	31'-7"	6.0	720
8'	4'	10"	5'-4"	36	6'-9"	36	7'-9"	4	6'-8"	10	35'-1"	6.6	810
8'	5'	10"	5'-4"	40	6'-9"	40	7'-9"	4	6'-8"	10	38'-6"	7.2	890
8'	6'	11"	5'-5"	42	6'-9"	42	7'-10"	4	6'-9"	10	42'-0"	7.9	950
8'	7'	11"	5'-5"	46	6'-9"	46	7'-10"	4	6'-9"	10	45'-5"	8.5	1,040
8'	8'	12"	5'-6"	50	6'-9"	50	7'-11"	4	6'-10"	10	49'-1"	9.2	1,130
9'	3'	9"	5'-3"	34	6'-9"	34	7'-8"	4	6'-7"	10	33'-7"	6.3	770
9'	4'	10"	5'-4"	38	6'-9"	38	7'-9"	4	6'-8"	10	37'-1"	7.0	860
9'	5'	10"	5'-4"	42	6'-9"	42	7'-9"	4	6'-8"	10	40'-6"	7.6	940
9'	6'	11"	5'-5"	44	6'-9"	44	7'-10"	4	6'-9"	10	44'-0"	8.3	1,000
9'	7'	11"	5'-5"	48	6'-9"	48	7'-10"	4	6'-9"	10	47'-5"	8.9	1,080
9'	8'	12"	5'-6"	52	6'-9"	52	7'-11"	4	6'-10"	10	51'-1"	9.6	1,170
9'	9'	13"	5'-7"	56	6'-9"	56	8'-0"	4	6'-11"	10	54'-7"	10.2	1,260
10'	3'	9"	5'-3"	36	6'-9"	36	7'-8"	4	6'-7"	10	35'-7"	6.7	810
10'	4'	10"	5'-4"	40	6'-9"	40	7'-9"	4	6'-8"	10	39'-1"	7.3	900
10'	5'	10"	5'-4"	44	6'-9"	44	7'-9"	4	6'-8"	10	42'-6"	8.0	980
10'	6'	11"	5'-5"	46	6'-9"	46	7'-10"	4	6'-9"	10	46'-0"	8.6	1,040
10'	7'	11"	5'-5"	50	6'-9"	50	7'-10"	4	6'-9"	10	49'-8"	9.3	1,130
10'	8'	12"	5'-6"	54	6'-9"	54	7'-11"	4	6'-10"	10	53'-1"	9.9	1,210
10'	9'	13"	5'-7"	58	6'-9"	58	8'-0"	4	6'-11"	10	56'-7"	10.6	1,300
10'	10'	13"	5'-7"	60	6'-9"	60	8'-0"	4	6'-11"	10	62'-10"	11.3	1,380
11'	3'	9"	5'-3"	38	6'-9"	38	7'-8"	4	6'-7"	10	37'-7"	7.1	850
11'	4'	10"	5'-4"	42	6'-9"	42	7'-9"	4	6'-8"	10	41'-1"	7.7	940
11'	5'	10"	5'-4"	46	6'-9"	46	7'-9"	4	6'-8"	10	44'-6"	8.4	1,030
11'	6'	11"	5'-5"	48	6'-9"	48	7'-10"	4	6'-9"	10	48'-3"	9.0	1,090
11'	7'	11"	5'-5"	52	6'-9"	52	7'-10"	4	6'-9"	10	51'-8"	9.7	1,170
11'	8'	12"	5'-6"	56	6'-9"	56	7'-11"	4	6'-10"	10	55'-1"	10.3	1,260
11'	9'	13"	5'-7"	60	6'-9"	60	8'-0"	4	6'-11"	10	58'-7"	11.0	1,350
11'	10'	13"	5'-7"	62	6'-9"	62	8'-0"	4	6'-11"	10	64'-10"	11.7	1,420
11'	11'	14"	5'-8"	66	6'-9"	66	8'-1"	4	7'-0"	10	68'-4"	12.3	1,510
12'	5'	10"	5'-4"	48	6'-9"	48	7'-9"	4	6'-8"	10	46'-9"	8.8	1,070
12'	6'	11"	5'-5"	50	6'-9"	50	7'-10"	4	6'-9"	10	50'-3"	9.4	1,130
12'	7'	11"	5'-5"	54	6'-9"	54	7'-10"	4	6'-9"	10	53'-8"	10.0	1,210
12'	8'	12"	5'-6"	58	6'-9"	58	7'-11"	4	6'-10"	10	57'-4"	10.7	1,300
12'	9'	13"	5'-7"	62	6'-9"	62	8'-0"	4	6'-11"	10	63'-4"	11.4	1,410
12'	10'	13"	5'-7"	64	6'-9"	64	8'-0"	4	6'-11"	10	66'-10"	12.0	1,460
12'	11'	14"	5'-8"	68	6'-9"	68	8'-1"	4	7'-0"	10	70'-4"	12.7	1,560
12'	12'	14"	5'-8"	72	6'-9"	72	8'-1"	4	7'-0"	10	73'-9"	13.3	1,640

① LENGTH INCLUDES 2'-6" LAP

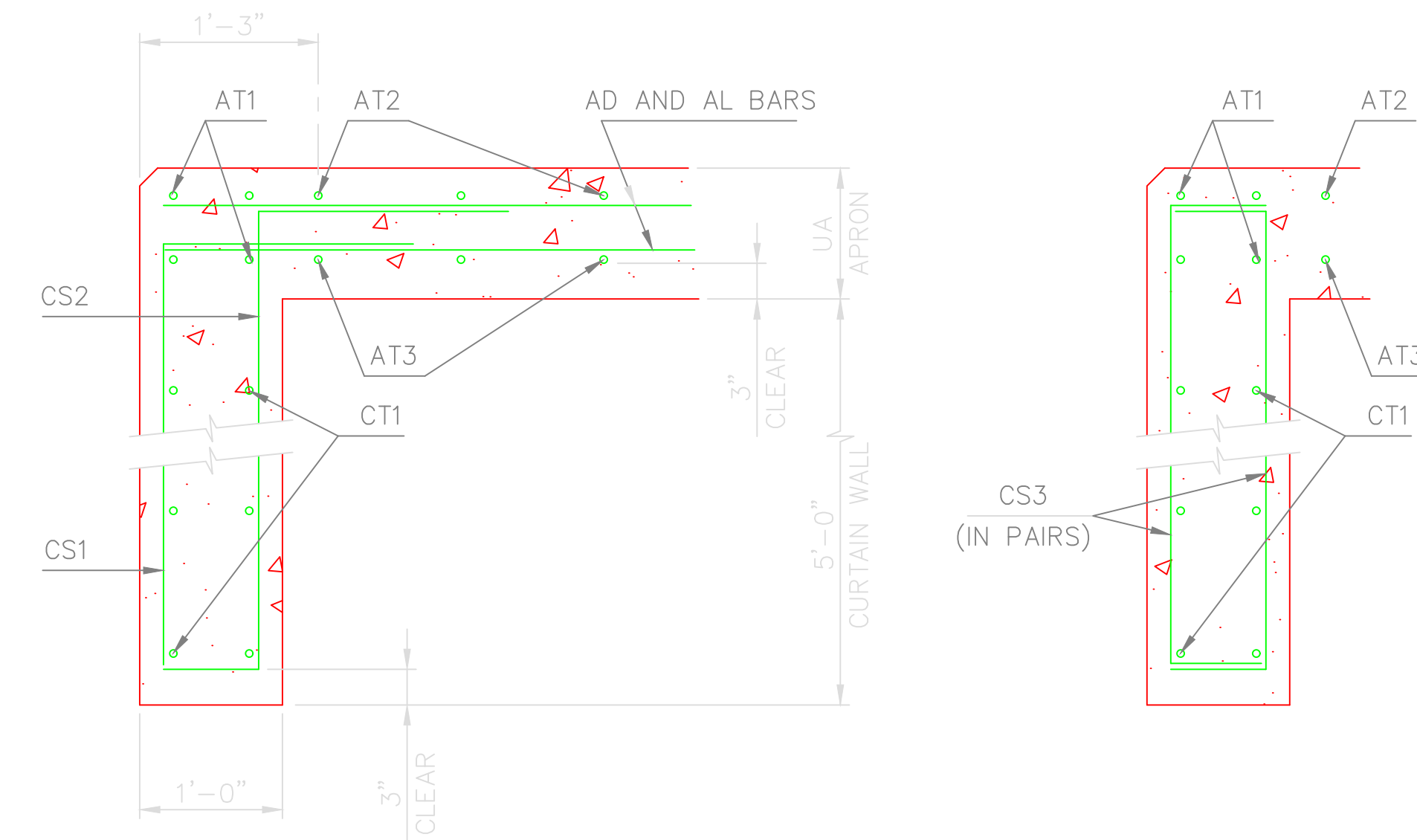

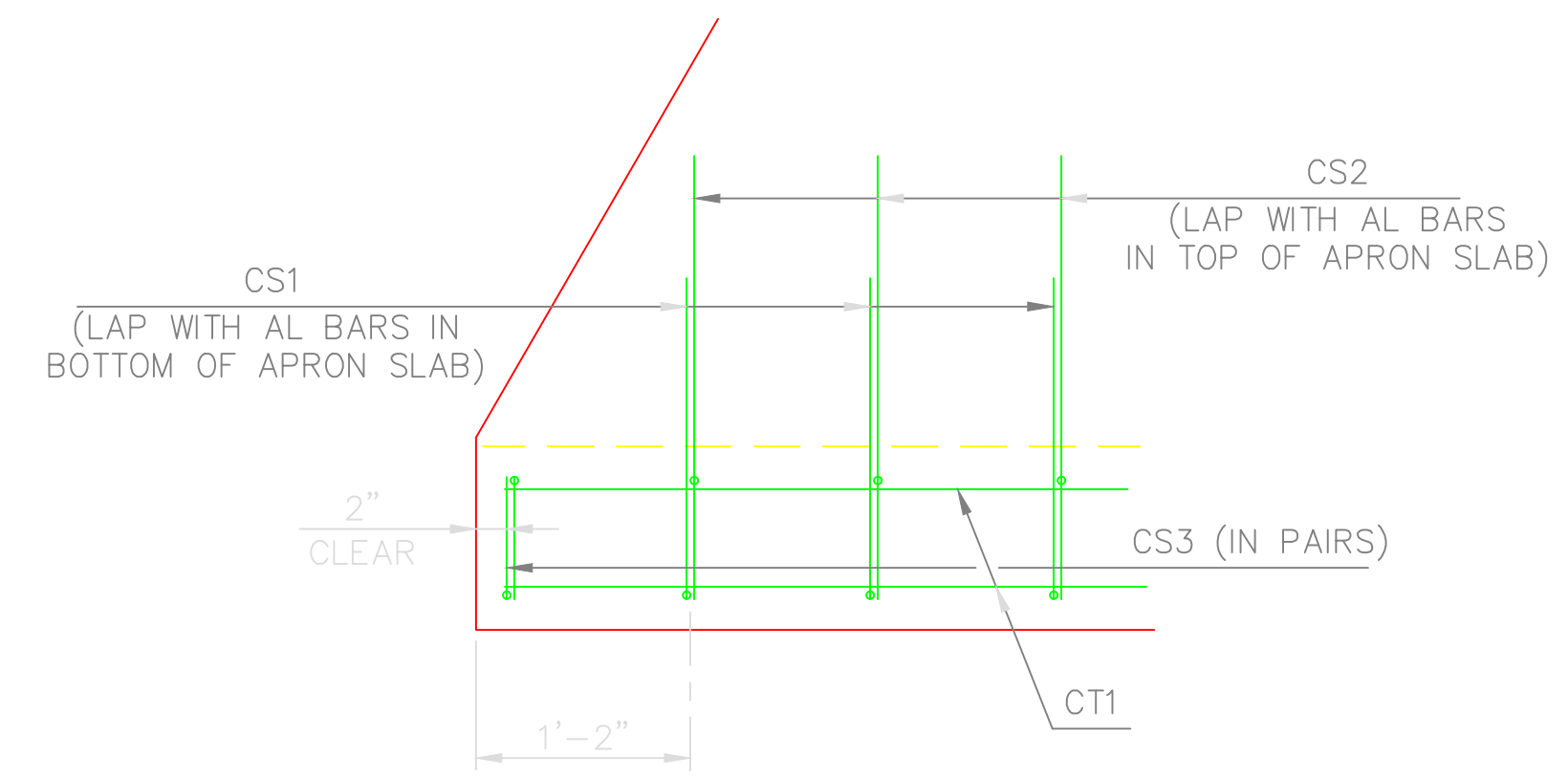

TYPICAL SECTION THRU CURTAIN WALL

TYPICAL SECTION THRU END OF CURTAIN WALL

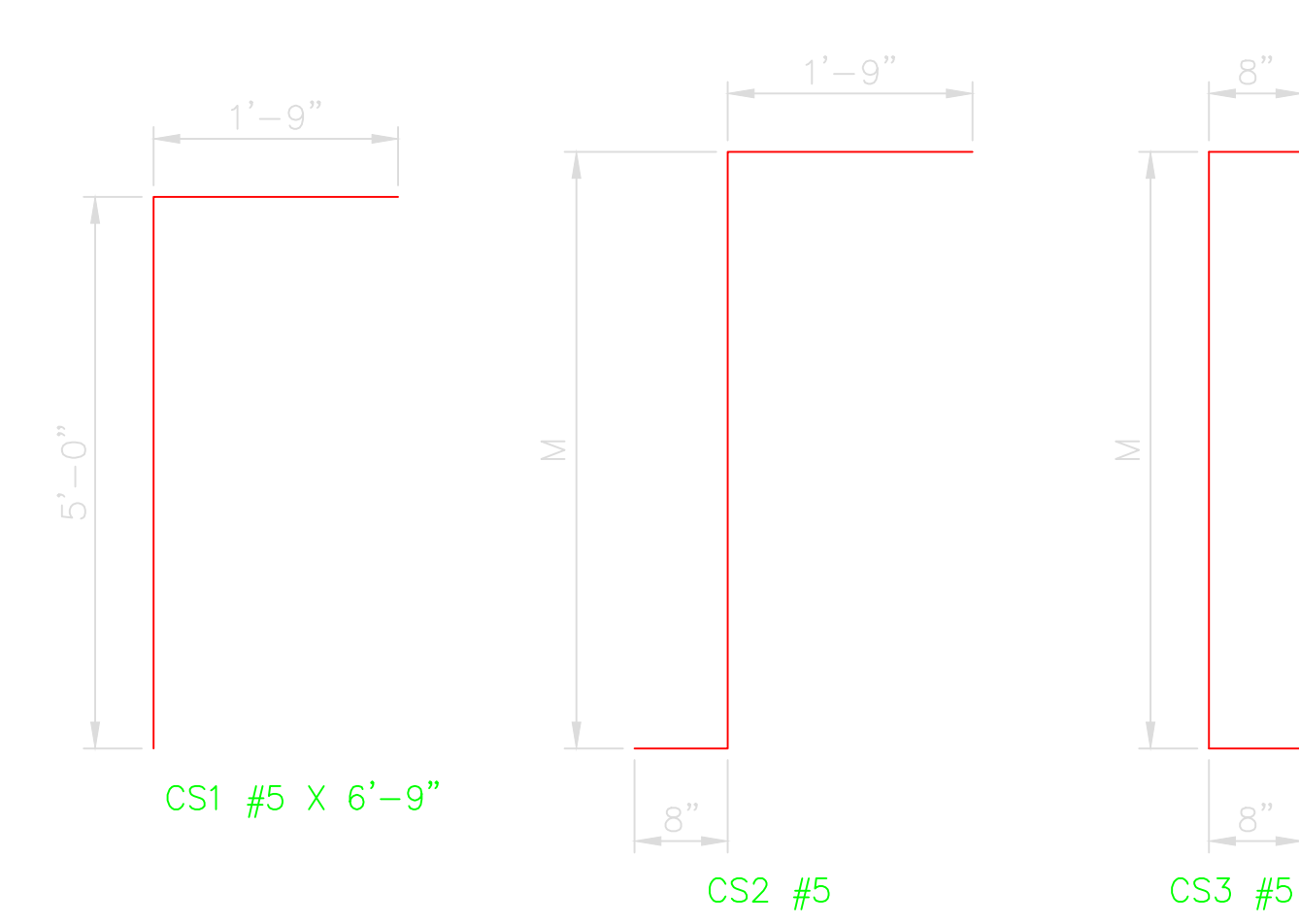

CURTAIN WALL / APRON PLAN



APPROVED BY:  DATE: 6/21/2023  
 ERIC J. WENGER, P.E.  
 CITY ENGINEER

THESE STANDARD DRAWINGS AND ASSOCIATED CALCULATIONS HAVE BEEN PREPARED BY CEC CORPORATION UNDER CONTRACT WITH THE CITY OF OKLAHOMA CITY.

R.C.B. CULVERTS - CURTAIN WALL DETAILS  
 DOUBLE CELL - 5'-0" DEPTH - 0° SKEW

REVISION NO.
DATE

Drawing Number  
RCB-062

The City of  
**Oklahoma City**  
 Public Works Department  
 Engineering Division

