

DEEP FORK MAP SA

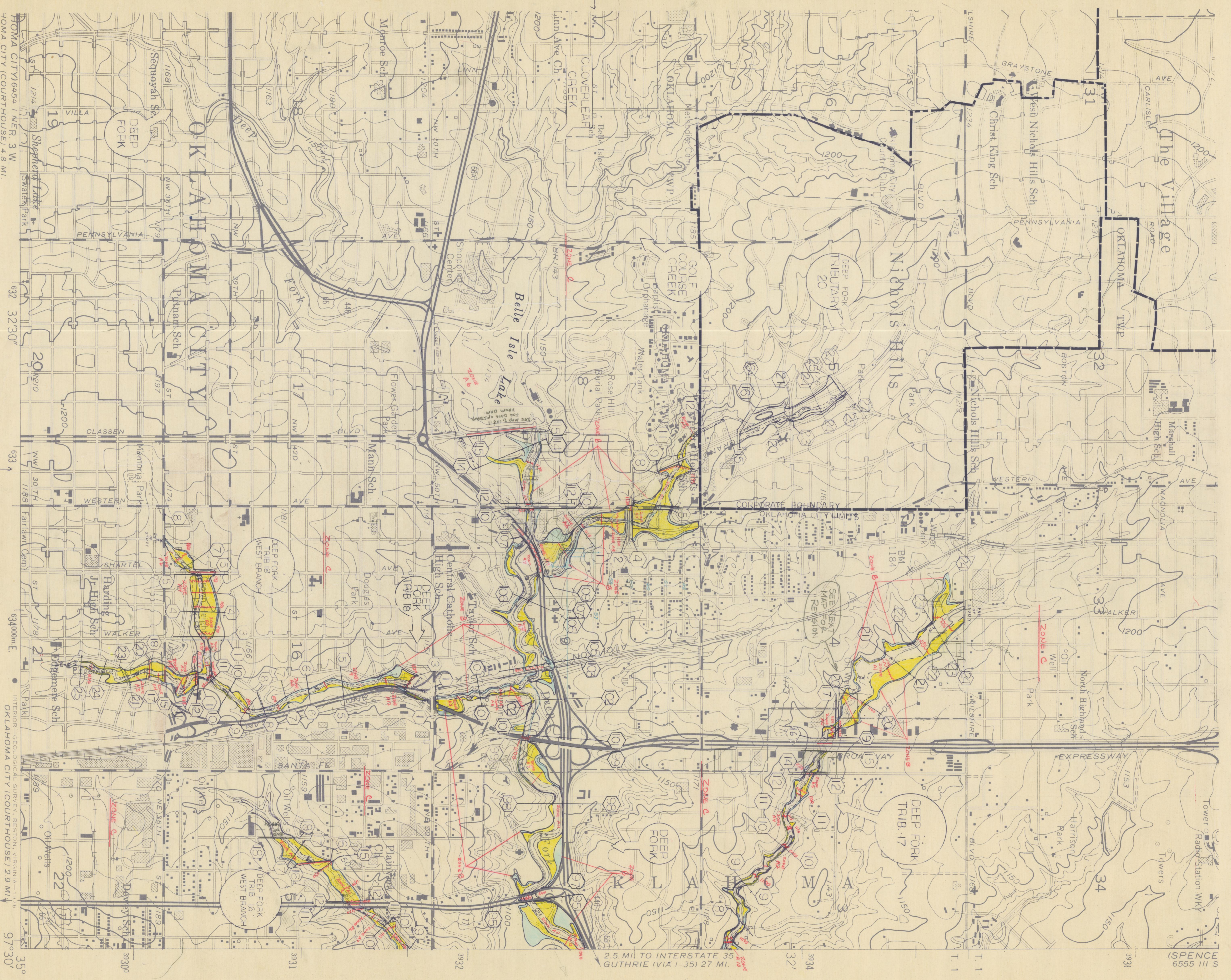

HOMA CITY 6454 1 NER 3 W
HOMA CITY (COURTHOUSE) 4.8 MI.

632 32°30'

633

634 00m E

INTERIOR - GEOLOGICAL SURVEY, RESTON, VIRGINIA 1976
OKLAHOMA CITY (COURTHOUSE) 2.9 MI.

35° 97°30'

THIS SEGMENT DETAILED ON DEEP FORK MAP NO. 58
WITH SCALE ENLARGED TO 1-INCH = 400 FEET

SCALE: 1-INCH = 800- FEET

DEEP FORK MAP NO. 8

2.5 MI. TO INTERSTATE 35
GUTHRIE (VIA I-35) 27 MI.

SPENCE
6555 III