

Published in The Journal Record on August 7, 2024.

NOTICE OF HEARING

El presente aviso trata sobre una propuesta de cierre de servidumbre cerca de su propiedad. La agenda a tratar y el informe del personal se publicarán en el siguiente enlace: <https://okc.primegov.com/public/portal> . Llame al (405) 297-3533 si requiere información adicional.

CASE NUMBER: CE-1127

DATE OF HEARING: August 22, 2024

LEGAL DESCRIPTION: A tract of land being a part of Lot 1 of Block 2, SUMMIT RIDGE SECTION ONE recorded in Book 50 of Plats, Page 56, and a part of Lot 5 of Block 2, SUMMIT RIDGE SECTION THREE recorded in Book 51 of Plats, Page 98, all in the Southwest Quarter (SW/4) of Section Twenty-two (22), Township Thirteen (13) North, Range Three (3) West of the Indian Meridian, Oklahoma County, Oklahoma, being more particularly described as follows: BEGINNING at the southwest corner of said Lot 1; THENCE South 38°22'39" West, along and with the southeast line of said Lot 5, a distance of 24.43 feet; THENCE North 00°29'43" East (North 00°24'05" East – Record), 15 feet west of and parallel with the common line between said Lots 5 and 1, a distance of 138.42 feet; THENCE North 40°27'46" East, across said Lots 5 & 1, a distance of 46.70 feet; THENCE South 00°29'43" West (South 00°24'05" West – Record), 15 feet east of and parallel with the common line between said Lots 5 and 1, a distance of 139.06 feet to a point on the south line of said Lot 1; THENCE southwesterly along the south line of said Lot 1 on a curve to the left having a radius of 203.64 feet (180.00 feet – Record), a chord bearing of South 43°51'58" West, a chord distance of 21.84 feet and an arc length of 21.85 feet to the POINT OF BEGINNING.

NOTICE IS HEREBY GIVEN that **Summit Ridge Land, LLC** has filed an application with the Oklahoma City Planning Department to close the easement(s) indicated on the reverse side of this notice.

Your property is not included within the area proposed to be closed. This notice is being provided to you because you own property nearby.

- You are not required to attend the hearing, but if you wish to you may. You may also have someone appear on your behalf.

The Planning Commission will hold a public hearing on the date shown above. Brief written materials, graphics, maps, pictures, etc. may be presented to the Commission to illustrate a point regarding a case. Materials in support or opposition of a pending application should be submitted to City staff at the email or mailing address below by **noon on Friday August 16, 2024**, to be copied and delivered to the Commission members.

Following the hearing, the Planning Commission forwards its recommendations to the City Council where an ordinance to close the easement(s) is scheduled for a final public hearing. You will receive notice by mail of the final Council hearing from the City Clerk.

LOCATION OF PUBLIC HEARING

A PUBLIC HEARING will be held by the Oklahoma City Planning Commission at 1:30 p.m. on Thursday, August 22, 2024, in the Council Chamber, Third Floor, Municipal Building, 200 North Walker Avenue, Oklahoma City, Oklahoma.

The agenda and staff report for this meeting will be posted at following link:

<https://okc.primegov.com/public/portal>

Please conduct your business with us by phone or email.

City of Oklahoma City Planning Department

420 West Main Street, Suite 910, Oklahoma City, Oklahoma 73102 - Ph: (405) 297-2623 - Email: subdivisionandzoning@okc.gov

Case No: CE-1127

Applicant: Summit Ridge Land, LLC

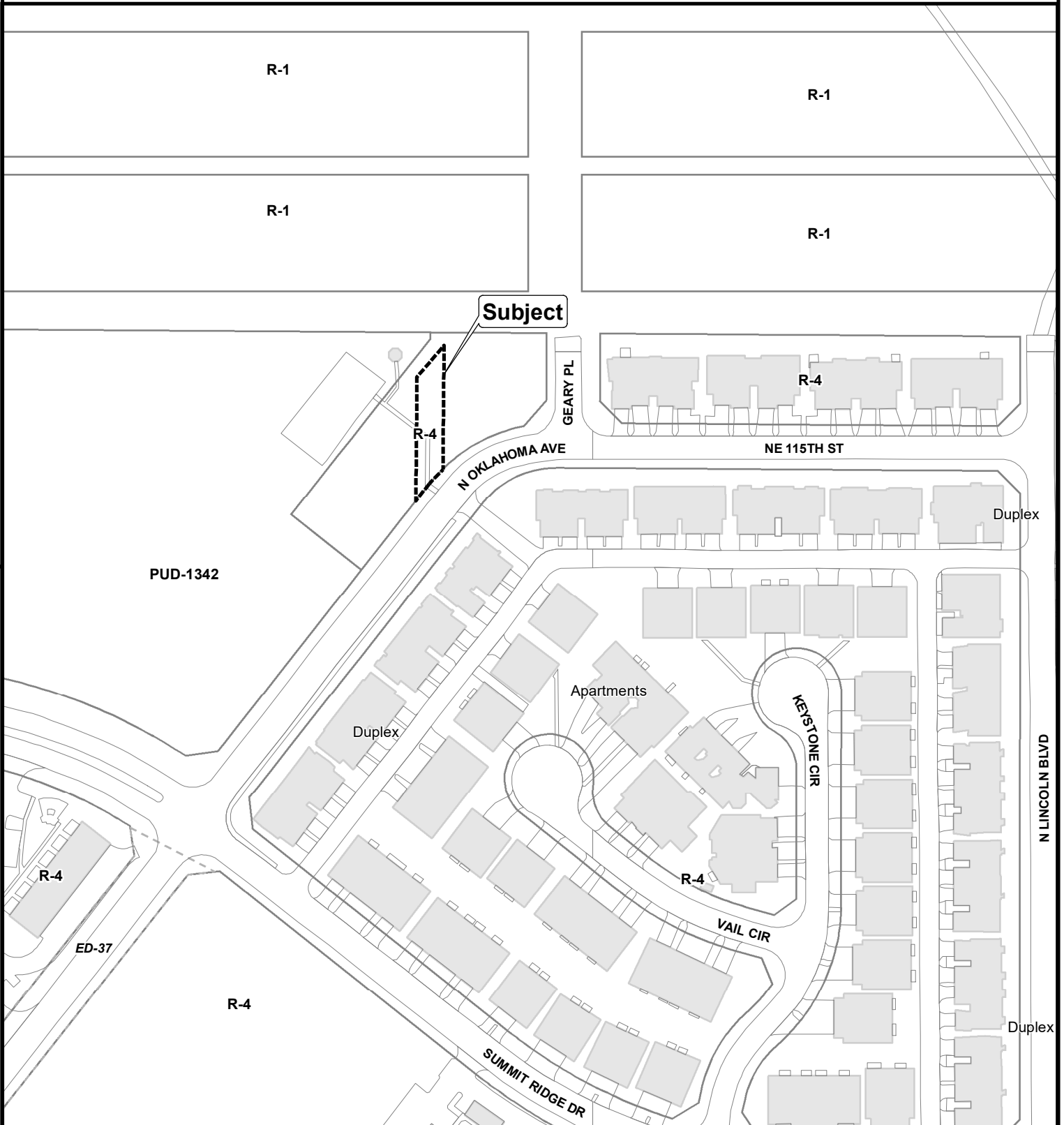

Note: "Subject" is located approximately 1,811' East of N. Santa Fe Ave. and 2,465' North of E. Hefner Rd.



The City of
OKLAHOMA CITY

Application for Closing Public Way or Easement

