

Fiestas De Las Americas 2024- Traffic Control Plan

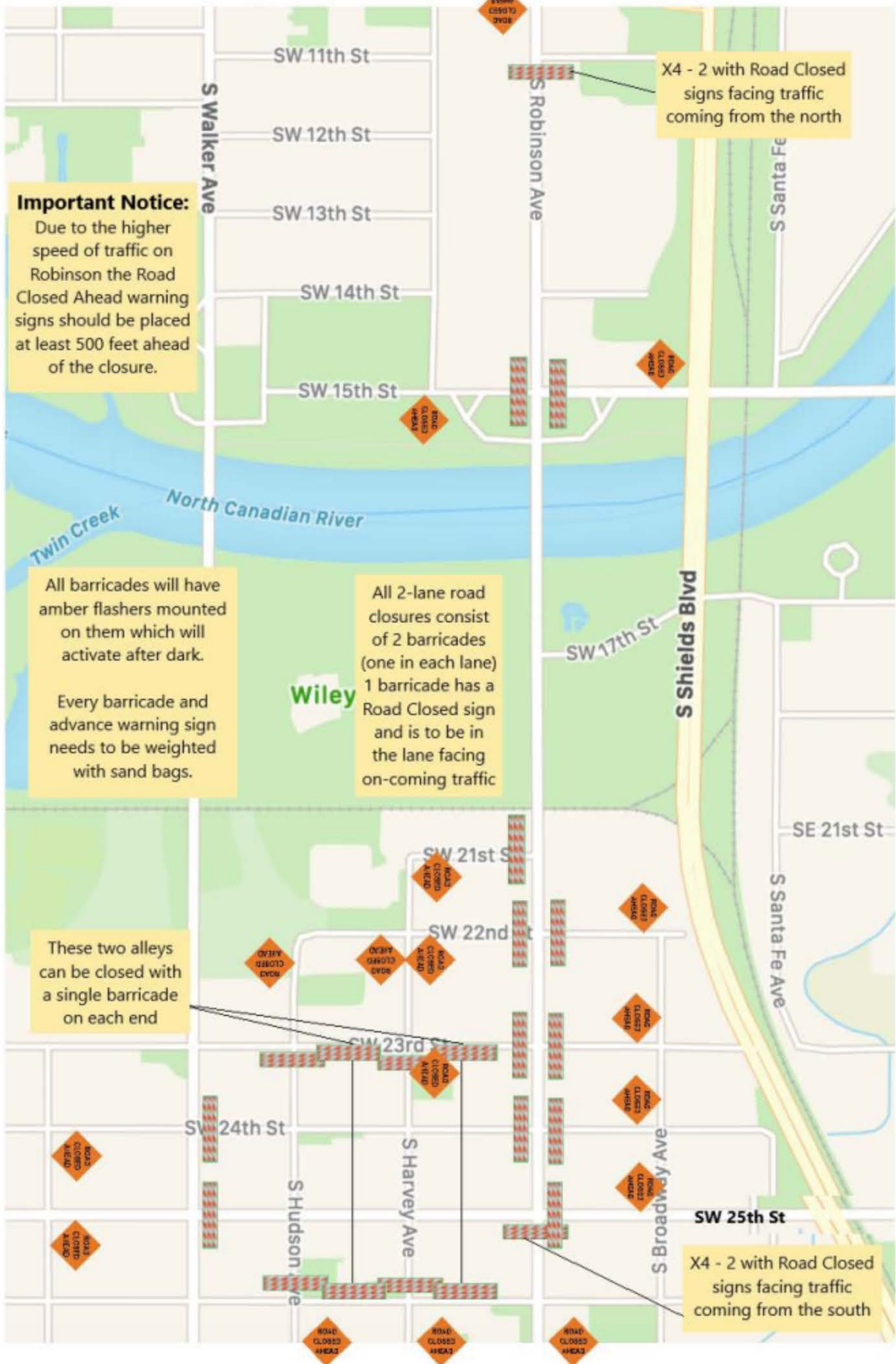

Important Notice:
 Due to the higher speed of traffic on Robinson the Road Closed Ahead warning signs should be placed at least 500 feet ahead of the closure.

All barricades will have amber flashers mounted on them which will activate after dark.
 Every barricade and advance warning sign needs to be weighted with sand bags.





All 2-lane road closures consist of 2 barricades (one in each lane) 1 barricade has a Road Closed sign and is to be in the lane facing on-coming traffic

These two alleys can be closed with a single barricade on each end

X4 - 2 with Road Closed signs facing traffic coming from the north

X4 - 2 with Road Closed signs facing traffic coming from the south

Event Site Legend

-  Music Stage / Entertainment
-  Vendor Booth Areas
-  Event Roadway and Lane Closure Limits
-  Road Closure Points Type III Barricades

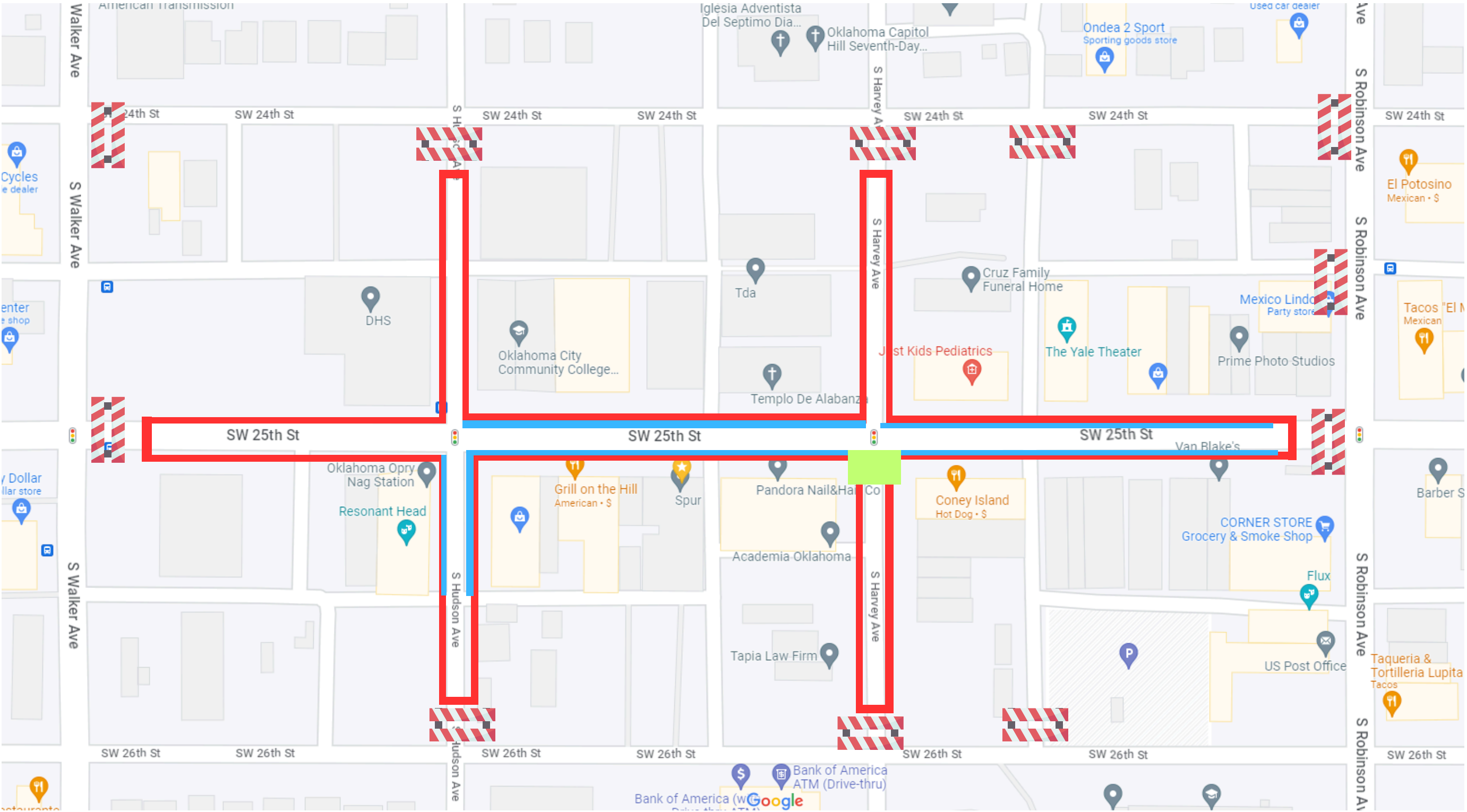

Fiestas De Las Americas Event Site Map 2024

