

Case No: SP-591

Applicant: Foxhorn, LLC

Address: 5719 SW 134th St. Present Zoning: I-2 / AA / AE-2

Proposed Use: (8450.1) Mining and Processing: Minerals and Raw Materials

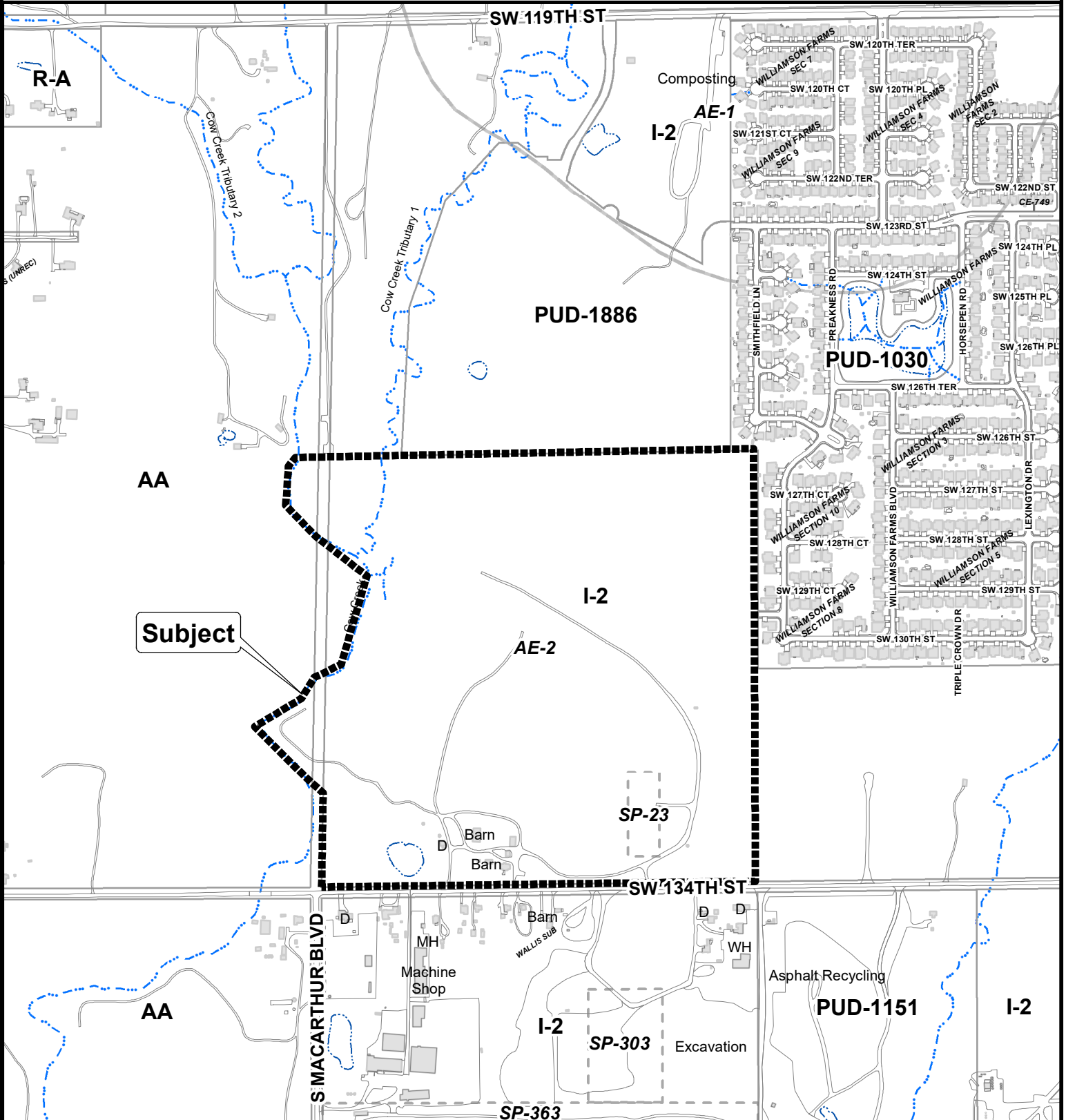

The City of
OKLAHOMA CITY

Special Permit Application



0 400 800
Feet

Exhibit A Program Description

Project Summary

The Applicant seeks to operate a non-coal mining operation on the property at issue (“Property”). The proposed operation will involve the excavation of sand, gravel, and clay through surface mining methods, e.g., stripping, dredging, pumping, and quarrying. The physical layout of the operation is depicted in the Site Plan submitted along with this Application.

The Property is zoned I-2. Surrounding properties are zoned as follows:

North: I-2
South: I-2
East: I-2
West: AA

The Property is currently undeveloped and is likewise surrounded by primarily undeveloped parcels.

Mining & Reclamation

Applicant seeks to mine an area of approximately 140 acres for the excavation of sand and dirt based on the market demands for the materials mined and the applicant’s desires. Applicant will use construction equipment, “haul” roads, and stockpiles to facilitate the mining/reclamation operations. Applicant anticipates the materials to be mined to the maximum depth of 50 feet below the existing surface.

Prior to mining, topsoil will be removed after vegetative cover that could interfere with the use of the topsoil is cleared from the area to be disturbed. The topsoil will be stored in the stockpile area to be sold or redistributed over the surface at the completion of the mining operation. Topsoil stockpiles will be seeded with quick-growing annual and perennial grass seeds. Topsoil stockpiles will be mulched when necessary to provide a quick protective cover or aid in germination of plant and seeds.

Upon completion of the mining operation, all available topsoil will be redistributed and seeded on the disturbed area where possible.

Blasting will not be conducted for the proposed operation.

Revegetation

After topsoil has been redistributed, leveled, and smoothed, soil samples will be collected and analyzed from those areas that could be re-vegetated to determine the nutrient and lime deficiencies. Any deficiencies will be corrected, according to the Natural Resources Conservation Service’s recommendations based on the results of the analysis before permanent seeding takes place.

Other than customary soil preparation and nutrient and lime application, no other soil remediation will be performed for re-vegetation. Irrigation and pest/disease control measures are not anticipated at this time.

After fertilizing is completed, the topsoil will be disked to provide a smooth and firm bed suitable for seeding. If seeding of the permanent species is not feasible due to climatic or biological conditions, temporary species will be broadcasted as in situ mulch in order to provide a quick vegetative cover.

Screening – Disposal – Additional Safety Measures

Fencing, berms, buffers or other barriers will be used to prevent access to the potentially hazardous slopes (e.g., high walls) of the mining areas and/or the excavated pits. Setbacks and lateral support will remain to provide stability and to prevent immediate access to the mine from adjacent areas. Signs will also be posted on the fences, providing adequate warning to the public. The perimeter of the affected area may be fenced and posted to keep out unauthorized personnel.

Sediment controls will be used during the mining and reclamation operations to reduce sedimentation until vegetation and/or BMPs are established. The Applicant proposes to spray water on the stockpiles and haul roads as necessary to control dust.

