

2013-2015 SNI Progress Report



**STRONG
NEIGHBORHOODS
INITIATIVE**

better communities together

Shannon Entz, Senior Planner

City of OKC

Planning Department

Housing & Community Development Division



collaboration



visioning



commitment



placemaking

STRONG NEIGHBORHOODS INITIATIVE AREAS

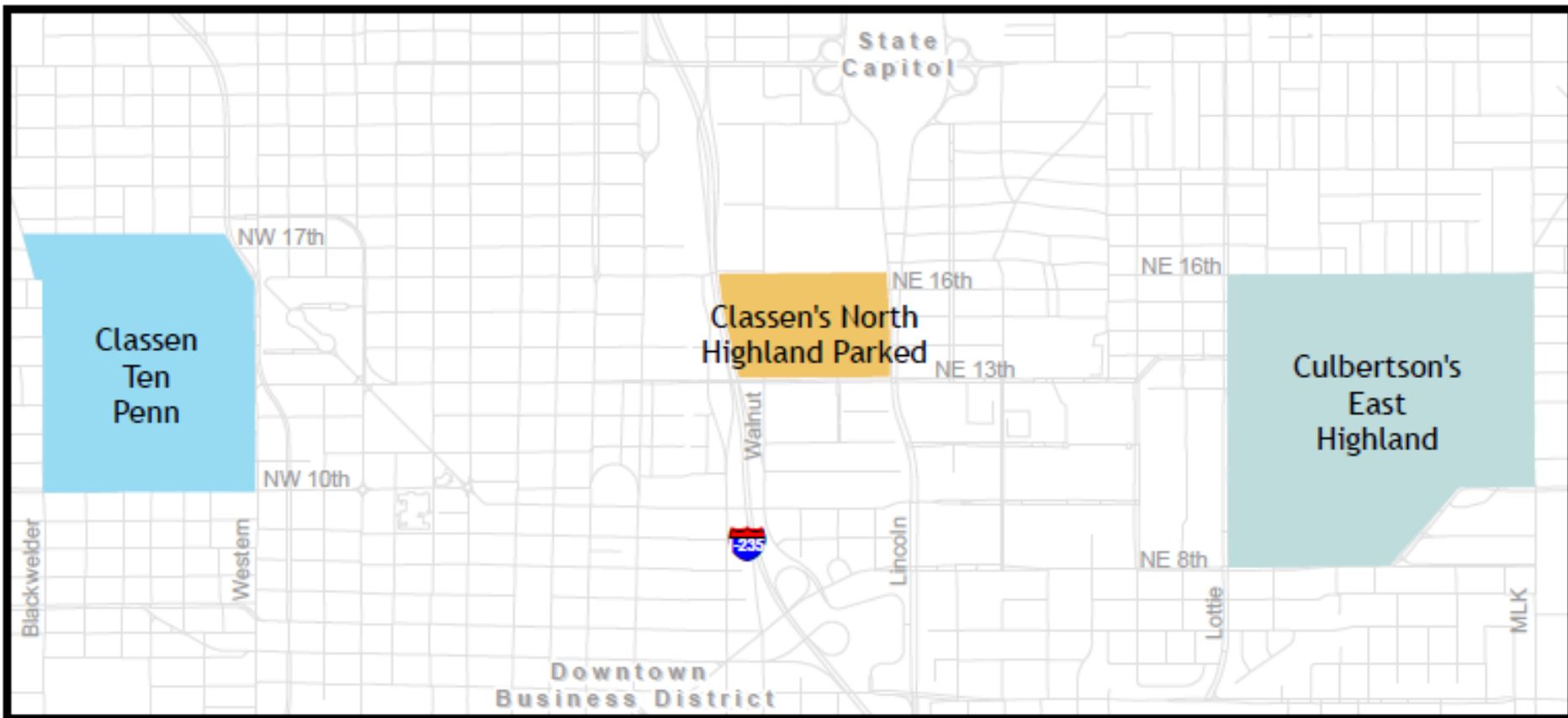

SNI TARGET AREA DATA

Classen Ten Penn/Gatewood

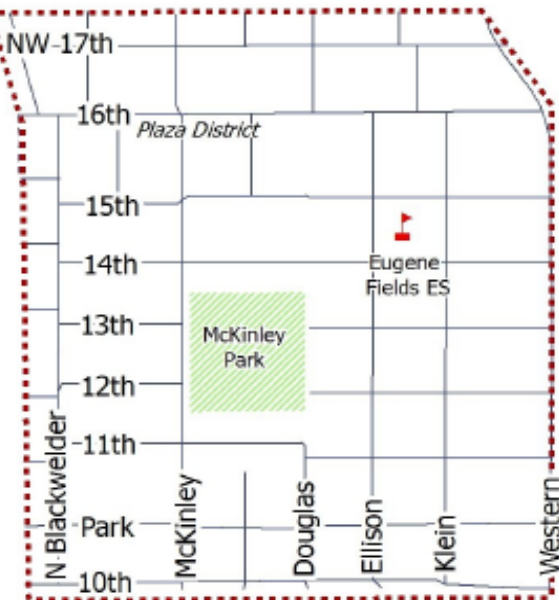

- McKinley Park
- Eugene Field Elem.
- Plaza District & Downtown
- 861 Residential Units
 - **34% Owner-Occupied**
 - 66% Non-Owner-Occ
- 103 Vacant Lots
- 176 Vacant Buildings
- Ave Res Value \$70,848

Classen's North Highland Parked

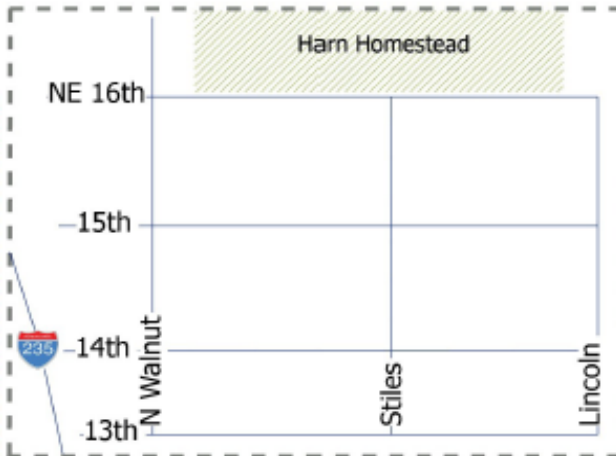

- Harn Homestead (& New Park!)
- Wilson Elem. Feeder Area
- Historic Properties
- OUHSC and State Capitol
- 149 Residential Units
 - **50% Owner-Occupied**
 - 50% Non-Owner Occ
- 58 Vacant Lots
- 36 Vacant Buildings
- Ave Res Value \$80,248

Culbertson's East Highland

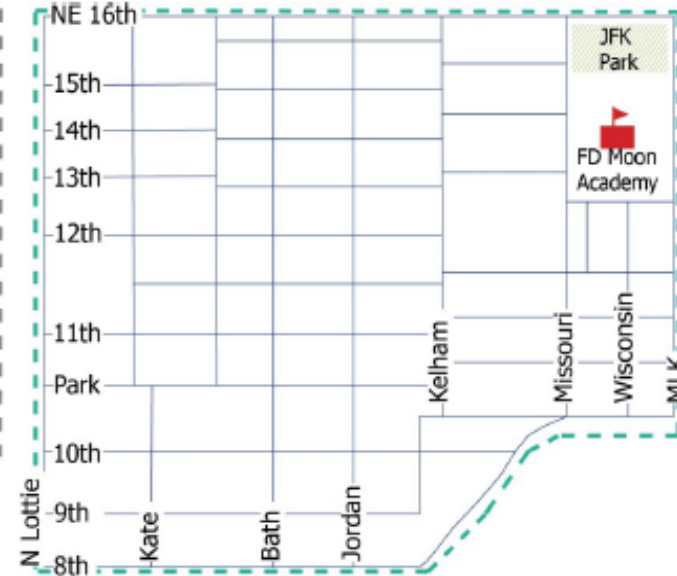

- JFK Park
- FD Moon Academy
- OUHSC & NE 23rd St Corridor
- 1113 Residential Units
 - **18% Owner-Occupied**
 - 82% Non-Owner-Occupied
- 354 Vacant Lots
 - 58% OCURA
 - 42% Private
- 209 Vacant Buildings
- 94 Public Housing Units
- Ave Res Value \$27,837



INTENDED OUTCOMES

- Improved quality of life - **From place to “A PLACE”**
- Engaged neighborhood groups, children and parents
- Decreased turnover in neighborhoods and schools
- Increased homeownership and private investment
- Improved property values & market stabilization
- Reduction of vacant properties
- Greater connectivity to jobs, education and services
- Decreased perception of crime





SNI GUIDANCE FROM OTHER ADOPTED PLANS

City Council Priorities

Support Thriving Neighborhoods

planOKC

Neighborhood Revitalization; Healthy Urban Forest; Urban Infill Housing;

Parks Master Plan

Develop new parks and partnerships

Foster a sense of community; Increase property values

Art Master Plan

Expand public art into neighborhoods

HUD 5-Year Consolidated Plan

Safe, fair and affordable housing, public services, removal of blight, ADA

2013-16 “Holistic” Approach to Revitalization

Physical, social and economic investments

- New Construction Infill Housing
- Owner-Occupied Housing Rehabilitation
- Homeownership Assistance & Education
- Sidewalks & Lighting
- Tree Planting & Hazardous Tree Removal
- Legal Assistance
- Fair Housing
- STEAM Afterschool & Summer Programs for SNI Elementary Schools
- Park Enhancements
- Public Art
- Business Facade Assistance
- Neighborhood Engagement through Education, Outreach, Events, Grants & Volunteer Opportunities (NACO)

Approx \$3.4M allocated to SNI

SNI'S "Holistic" Approach In Action

Physical, social and economic investments

New street trees lower utility bills, enhance walkability & beauty

Arborist teaching proper tree care & planting techniques

Local partners mentoring & leading by example



New, affordable, energy-efficient home for wheelchair-bound homeowner

Former vacant lot producing very small amount of property taxes

New sidewalks increase mobility & access

**Youth volunteers from high schools across OKC
= COMMUNITY ENGAGEMENT & PRIDE**





2013-15 SNI Projects Completed or Underway

- 24** New homes built
- 24** Homes rehabbed
- 158** Trees planted
- 34** Blocks of sidewalks
- 4** New EMBARK bus shelters
- 27** Neighborhood signs installed
- 1** New Park w/Public Art
- 28** Hazardous trees removed
- 400** STEAM students
- 100+** Neighborhood meetings

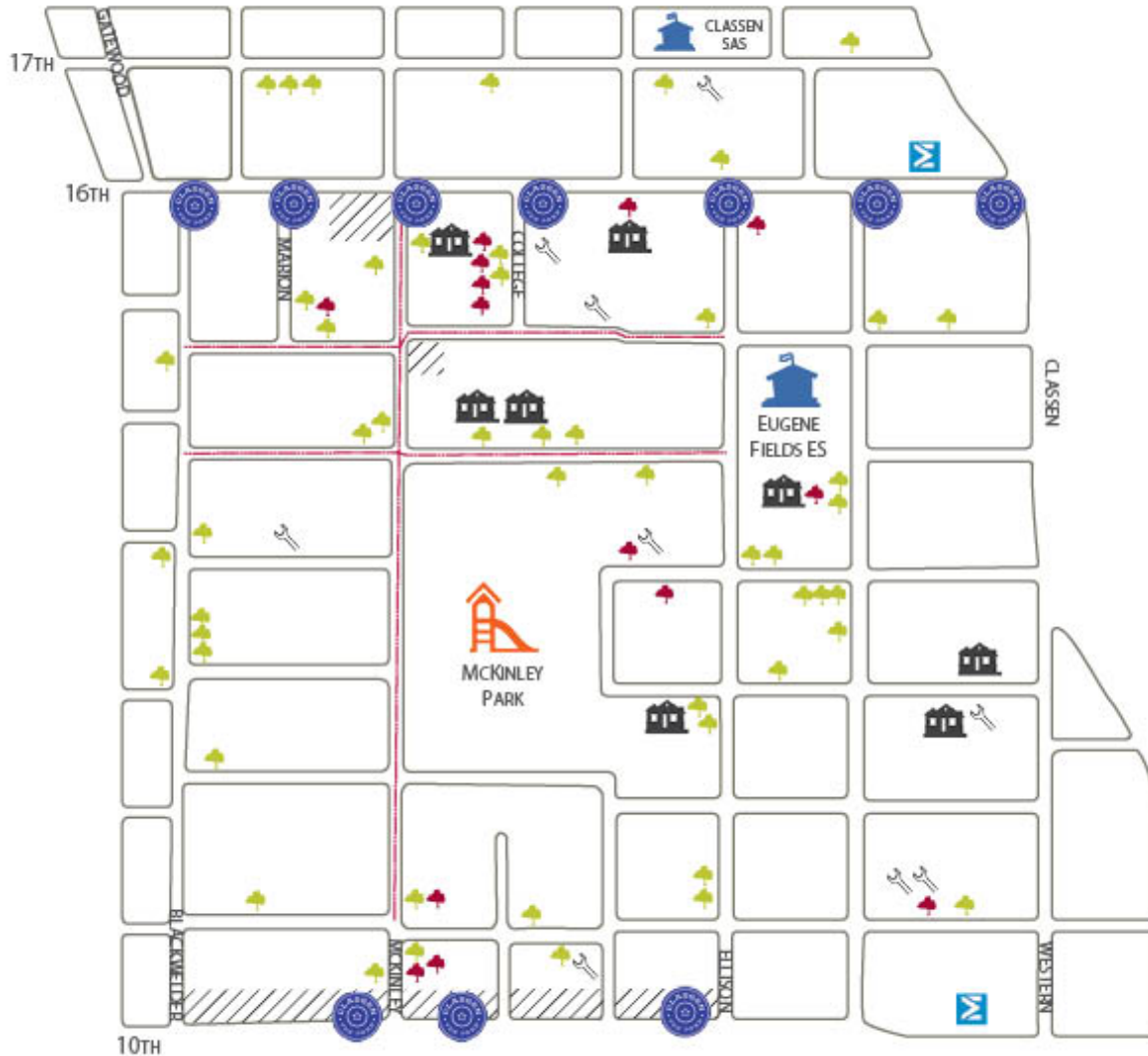







SNI PROJECTS IN CTP

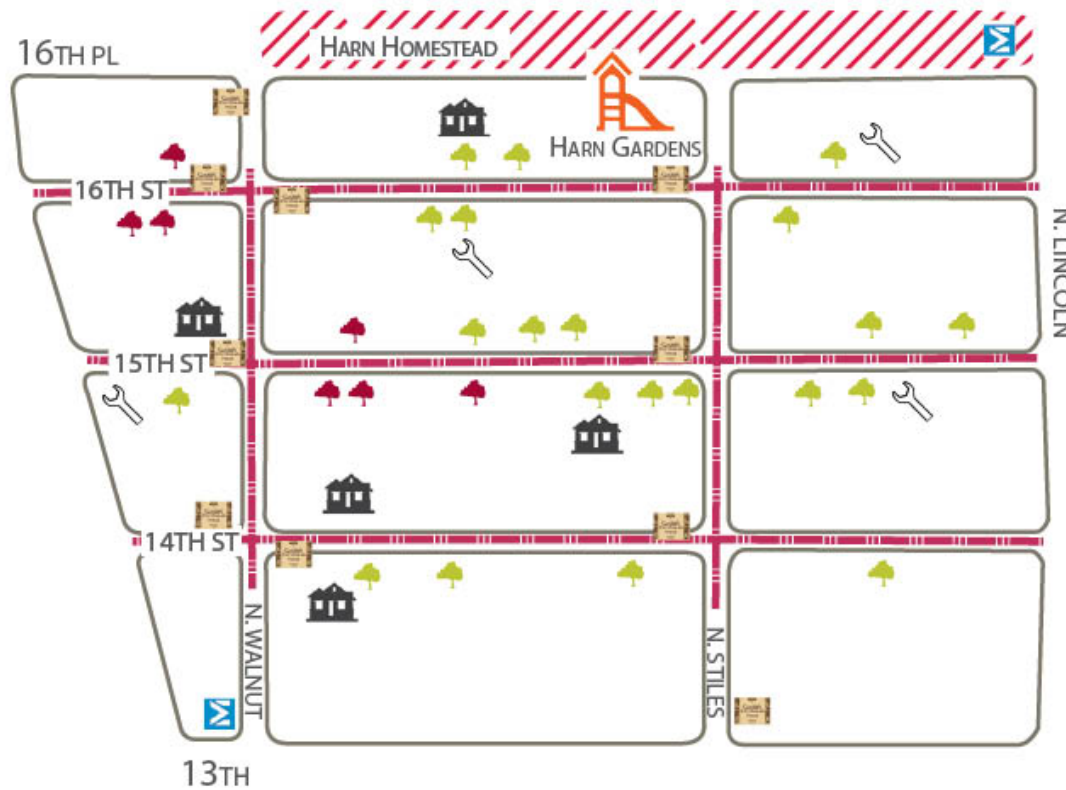

-  hazardous tree removal
-  tree planting
-  rehab or emergency repair
-  new construction
-  new sidewalks

SNI PROJECTS IN CNHP



-  hazardous tree removal
-  tree planting
-  rehab or emergency repair
-  new construction
-  new sidewalks

SNI PROJECTS IN CEH



-  hazardous tree removal
-  tree planting
-  rehab or emergency repair
-  new construction
-  neighborhood signs
-  new sidewalks



2013-15 SNI Progress Report

Private and Public Investment in SNI Neighborhoods

Source: City of OKC Permits and City of OKC Accounting

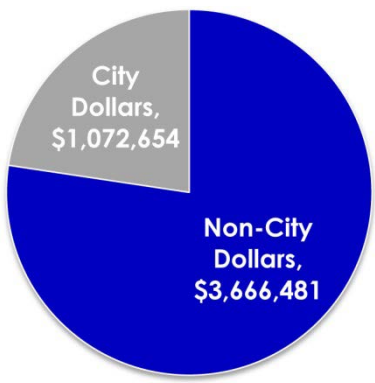
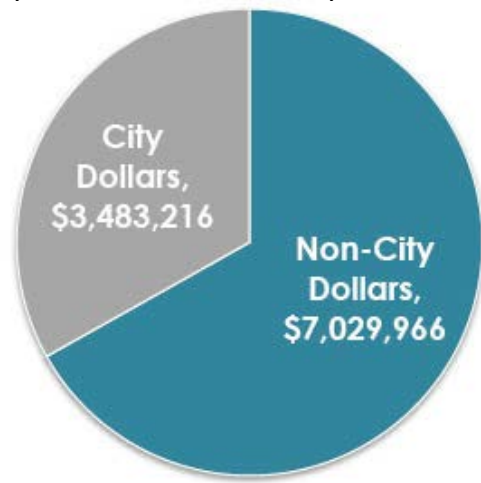

Classen Ten Penn



Classen's N Highland

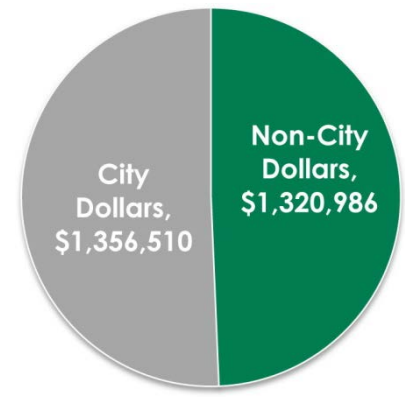

Culbertson's E Highland



2013-15 SNI Progress Report

Average Homes Sales Price

Source: OK County Tax Assessor

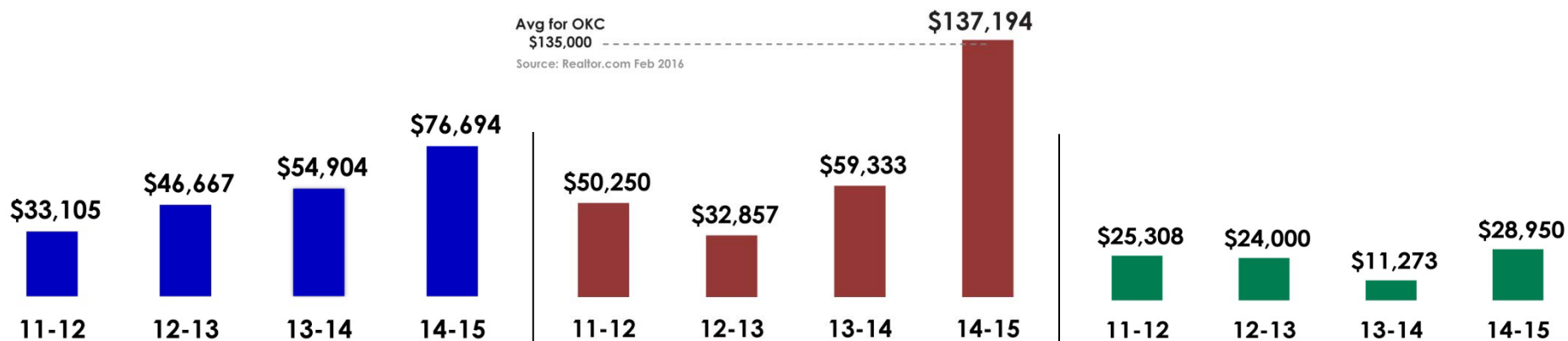



2013-15 SNI Progress Report

Number of Crime Incidents

Source: OKCPD

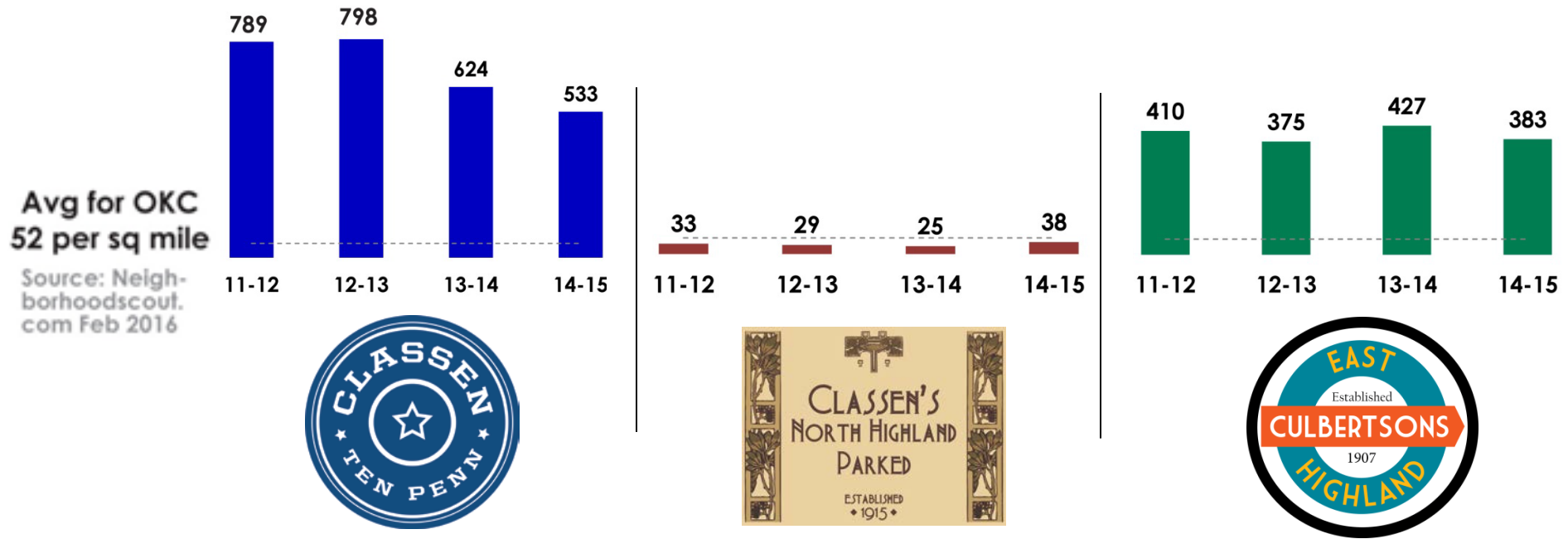

2013-15 SNI Progress Report

Assessment			SNI Intended Outcomes
CTP	CNHP	CEH	
2	4	2	1 Improved amenities & placemaking - parks, public spaces & street trees
2	2	1	2 Increased interaction & engagement with youth, seniors, families, schools & services
3	4	2	3 Neighborhood association has capacity to successfully hold meetings, host events, raise funds & apply for grants.
1.5	4	2	4 Increased opportunities for homeownership
3	3	2	5 Market stabilizing with increased private investment
3	4	2	6 Improved property values & price per square foot
2	2	2	7 Reduced number of vacant lots w/new construction completed or planned
2	4	2.5	8 Improved infrastructure to access jobs, education, parks & services
1	2	1	9 Decreased incidences and perception of crime
0	0	0	10 Improved business façades & commerical corridors
1	2	2	11 Improved environment - less graffiti, blight, junk cars & code violations
2	2	2	12 Homeowners are utilizing programs to make their homes more energy efficient, attractive, handicap-accessible & safe
4	0	2	13 Improved academic performance by STEAM students
2.5	3	2	14 Effective communications through traditional methods (phone calls, flyers, email) and social media
1	3	1	15 Increased awareness of local resources for individuals & families such as workforce training, human services, etc.
30	39	25.5	Assessment Score

Not assessed/introduced yet 0

 Area of Concern 1

 Progressing 2

 Meeting Expectations 3

 Exceeding Expectations 4

COMMUNITY COLLABORATION

Wm Freemont Harn Gardens – Opened June 4th in CNHP!



COMMUNITY COLLABORATION

STEAM at FD Moon Academy & Eugene Field Elementary



MATH

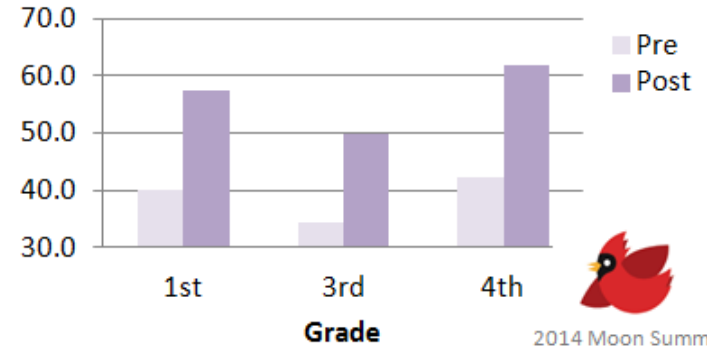

2014 Moon Summer STEAM Academy

READING

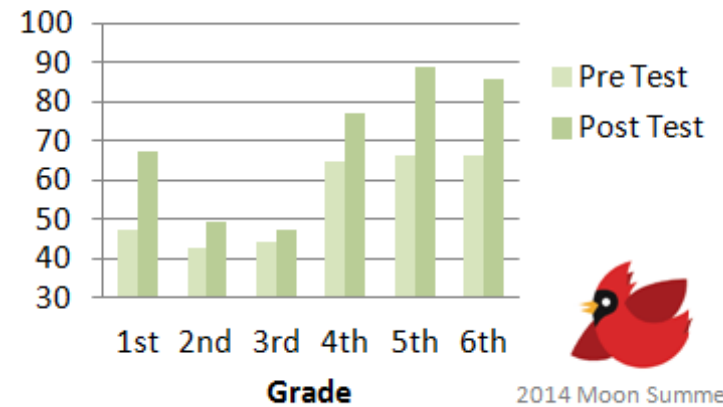

2014 Moon Summer STEAM Academy



Paige Bressman @plbressman · 4h
Building DNA at Eugene Field Summer Steam Academy. @OKCPS @DrNHenderson

4 7

COMMUNITY COLLABORATION

PositivelyPaseo



New infill homes in CTP & CNHP

10 homes built

7 homes planned through 2017



COMMUNITY COLLABORATION



OU College of Architecture

Conceptual design studio focused on project adjacent to McKinley Park

Gave students an opportunity to use a community engagement process to guide their design projects.

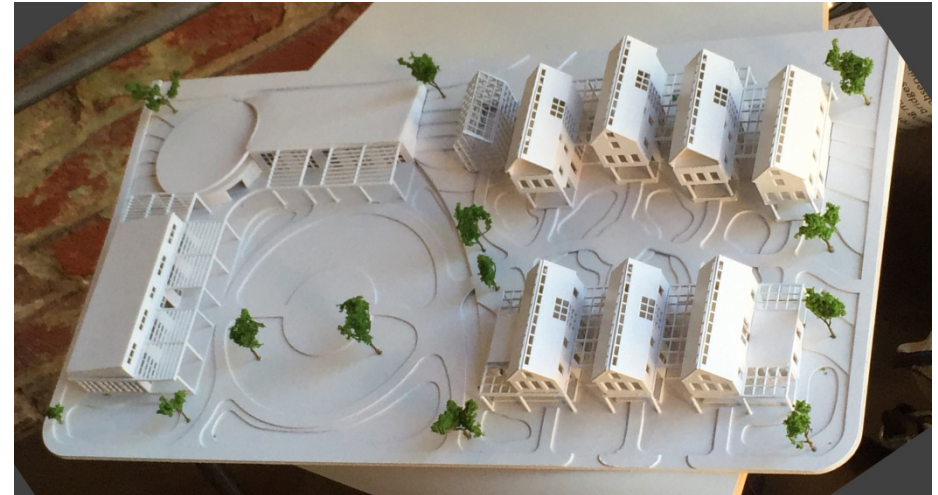

UPCOMING DEVELOPMENTS IN SNI NEIGHBORHOODS

1600 NW 16th St in CTP

Mixed-Use Development

17 apartments + Café

Est. value \$1.6 million



NW 10th Street in CTP (proposed)

(between Ellison and Blackwelder)

Mixed-Use, Multi-Phase Development

Approx. 70-80 residential units

Approx. 13,000 SF of retails

Est Value \$18 million



UPCOMING DEVELOPMENTS IN SNI NEIGHBORHOODS

30+ SF Homes in CEH

“Truman site” owned by the OKC Urban Renewal Authority.

Developers will be chosen through an RFP process by OCURA.

Required to follow design standards adopted by OCURA in 2015.

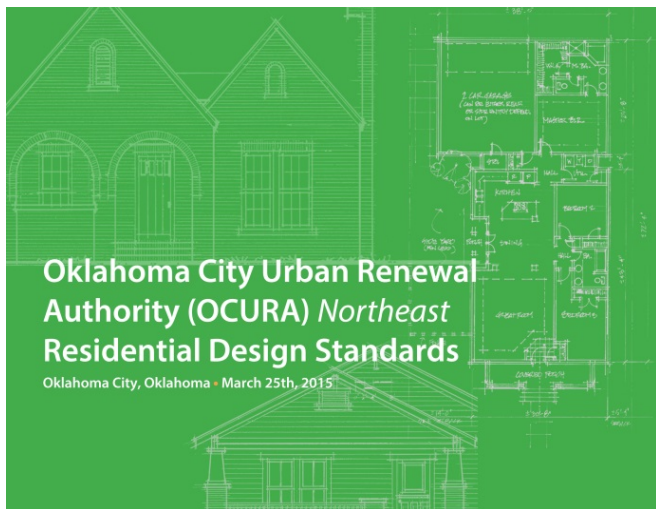

UPCOMING ART PROJECTS IN SNI NEIGHBORHOODS

F.D. Moon Murals in CEH

Organized & funded by Current Studio.
Multiple artists will create murals in the Cafetorium inspired by students work from an art class .



McKinley Park Mural in CTP

A mural committee organized a formal RFP process and narrowed the selection from 8 to 3. A neighborhood-wide vote took place at the CTP Community Festival on June 4th and "Plains Pioneers" by local artists Amanda Bradway and Tessa Raven Bayne was chosen.

Funded by SNI Neighborhood Grant



THANKS TO OUR SNI PARTNERS!!

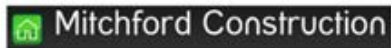

METROPOLITAN FAIR HOUSING COUNCIL OF OKLAHOMA, INC.

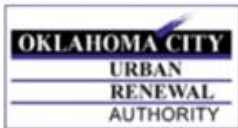

QUESTIONS?

THANK YOU

Shannon.Entz@okc.gov

Jennifer.Sylvester@okc.gov

okc.gov/sni

twitter.com/OKC_SNI

facebook.com/SNIOKC

Nextdoor.com